

StoPowerwall® ExtraSeal® Small Pipe Penetration

Detail No.: 65c.70
Date: January 2025
Page 1 of 3

Step 1

Use Urethane Spray Foam or Sto TurboStick to fill gaps. Allow foam to cure properly before trimming flush with face of masonry substrate.

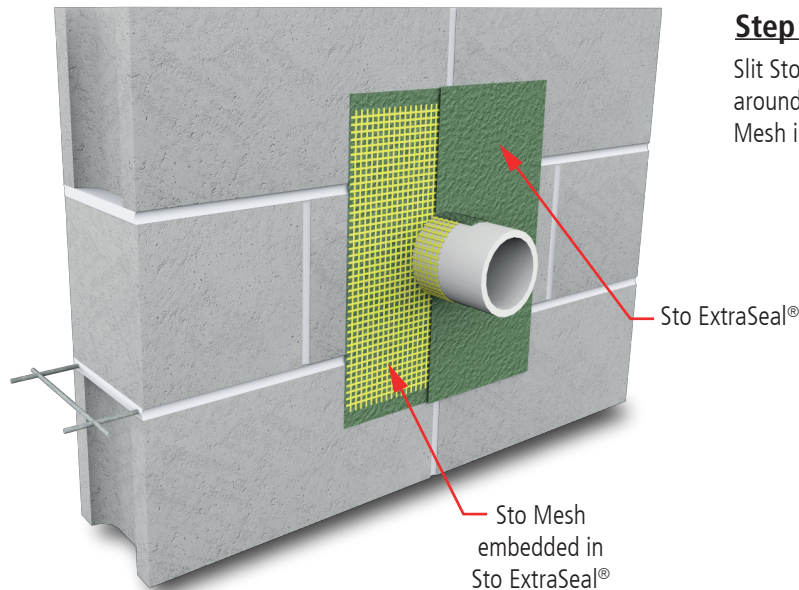
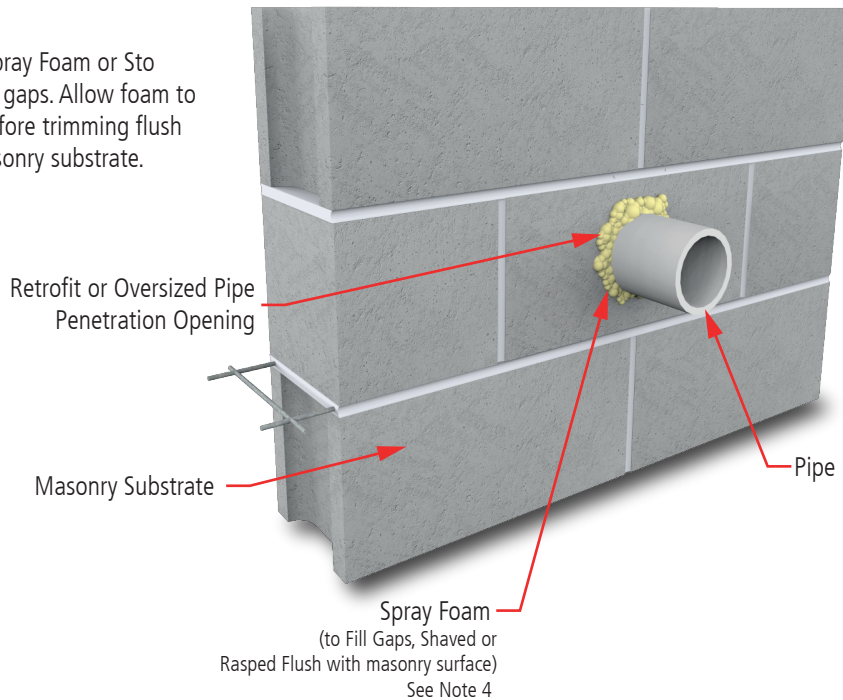

Step 2

Slit Sto Mesh in center to fit around pipe and embed Sto Mesh in Sto ExtraSeal.

Notes:

1. Refer to StoGuard Product Use Chart (Table 1.1) for StoGuard detail components; joint treatment, rough opening protection, backing for masonry anchors, or transitions to dissimilar materials, joints and seams in construction.
2. Refer to General Notes for specific information and design guidance on wall assembly components.
3. Stucco brown coat material in compliance with ASTM C926 and manufactured or listed by Sto Corp.
4. Consult Spray Foam manufacturer for maximum size of gap for product being used.
5. Sto Primer is required for Sto Specialty Finishes such as Sto GraniTex, StoSignature Brick, and others. Refer to specific Sto finish product bulletins.
6. Refer to applicable Sto guide specifications, product bulletins, Tech Hotlines, and other Sto guide details for additional information.
7. Components not identified as Sto are furnished by other manufacturers and are not necessarily installed by trades who install the Sto products. Refer to project specific contract documents.

ATTENTION

Property of Sto Corp. All Rights Reserved.

www.stocorp.com

Sto products are intended for use by qualified professional contractors, not consumers, as a component of a larger construction assembly as specified by a qualified design professional, general contractor or builder. They should be installed in accordance with those specifications and Sto's instructions. Sto Corp. disclaims all, and assumes no, liability for on-site inspections, for its products applied improperly, or by unqualified persons or entities, or as part of an improperly designed or constructed building, for the nonperformance of adjacent building components or assemblies, or for other construction activities beyond Sto's control. Improper use of Sto products or use as part of an improperly designed or constructed larger assembly or building may result in serious damage to Sto products, and to the structure of the building or its components.

STO CORP. DISCLAIMS ALL WARRANTIES EXPRESSED OR IMPLIED EXCEPT FOR EXPLICIT LIMITED WRITTEN WARRANTIES ISSUED TO AND ACCEPTED BY BUILDING OWNERS IN ACCORDANCE WITH STO'S WARRANTY PROGRAMS WHICH ARE SUBJECT TO CHANGE FROM TIME TO TIME. For the fullest, most current information on proper application, clean-up, mixing and other specifications and warranties, cautions and disclaimers, please refer to the Sto Corp. website, www.stocorp.com.



StoPowerwall® ExtraSeal® Small Pipe Penetration - Option 1

Detail No.: 65c.70
Date: January 2025
Page 2 of 3

Step 1

After applying Sto ExtraSeal® Scratch Coat and Sto Powerwall® Brown Coat around the pipe, install self-adhesive quarter round Backer Rod around the pipe against the Brown Coat and pipe, followed by sealant.

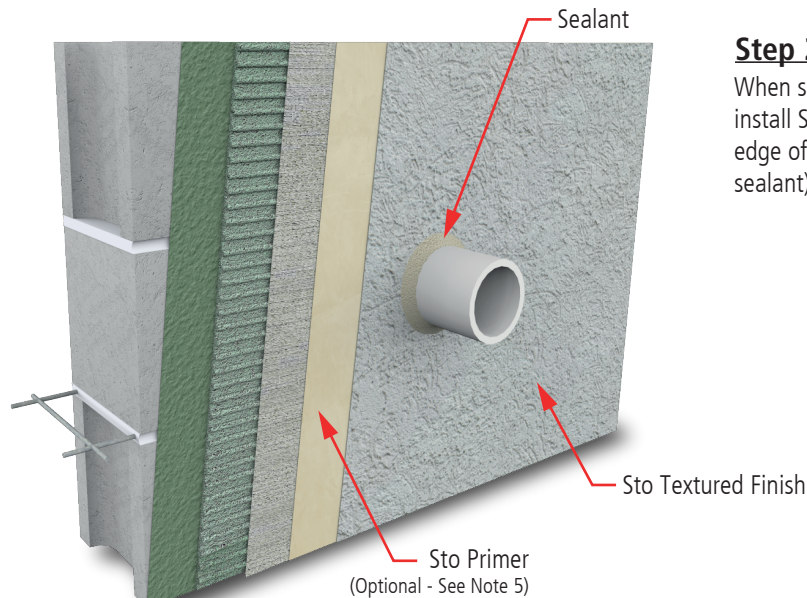
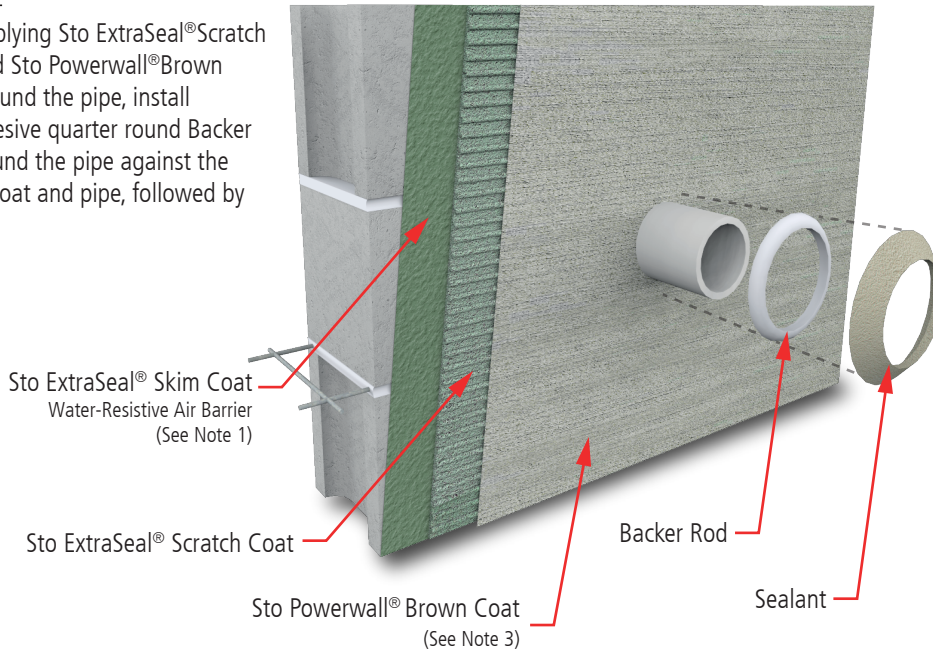

Step 2

When sealant is fully cured, install Sto Textured Finish up to edge of sealant (not over sealant).

Notes:

1. Refer to StoGuard Product Use Chart (Table 1.1) for StoGuard detail components; joint treatment, rough opening protection, backing for masonry anchors, or transitions to dissimilar materials, joints and seams in construction.
2. Refer to General Notes for specific information and design guidance on wall assembly components.
3. Stucco brown coat material in compliance with ASTM C926 and manufactured or listed by Sto Corp.
4. Consult Spray Foam manufacturer for maximum size of gap for product being used.
5. Sto Primer is required for Sto Specialty Finishes such as Sto GraniTex, StoSignature Brick, and others. Refer to specific Sto finish product bulletins.
6. Refer to applicable Sto guide specifications, product bulletins, Tech Hotlines, and other Sto guide details for additional information.
7. Components not identified as Sto are furnished by other manufacturers and are not necessarily installed by trades who install the Sto products. Refer to project specific contract documents.

ATTENTION

Property of Sto Corp. All Rights Reserved.

www.stocorp.com

Sto products are intended for use by qualified professional contractors, not consumers, as a component of a larger construction assembly as specified by a qualified design professional, general contractor or builder. They should be installed in accordance with those specifications and Sto's instructions. Sto Corp. disclaims all, and assumes no, liability for on-site inspections, for its products applied improperly, or by unqualified persons or entities, or as part of an improperly designed or constructed building, for the nonperformance of adjacent building components or assemblies, or for other construction activities beyond Sto's control. Improper use of Sto products or use as part of an improperly designed or constructed larger assembly or building may result in serious damage to Sto products, and to the structure of the building or its components.

STO CORP. DISCLAIMS ALL WARRANTIES EXPRESSED OR IMPLIED EXCEPT FOR EXPLICIT LIMITED WRITTEN WARRANTIES ISSUED TO AND ACCEPTED BY BUILDING OWNERS IN ACCORDANCE WITH STO'S WARRANTY PROGRAMS WHICH ARE SUBJECT TO CHANGE FROM TIME TO TIME. For the fullest, most current information on proper application, clean-up, mixing and other specifications and warranties, cautions and disclaimers, please refer to the Sto Corp. website, www.stocorp.com.



StoPowerwall® ExtraSeal® Small Pipe Penetration - Option 2 V-groove and Sealant

Detail No.: 65c.70
Date: January 2025
Page 3 of 3

Step 1

When installing Sto ExtraSeal® Scratch Coat and Sto Powerwall® Brown Coat, form a nominal 3/8" (10mm) space around pipe. Then install Sto Textured Finish up to (not into) the open space around the pipe.

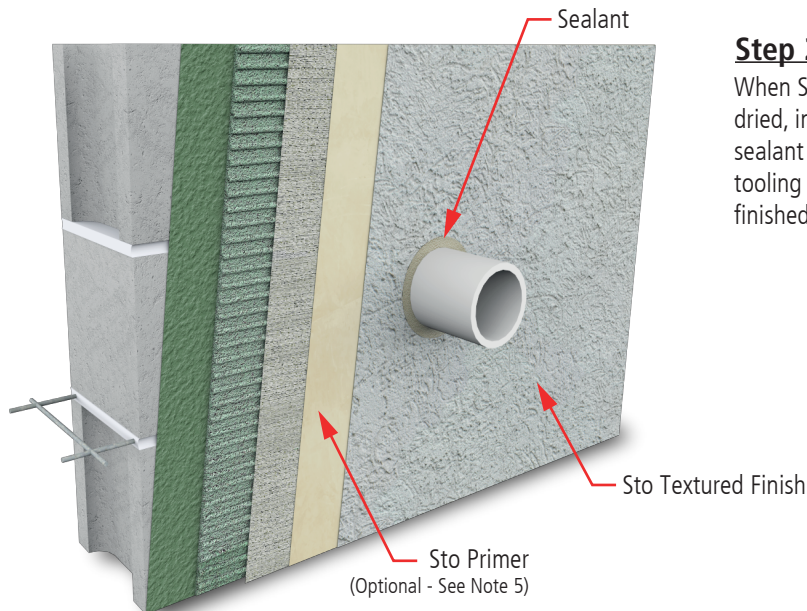
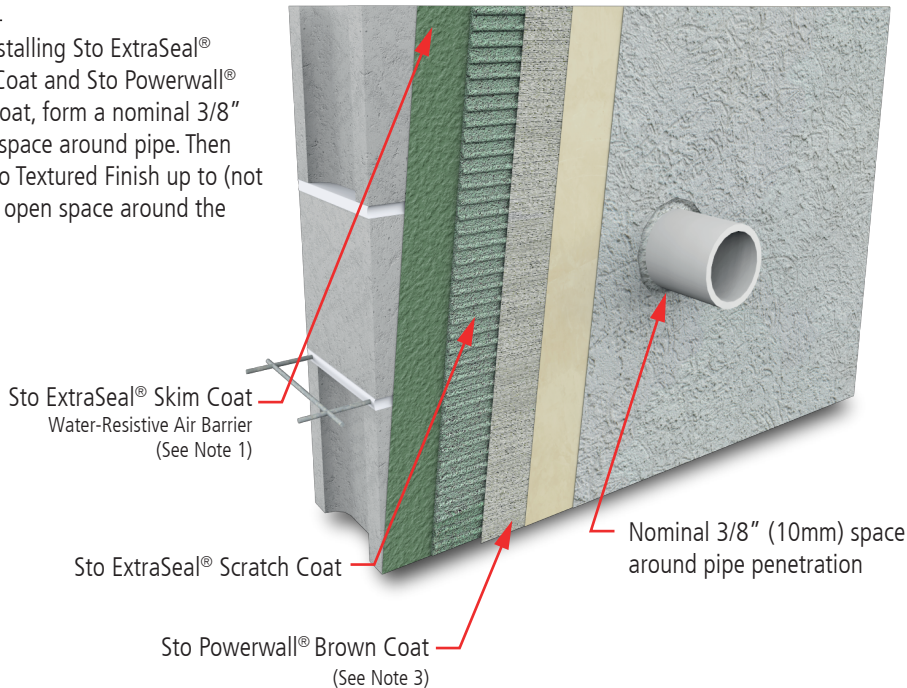

Step 2

When Sto Textured Finish has dried, install backer rod and sealant around the pipe, tooling it flush with the finished wall surface.

Notes:

1. Refer to StoGuard Product Use Chart (Table 1.1) for StoGuard detail components; joint treatment, rough opening protection, backing for masonry anchors, or transitions to dissimilar materials, joints and seams in construction.
2. Refer to General Notes for specific information and design guidance on wall assembly components.
3. Stucco brown coat material in compliance with ASTM C926 and manufactured or listed by Sto Corp.
4. Consult Spray Foam manufacturer for maximum size of gap for product being used.
5. Sto Primer is required for Sto Specialty Finishes such as Sto GraniTex, StoSignature Brick, and others. Refer to specific Sto finish product bulletins.
6. Refer to applicable Sto guide specifications, product bulletins, Tech Hotlines, and other Sto guide details for additional information.
7. Components not identified as Sto are furnished by other manufacturers and are not necessarily installed by trades who install the Sto products. Refer to project specific contract documents.

ATTENTION

Property of Sto Corp. All Rights Reserved.

www.stocorp.com

Sto products are intended for use by qualified professional contractors, not consumers, as a component of a larger construction assembly as specified by a qualified design professional, general contractor or builder. They should be installed in accordance with those specifications and Sto's instructions. Sto Corp. disclaims all, and assumes no, liability for on-site inspections, for its products applied improperly, or by unqualified persons or entities, or as part of an improperly designed or constructed building, for the nonperformance of adjacent building components or assemblies, or for other construction activities beyond Sto's control. Improper use of Sto products or use as part of an improperly designed or constructed larger assembly or building may result in serious damage to Sto products, and to the structure of the building or its components.

STO CORP. DISCLAIMS ALL WARRANTIES EXPRESSED OR IMPLIED EXCEPT FOR EXPLICIT LIMITED WRITTEN WARRANTIES ISSUED TO AND ACCEPTED BY BUILDING OWNERS IN ACCORDANCE WITH STO'S WARRANTY PROGRAMS WHICH ARE SUBJECT TO CHANGE FROM TIME TO TIME. For the fullest, most current information on proper application, clean-up, mixing and other specifications and warranties, cautions and disclaimers, please refer to the Sto Corp. website, www.stocorp.com.

