

Sto Coatings For Insulated Concrete Forms (ICF) Residential Window Sill

Detail No.: 17.23

Date: November 2007

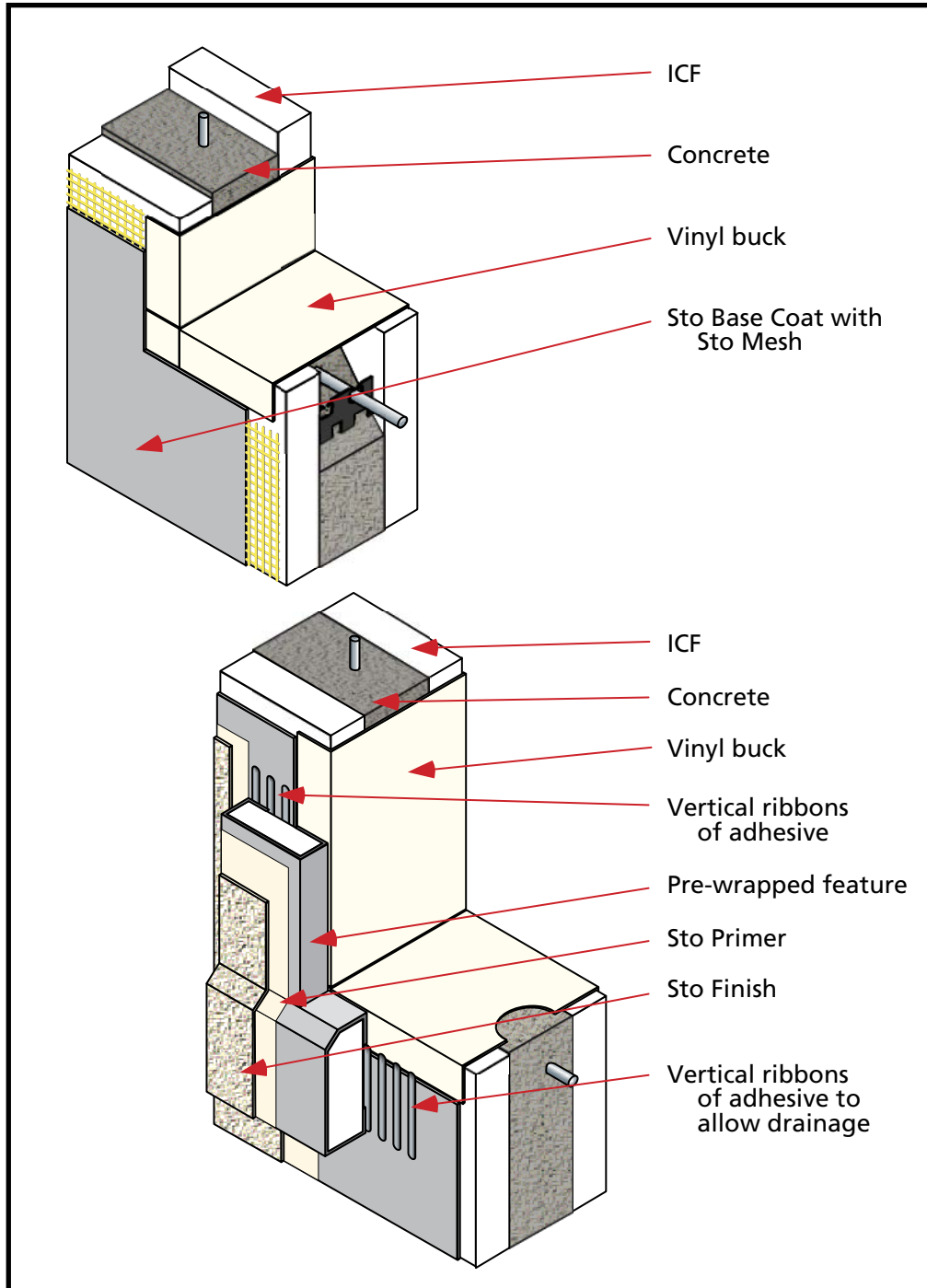

Notes:

1. Detail illustrates preparation of Sto coatings around a window opening framed with a vinyl buck.
2. Detail does not illustrate the installation of the window, flashing or other opening protection required by code.
3. Install Sto Base Coat and Mesh over the ICF up to the vinyl buck flange.
4. If the selected window has a nailing flange, install the window and appropriate flashing ahead of the feature trim around the window.
5. Install the pre-wrapped feature around the window using vertical ribbons of adhesive. Allow drainage below the sill feature.
6. Non-flanged windows and flashing may be installed after the feature trim is installed.
7. Limit dimension of vinyl buck to no more than 20% of feature width.

ATTENTION

Sto products are intended for use by qualified professional contractors, not consumers, as a component of a larger construction assembly as specified by a qualified design professional, general contractor or builder. They should be installed in accordance with those specifications and Sto's instructions. Sto Corp. disclaims all, and assumes no, liability for on-site inspections, for its products applied improperly, or by unqualified persons or entities, or as part of an improperly designed or constructed building, for the nonperformance of adjacent building components or assemblies, or for other construction activities beyond Sto's control. Improper use of Sto products or use as part of an improperly designed or constructed larger assembly or building may result in serious damage to Sto products, and to the structure of the building or its components. **STO CORP. DISCLAIMS ALL WARRANTIES EXPRESSED OR IMPLIED EXCEPT FOR EXPLICIT LIMITED WRITTEN WARRANTIES ISSUED TO AND ACCEPTED BY BUILDING OWNERS IN ACCORDANCE WITH STO'S WARRANTY PROGRAMS WHICH ARE SUBJECT TO CHANGE FROM TIME TO TIME.** For the fullest, most current information on proper application, clean-up, mixing and other specifications and warranties, cautions and disclaimers, please refer to the Sto Corp. website, www.stocorp.com.

www.stocorp.com