



Building with conscience.

StoCast Brick over StoTherm[®] ci

Installation Guide
Series 58s.SCB | December 2025

Facades



Interiors



StoCast Brick are thin, lightweight, resin cast bricks with a diverse range of colors, textures, and sizes. They deliver an authentic brick appearance, are flexible and easy to install.

Designed for Sto engineered wall cladding systems, they provide a durable, decorative and protective facade finish.



Installation Guide



Table of Contents

Product Description, Brick Sizes, Shapes & Coverage	3
Components and Recommended Tools	4
Assembly Diagram	5
Installation	6
Product Use and Limitations	8
Additional Information	9
Guide Details	10



ATTENTION

The final design of any project is the sole responsibility of the Design Professional, with considerations for compliance with local building and design codes and requirements. Sto Corp. accepts no liability for design, engineering, or workmanship of any project. The information provided herein is in addition to other technical data provided by Sto Corp. (System Bulletin, Specification, Guide Details, etc). For more information, please visit www.stocorp.com

Sto Corp.
3800 Camp Creek Pkwy. SW
Bldg. 1400 • Suite 120
Atlanta, GA 30331
Tel: (800) 221-2397
Fax: (404) 346-3119
<http://www.stocorp.com>
helpdesk.stocorp.com



StoCast Brick

StoCast Brick are resin cast bricks that offer remarkable design flexibility while achieving an authentic brick aesthetic. Lightweight, flexible, easy to apply and durable, they also offer a lower embodied and operational carbon footprint than traditional bricks or thin bricks. Standard brick styles or custom matches are available for use in interior and exterior walls, ceiling and soffit applications.

Using StoCast Brick with StoTherm®ci enables designers to achieve continuous insulation in a highly energy efficient building enclosure system with the appearance of a traditional brick facade.

Table 1.0 - StoCast Brick - Standard Sizes and Shapes¹

Brick Type	Flat		Corner			Lintel		
	Height	Length	Depth	Height	Length	Depth	Height	Length
Modular	2 - 1/4"	7 - 5/8"	3 - 5/8"	2 - 1/4"	7 - 5/8"	2 - 1/4"	4 - 1/4"	7 - 5/8"
King	2 - 5/8"	9 - 5/8"	2 - 3/4"	2 - 5/8"	9 - 5/8"	2 - 5/8"	5"	9 - 5/8"
Queen	2 - 3/4"	7 - 5/8"	2 - 3/4"	2 - 3/4"	7 - 5/8"	2 - 3/4"	5 - 1/4"	7 - 5/8"
Utility	3 - 5/8"	11 - 5/8"	3 - 5/8"	3 - 5/8"	11 - 5/8"	2 - 3/4"	7"	11 - 5/8"
Estate	3 - 5/8"	9 - 5/8"	2 - 3/4"	3 - 5/8"	9 - 5/8"	3 - 5/8"	7"	9 - 5/8"
Premier Plus	3 - 1/8"	10 - 1/8"	3 - 1/2"	3 - 1/8"	10 - 1/8"	3 - 1/8"	6"	10 - 1/8"
Metric Norman	2 - 1/4"	11 - 1/2"	3 - 1/2"	2 - 1/4"	11 - 1/2"	2 - 1/4"	4 - 1/4"	11 - 1/2"

¹ Custom sizes available. Typical brick unit thickness 4-6mm.

Table 1.1 - StoCast Brick - Coverage³

Product No. 81806	Flats: 30 sq.ft. per box (2.8 sq.m.)	Corners: 15 LF per box (4.6 LM)	Lintels: 15 LF per box (4.6 LM)
--------------------------	---	--	--

² Based on 3/8" joint size

Figure 1.2 - StoCast Brick Units

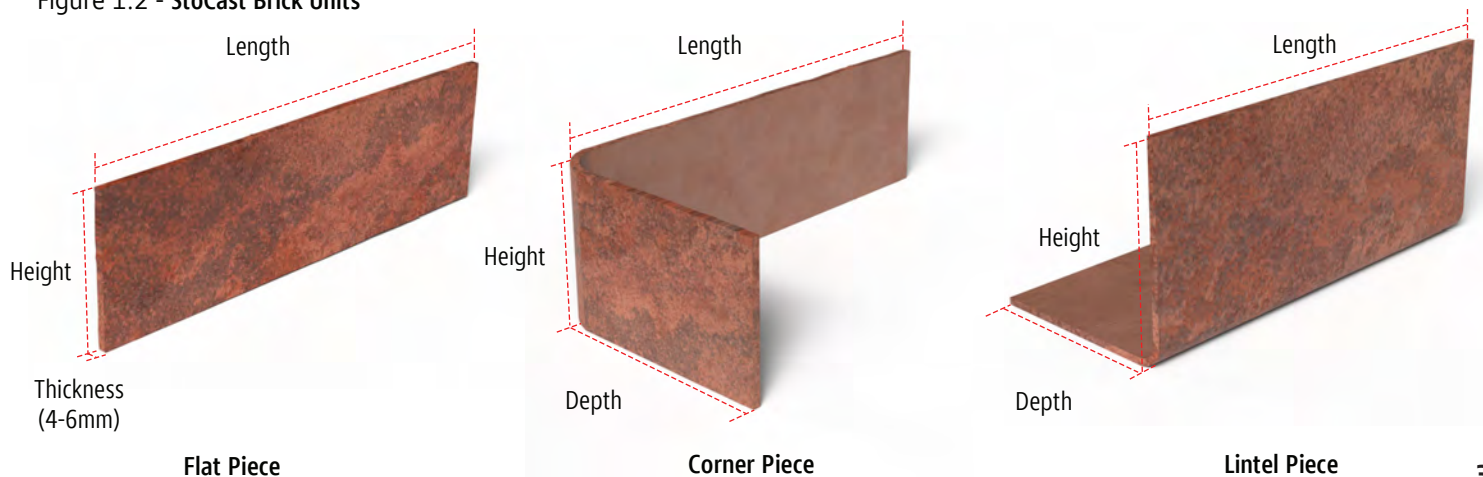



Adhesive and Grout



Sto Bonding & Pointing Mortar - A 100% organic mortar that greatly reduces the risk of efflorescence. Used to adhere StoCast Brick and grout the joints in Sto proprietary wall systems.

Coatings



StoColor® Acryl Plus - An acrylic-based, high performance decorative, and protective wall coating that protects against weather, salts and environmental pollutants and can be used on StoCast Brick. Available in Eggshell and Flat.

Accessories



StoSeal™ STPE - A high-movement, low modulus, non-sag one-component silyl-terminated polyether joint sealant in compliance with ASTM C920.



StoCast Brick Compound - Liquid form of StoCast Brick, tinted to the desired color, it is brush- applied to fill in irregular areas, corners, and repair or touch up bricks.

Recommended Tools



1. Tape measure



2. Chalk box string line



3. Plumb line



4. Square Notched Stainless Steel Trowel (1/4" x 3/8" x 1/4")



5. Utility knife or Razor Pliers



6. Pointing Masonry Brush

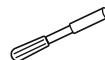

7. Modified Pointing Tool



8. Pointing and Tucking Trowel



9. Sponge



10. Masonry Hand Brush



Sto Bonding & Pointing Mortar

A 100% organic mortar that greatly reduces the risk of efflorescence. Used to adhere StoCast Bricks and fill the joints.

Substrate Preparation

Sto Base coat and mesh substrate must be clean, dry, and free of frost, dust, dirt, or any other bond-inhibiting material.

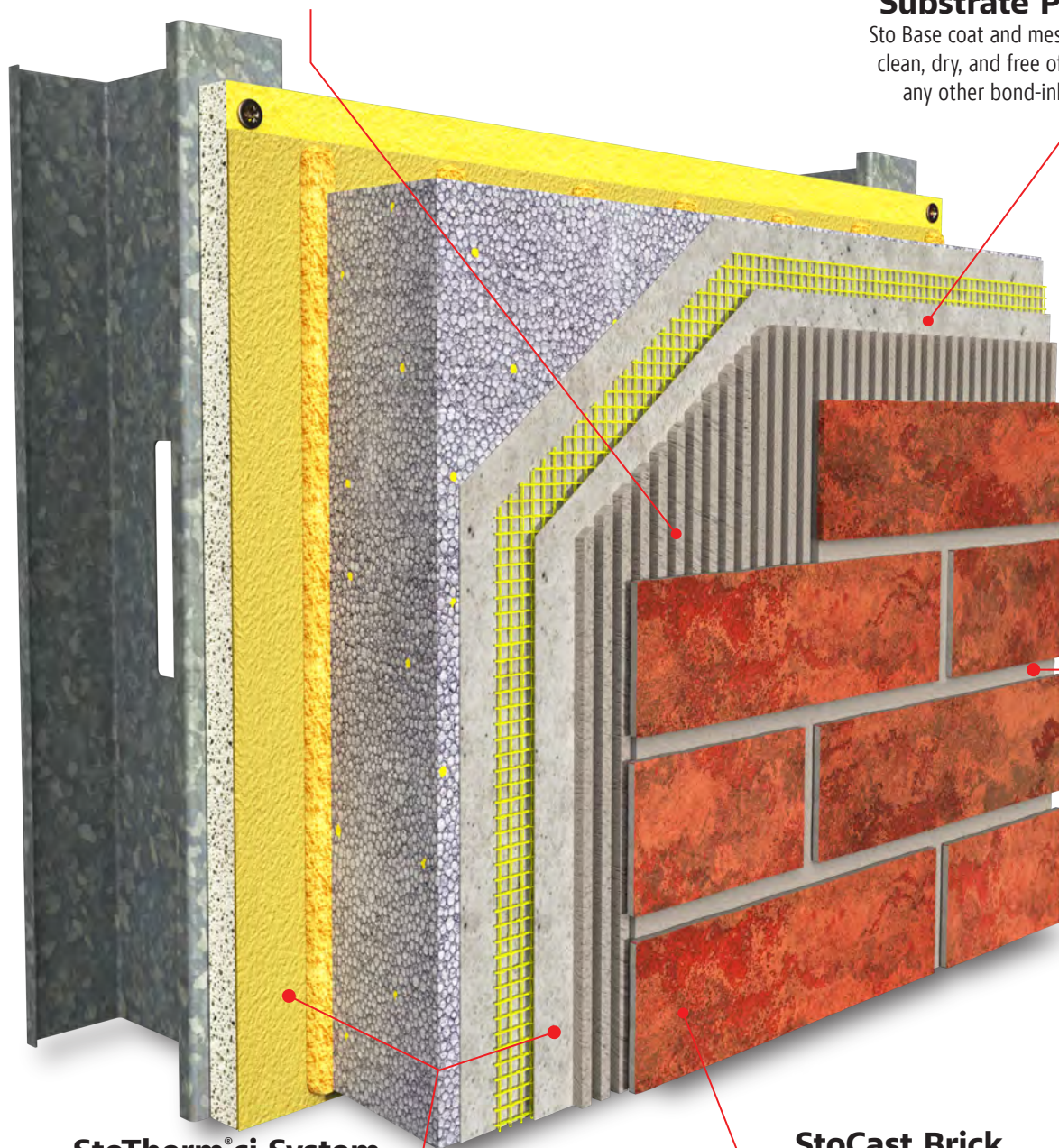

StoTherm® ci System

StoCast Brick is approved for all StoTherm® ci systems including; StoTherm® ci GPS (shown), StoTherm® ci XPS, StoTherm® ci Mineral, StoLite®, and select StoPanel® and Sto HVHZ Systems
Shown: StoGuard® Air and Water-Resistive Barrier, Sto TurboStick® Adhesive, Sto GPS Board, Sto Base Coat and Sto Mesh.

StoCast Brick

A flexible, lightweight, sustainable and durable facade aesthetic that provides the beautiful look of authentic brick.

Typical Joint Width
3/8" (10mm)
Maximum Joint Width
3/4" (19mm)

Drying Time



24 Hours

Normal Conditions
70°F (21°C) 50% RH

Minimum Radius



4 3/4"
(120 mm)

Application Temperature Range



+50°F
(10°C)
Minimum



+100°F
(38°C)
Maximum



Installation Steps



Step 1

Before installation begins, be sure all surfaces are structurally sound, clean, dry, and free of frost and surface contamination such as dust, dirt, salts, grease, oils, efflorescence, mold, algae, mildew, and any other contamination that may affect adhesion. Use appropriate repair methods for the substrate to repair pitting, spalls, cracks, peeling, blistering, delamination, weak surface conditions such as laitance, water damage, or other defects that may exist.

Plan the layout carefully, taking into account brick pattern, openings such as windows and doors, and alignment of horizontal mortar joints around the building walls. Use chalk lines or other marking method to establish layout lines for the brick pattern.



Step 2

StoCast Brick units should be installed from top to bottom, starting from a corner, in accordance with the planned layout and work from one end to the other, downward, in sequential rows.

Starting from the top corner, apply Sto Bonding & Pointing Mortar using a 1/4" x 3/8" x 1/4" (6mm x 10mm x 6mm) square notched stainless steel trowel, combing the mortar vertically (or perpendicular to the long dimension of the brick).

Only apply Sto Bonding & Pointing Mortar to small areas which will be covered immediately with StoCast Bricks, preventing a "skin" from forming on the mortar. If the mortar skins, cracks, or cakes, remove it and apply fresh material before proceeding.



Step 3

Select StoCast Brick from different cartons so brick shades are intermingled as they are installed. Use razor pliers, or score and snap using a utility knife to cut bricks to size as needed. Press and gently slide the StoCast Brick units into the freshly applied mortar while applying pressure to fully embed the units in the mortar and to ensure no gaps or cavities exist in the mortar.

Align the StoCast Brick units by eye or use spacers to maintain the desired joint size while progressing down the wall.

For curved surfaces, bricks must be warm to bend them. If necessary, heat bricks and bend to desired curvature. Then install bricks in the mortar. Note: Minimum radius for curved surfaces is 4-3/4" (120mm).



Installation Steps (continued)



Step 4

As soon as the StoCast Brick units are held in place with the mortar, work the joint areas with a small paint brush or modified pointing tool to compact and smooth the mortar and to create a joint profile that covers the edges (bed joints) and ends of the units (butt joints). If necessary use a damp sponge to remove adhesive from the face of the units. It is easier to remove the adhesive while it is wet than dry.

After mortar is completely dry, touch-up mortar joints if needed to seal edges or to sharpen aesthetics. Clean tools and equipment with water immediately after use.



Step 5

Once Sto Bonding & Pointing Mortar has dried, gently clean the surface of the units using a suitable masonry hand brush if necessary. Carefully remove any surface-dry adhesive remnants on the surface using a utility knife or a leftover piece of StoCast Brick.

Option: If thicker joints are desired, allow Sto Bonding & Pointing Mortar to dry a minimum of 24 hours under normal conditions (allow for 7 days if cold or wet weather persists). Then, point joints with additional mortar and tool the joints with a pointing tool to compact the mortar to a concave profile. Clean with damp sponge, touch up as needed, and clean with a suitable masonry hand brush when the additional mortar has dried. Remove dry remnants if needed with a utility knife.

Installation for Interiors

1. For installation over new interior gypsum wallboard: finish wallboard to a minimum Level 4 finish (wallboard is taped, spotted, and sanded). Remove dust or any other surface contamination, prime with StoPrime® Sand and allow to dry before installing StoCast Brick.
2. For installation over painted interior gypsum wallboard: lightly sand the surface (if paint is glossy, sand to remove gloss), remove dust or any other surface contamination, patch and repair any surface defects, then prime with StoPrime® Sand, verify adhesion, and allow to dry before installing StoCast Brick.
3. For more information, refer to **Sto Guide Specification 1002 - StoQuik® Finish with StoCast Brick for Interior Gypsum Wallboard** located at www.stocorp.com.



Product Use and Limitations

1. Use only when surface and ambient temperatures are above 50 to 100° F (10-38° C) during application and drying period.
2. Do not apply over damp surfaces or during rain, hail, or snow events, or, if rain, hail or snow is imminent.
3. Coverage of StoCast Brick is based on typical 3/8"(10mm) joint size.
4. Sto Bonding & Pointing Mortar dries within 24 hours under normal drying conditions (minimum 70°F [21°C], 50% RH).
5. Maximum joint width: 3/4"(19mm). May require two applications to fill the joint.
6. Full joints require a second application of Sto Bonding & Pointing Mortar after minimum 24 hours drying of first application under normal (minimum 70°F [21°C], 50% RH) conditions. Allow for 7 days drying if cold or wet weather persists.
7. Minimum radius: 4-3/4"(120mm).
8. Select StoCast Brick from different cartons so brick shades are intermingled as they are installed. We also strongly recommend ordering additional material to account for potential waste and need for repairs and touch ups.
9. When considering custom color bricks and mortars, the minimum permissible light reflectance value (LRV) will depend on the substrate, the system, and the product. For StoTherm®ci systems, select colors with Light Reflectance Value (LRV) greater than or equal to 20. (Does not apply to StoTherm®ci Mineral).
10. Construct a mock-up under actual conditions of use to verify proper surface preparation, coverage, and aesthetics, using materials and sub-trades associated with the project to verify installation, sequencing and detailing and for approval by the appropriate authority.
11. Do not use below grade or on surfaces subject to in-service water immersion.
12. Do not use on roofs or roof-like surfaces.
13. Do not use on horizontal or below grade surfaces, projecting ledges, or where immersion in water may occur.
14. Sloped Surfaces: provide minimum 15 degrees slope and coat the sloped base coat surface and the immediate area above, below and to the sides of the sloped surface with Sto Gold Coat. Use corner or lintel pieces on sloped surfaces and limit width to 4 inches (102mm) maximum. If width is 1 inch (25mm) or less, the slope may be less than 15 degrees but must be sloped away from the wall to direct rainwater to the exterior. Refer to Sto Details.
15. Not recommended for use on walls requiring high scrub resistance or repeated exposure to chemical cleaners such as shower stalls, food preparation areas, hospital operating rooms.
16. Cut to Fit Details: certain details such as inside corners, edges and underside of build-outs, or 3-dimensional outside corners will require StoCast Brick pieces "cut to fit." Pre-measure carefully and use a razor snip for precise cuts and a snug fit with adjoining brick surfaces. Embed the pieces in Sto Bonding & Pointing Mortar. Touch up/fill borders with color-matched StoCast Brick Compound and remove excess compound with a damp sponge for a clean, sharp appearance. Refer to Sto Details.
17. Refer to product bulletins and specifications for complete information on Sto products. Refer to StoTherm®ci Design Guide and Detail Booklets: Series 52s.xx (EPS), 53s.xx (XPS), 56s.xx (Mineral Wool), 58s.xx (GPS), 50s.xx (StoLite) for complete information on design and detailing with StoTherm®ci systems.



Additional Information

Sto is committed to helping you design beautiful architecture that is aspirational, inspirational, and attainable. Sto professional staff can assist you early in the design process, providing a variety of options for achieving your desired aesthetic in order to help bring your vision to the final project.

Refer to StoCast Brick Style Guide, StoCast Brick Repair and Maintenance Guide, StoBrick Color Collection, Sto Bonding & Pointing Mortar Color Chart, product bulletins, guide specifications and other sources of information available online at www.stocorp.com.

StoCast Brick Style Guide



StoCast Brick Repair & Maintenance Guide



StoCast Brick Standard Color Collection

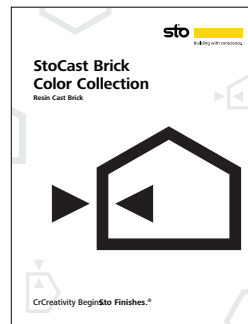

Sto Bonding & Pointing Mortar Color Chart

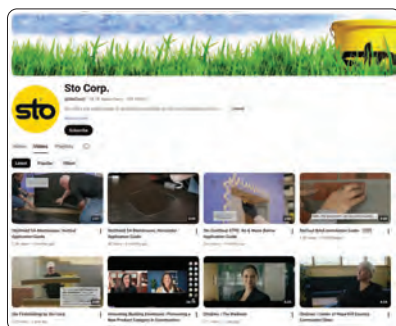
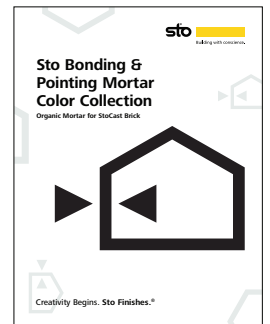

StoCast Brick Installation Video

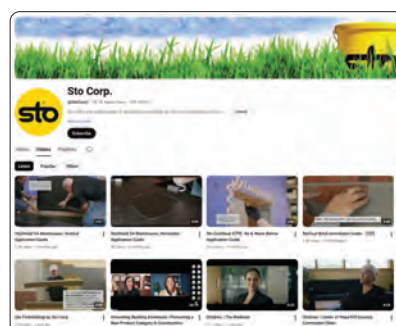

StoCast Brick Durability Video





Guide Details

Brick Sill with Transition to Textured Finish	58s.01 SCB
Brick Outside and Inside Corner	58s.10 SCB
Brick Outside Corner with Quoins	58s.12 SCB
Window Opening with Brick Sill and Header	58s.23 SCB
Termination at Floor Line with Concealed Flashing and Deflection Joint	58s.40 SCB
Brick Corbel at Parapet and Brick Band	58s.60 SCB

StoCast Brick over StoTherm® ci Brick Sill with Transition to Textured Finish

Detail No.: 58s.01 SCB

Date: December 2025

Page 1 of 2

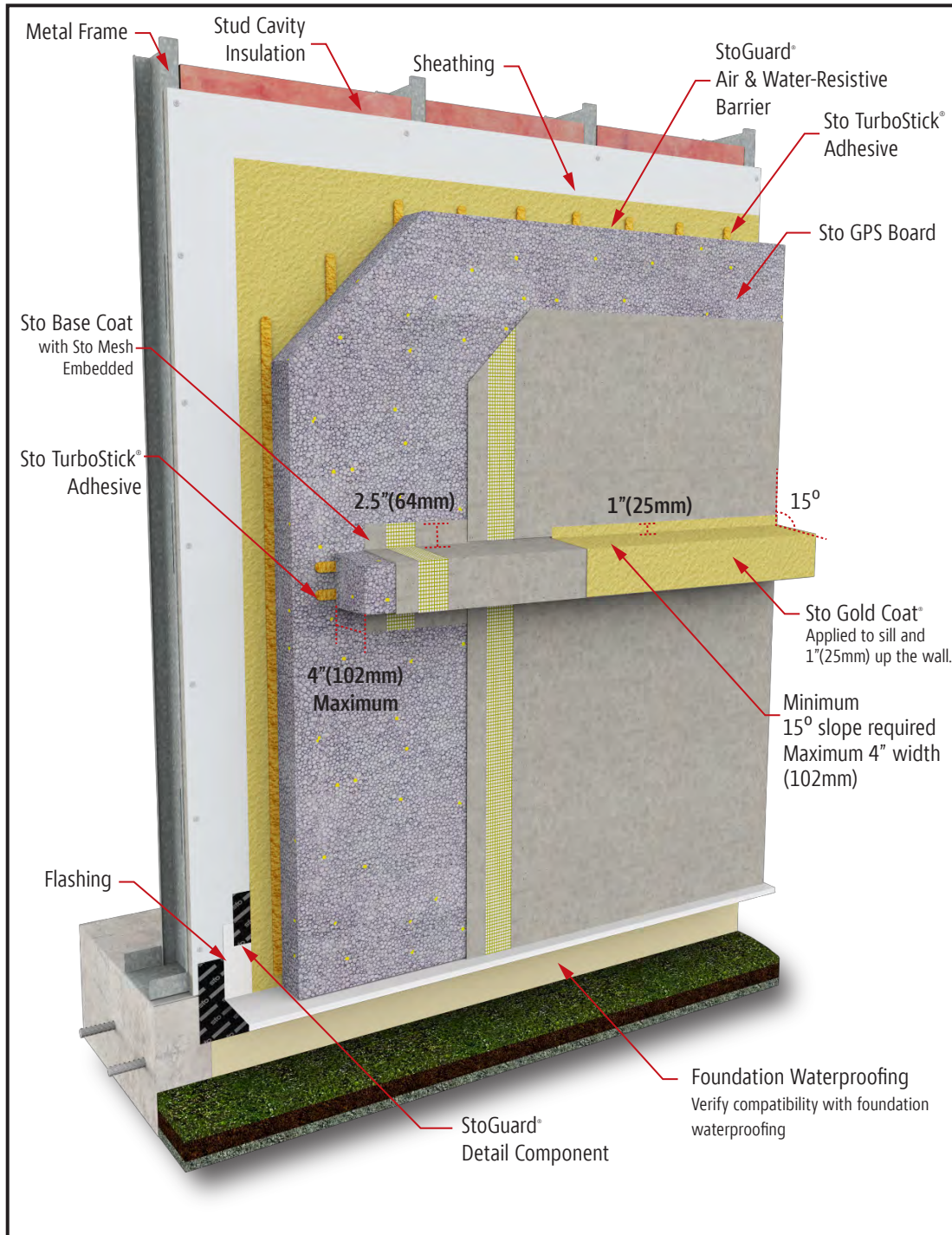

Notes:

1. External features, such as sills, quoins, etc., must be sloped a minimum of 15° degrees for widths greater than 1\"(25mm), up to a maximum of 4\"(102mm). For widths 1\"(25mm) or less, slope the top surface to direct water to the exterior.

2. Refer to applicable StoTherm® ci Design Guide and Detail Booklets for general design guidance, use, and limitations associated with StoTherm® ci Systems. Refer to applicable Product Bulletins for information on product use, handling, and limitations associated with specific products. Refer to Safety Data Sheets for health and safety information.

3. Components not identified as Sto are furnished by other manufacturers and are not necessarily installed by trades who install the Sto products. Refer to project specific contract documents.

ATTENTION

Property of Sto Corp. All Rights Reserved.

www.stocorp.com

Sto products are intended for use by qualified professional contractors, not consumers, as a component of a larger construction assembly as specified by a qualified design professional, general contractor or builder. They should be installed in accordance with those specifications and Sto's instructions. Sto Corp. disclaims all, and assumes no, liability for on-site inspections, for its products applied improperly, or by unqualified persons or entities, or as part of an improperly designed or constructed building, for the nonperformance of adjacent building components or assemblies, or for other construction activities beyond Sto's control. Improper use of Sto products or use as part of an improperly designed or constructed larger assembly or building may result in serious damage to Sto products, and to the structure of the building or its components.

STO CORP. DISCLAIMS ALL WARRANTIES EXPRESSED OR IMPLIED EXCEPT FOR EXPLICIT LIMITED WRITTEN WARRANTIES ISSUED TO AND ACCEPTED BY BUILDING OWNERS IN ACCORDANCE WITH STO'S WARRANTY PROGRAMS WHICH ARE SUBJECT TO CHANGE FROM TIME TO TIME. For the fullest, most current information on proper application, clean-up, mixing and other specifications and warranties, cautions and disclaimers, please refer to the Sto Corp. website, www.stocorp.com.



StoCast Brick over StoTherm® ci Brick Sill with Transition to Textured Finish

Detail No.: 58s.01 SCB

Date: December 2025

Page 2 of 2

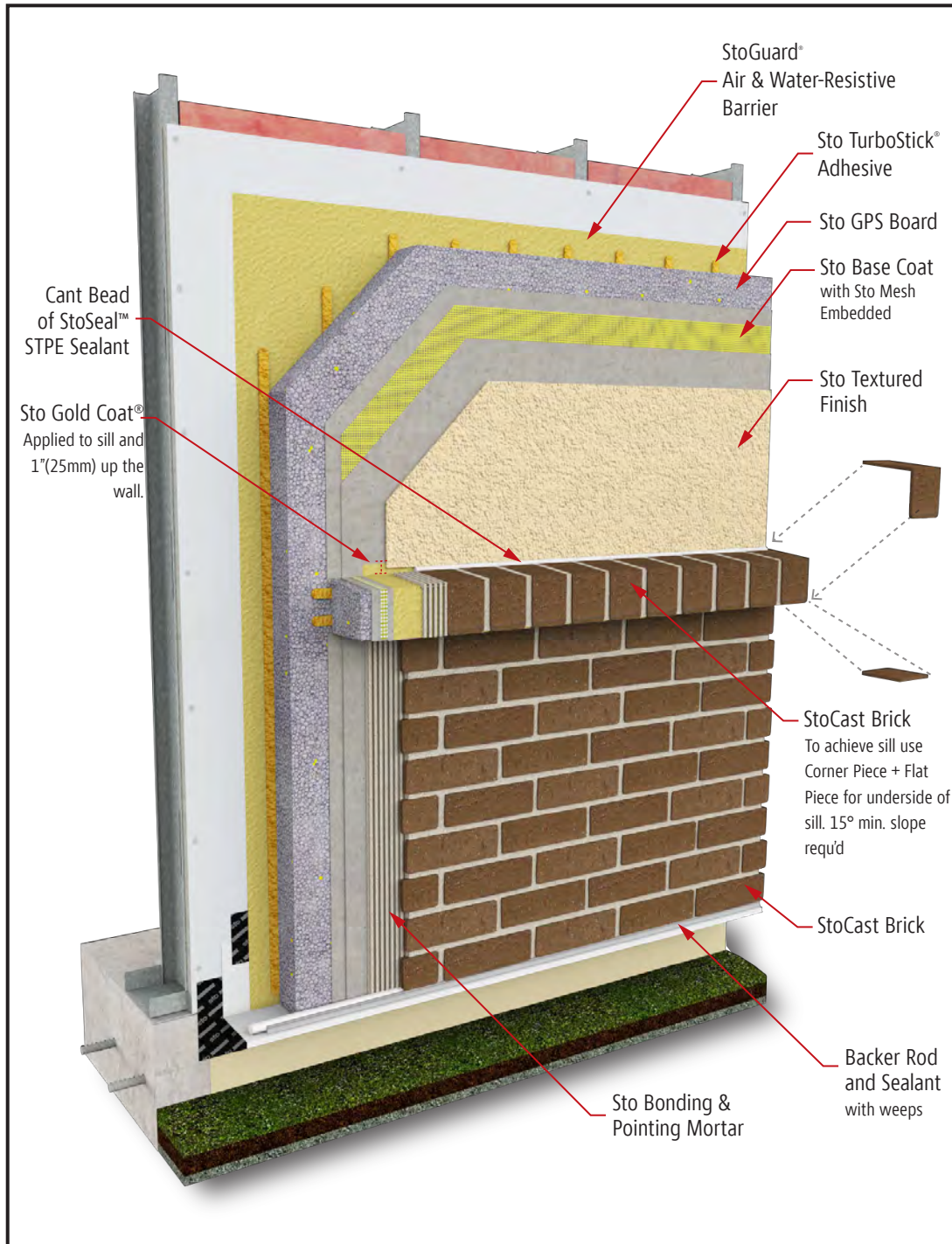

Notes:

1. External features, such as sills, quoins, etc., must be sloped a minimum of 15° degrees for widths greater than 1"(25mm), up to a maximum of 4"(102mm). For widths 1"(25mm) or less, slope the top surface to direct water to the exterior.

2. Refer to applicable StoTherm® ci Design Guide and Detail Booklets for general design guidance, use, and limitations associated with StoTherm® ci Systems. Refer to applicable Product Bulletins for information on product use, handling, and limitations associated with specific products. Refer to Safety Data Sheets for health and safety information.

3. Components not identified as Sto are furnished by other manufacturers and are not necessarily installed by trades who install the Sto products. Refer to project specific contract documents.

ATTENTION

Property of Sto Corp. All Rights Reserved.

Sto products are intended for use by qualified professional contractors, not consumers, as a component of a larger construction assembly as specified by a qualified design professional, general contractor or builder. They should be installed in accordance with those specifications and Sto's instructions. Sto Corp. disclaims all, and assumes no, liability for on-site inspections, for its products applied improperly, or by unqualified persons or entities, or as part of an improperly designed or constructed building, for the nonperformance of adjacent building components or assemblies, or for other construction activities beyond Sto's control. Improper use of Sto products or use as part of an improperly designed or constructed larger assembly or building may result in serious damage to Sto products, and to the structure of the building or its components.

STO CORP. DISCLAIMS ALL WARRANTIES EXPRESSED OR IMPLIED EXCEPT FOR EXPLICIT LIMITED WRITTEN WARRANTIES ISSUED TO AND ACCEPTED BY BUILDING OWNERS IN ACCORDANCE WITH STO'S WARRANTY PROGRAMS WHICH ARE SUBJECT TO CHANGE FROM TIME TO TIME. For the fullest, most current information on proper application, clean-up, mixing and other specifications and warranties, cautions and disclaimers, please refer to the Sto Corp. website, www.stocorp.com.

www.stocorp.com

StoCast Brick over StoTherm® ci Brick Outside and Inside Corner

Detail No.: 58s.10 SCB

Date: December 2025

Page 1 of 2

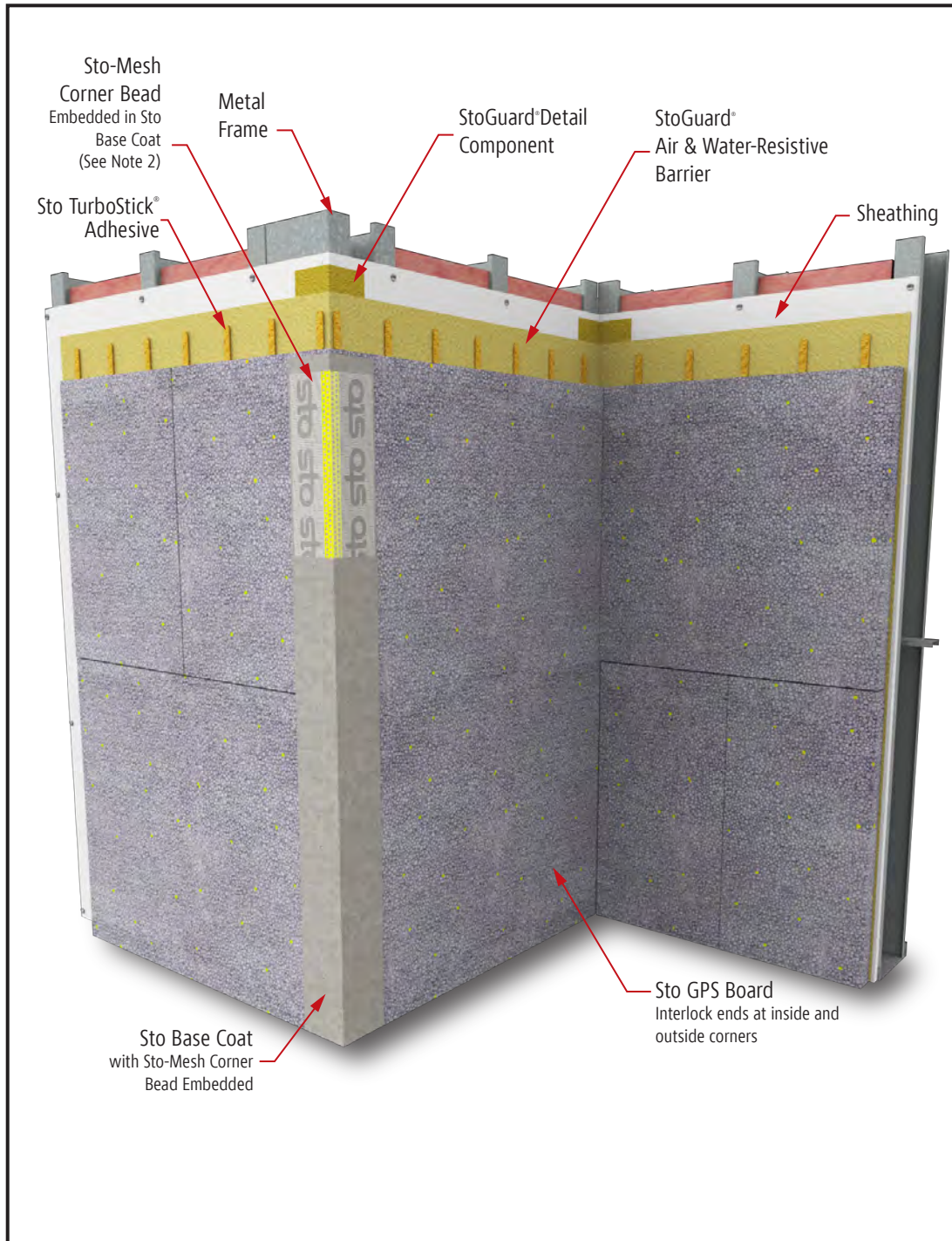

Notes:

1. External features, such as sills, quoins, etc., must be sloped a minimum of 15° degrees for widths greater than 1"(25mm), up to a maximum of 4"(102mm). For widths 1"(25mm) or less, slope the top surface to direct water to the exterior.

2. Refer to applicable StoTherm® ci Design Guide and Detail Booklets for general design guidance, use, and limitations associated with StoTherm® ci Systems. Refer to applicable Product Bulletins for information on product use, handling, and limitations associated with specific products. Refer to Safety Data Sheets for health and safety information.

3. Components not identified as Sto are furnished by other manufacturers and are not necessarily installed by trades who install the Sto products. Refer to project specific contract documents.

ATTENTION

Property of Sto Corp. All Rights Reserved.

www.stocorp.com

Sto products are intended for use by qualified professional contractors, not consumers, as a component of a larger construction assembly as specified by a qualified design professional, general contractor or builder. They should be installed in accordance with those specifications and Sto's instructions. Sto Corp. disclaims all, and assumes no, liability for on-site inspections, for its products applied improperly, or by unqualified persons or entities, or as part of an improperly designed or constructed building, for the nonperformance of adjacent building components or assemblies, or for other construction activities beyond Sto's control. Improper use of Sto products or use as part of an improperly designed or constructed larger assembly or building may result in serious damage to Sto products, and to the structure of the building or its components.

STO CORP. DISCLAIMS ALL WARRANTIES EXPRESSED OR IMPLIED EXCEPT FOR EXPLICIT LIMITED WRITTEN WARRANTIES ISSUED TO AND ACCEPTED BY BUILDING OWNERS IN ACCORDANCE WITH STO'S WARRANTY PROGRAMS WHICH ARE SUBJECT TO CHANGE FROM TIME TO TIME. For the fullest, most current information on proper application, clean-up, mixing and other specifications and warranties, cautions and disclaimers, please refer to the Sto Corp. website, www.stocorp.com.



StoCast Brick over StoTherm® ci Brick Outside and Inside Corner

Detail No.: 58s.10 SCB

Date: December 2025

Page 2 of 2

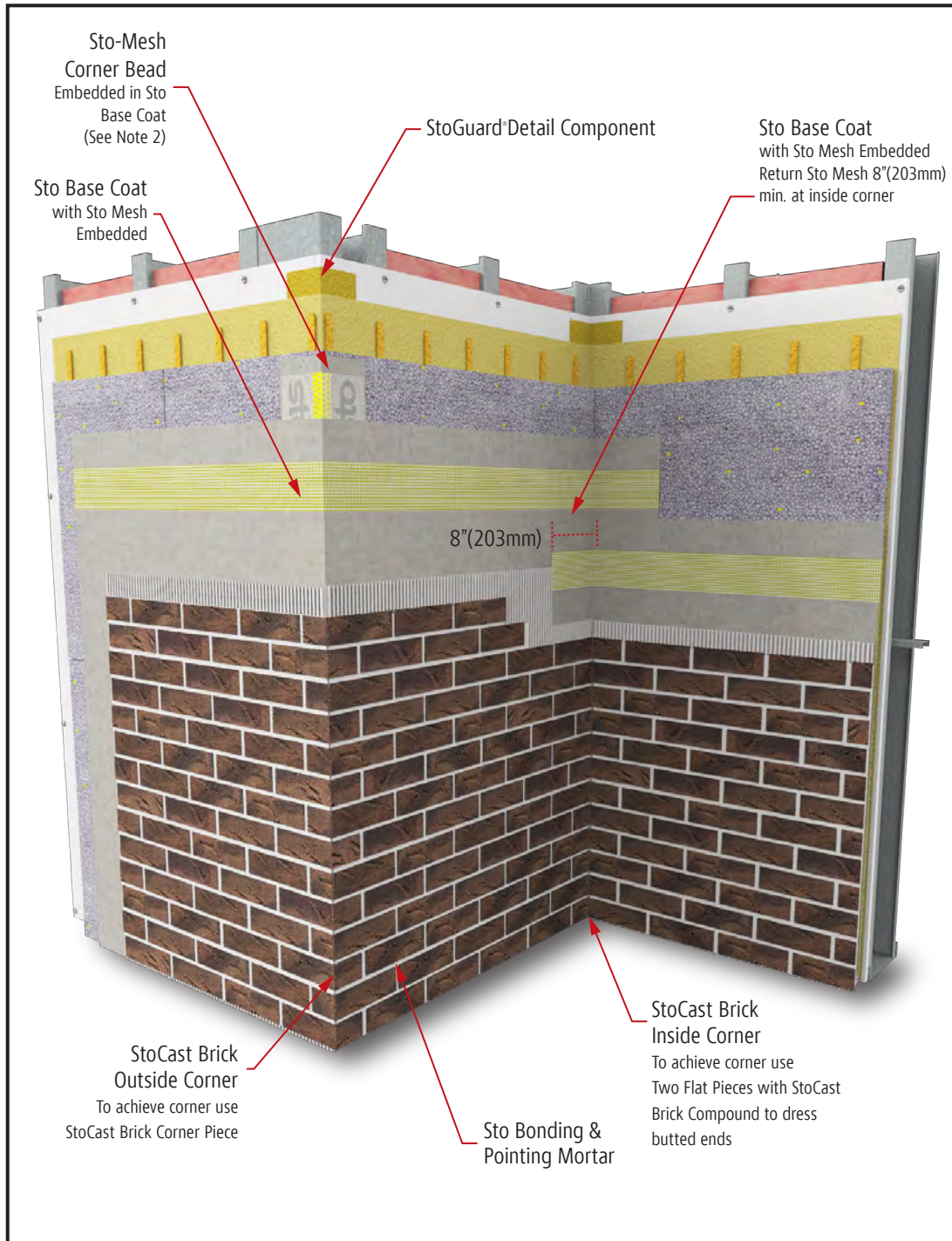

Notes:

1. External features, such as sills, quoins, etc., must be sloped a minimum of 15° degrees for widths greater than 1"(25mm), up to a maximum of 4"(102mm). For widths 1"(25mm) or less, slope the top surface to direct water to the exterior.

2. Refer to applicable StoTherm® ci Design Guide and Detail Booklets for general design guidance, use, and limitations associated with StoTherm® ci Systems. Refer to applicable Product Bulletins for information on product use, handling, and limitations associated with specific products. Refer to Safety Data Sheets for health and safety information.

3. Components not identified as Sto are furnished by other manufacturers and are not necessarily installed by trades who install the Sto products. Refer to project specific contract documents.

ATTENTION

Property of Sto Corp. All Rights Reserved.

www.stocorp.com

Sto products are intended for use by qualified professional contractors, not consumers, as a component of a larger construction assembly as specified by a qualified design professional, general contractor or builder. They should be installed in accordance with those specifications and Sto's instructions. Sto Corp. disclaims all, and assumes no, liability for on-site inspections, for its products applied improperly, or by unqualified persons or entities, or as part of an improperly designed or constructed building, for the nonperformance of adjacent building components or assemblies, or for other construction activities beyond Sto's control. Improper use of Sto products or use as part of an improperly designed or constructed larger assembly or building may result in serious damage to Sto products, and to the structure of the building or its components.

STO CORP. DISCLAIMS ALL WARRANTIES EXPRESSED OR IMPLIED EXCEPT FOR EXPLICIT LIMITED WRITTEN WARRANTIES ISSUED TO AND ACCEPTED BY BUILDING OWNERS IN ACCORDANCE WITH STO'S WARRANTY PROGRAMS WHICH ARE SUBJECT TO CHANGE FROM TIME TO TIME. For the fullest, most current information on proper application, clean-up, mixing and other specifications and warranties, cautions and disclaimers, please refer to the Sto Corp. website, www.stocorp.com.



StoCast Brick over StoTherm® ci Brick Outside Corner with Quoins

Detail No.: 58s.12 SCB

Date: December 2025

Page 1 of 4

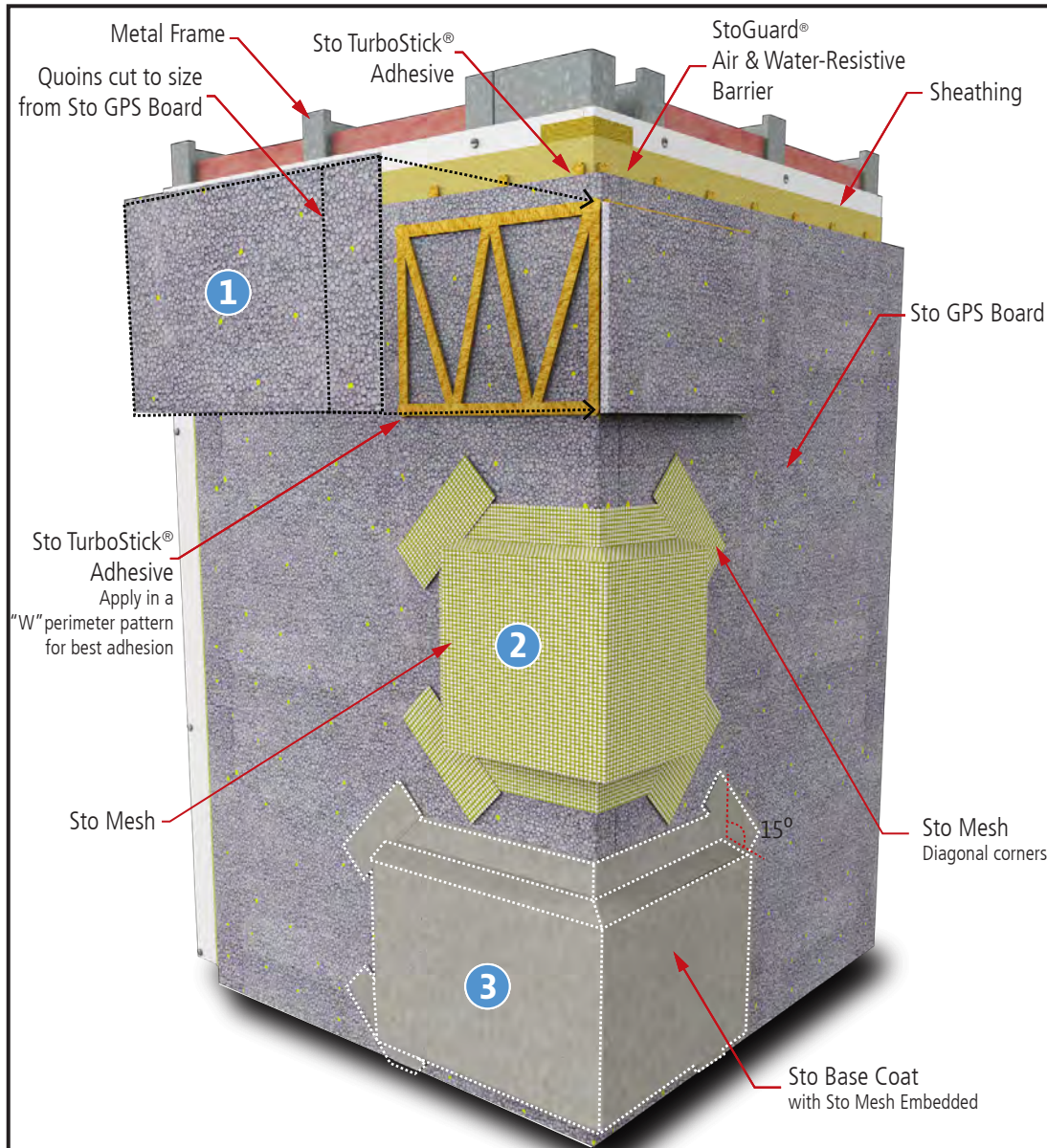

STEP 1

Cut Sto GPS Board to size, maintaining a 15° minimum slope on top. Adhere the quoin using Sto TurboStick® Adhesive.

STEP 2

Cut Sto Mesh to cover all sides of the quoin, overlapping by a minimum of 2.5" (64mm) onto the base layer of Sto GPS Board and using diagonal strips at corners.

STEP 3

Fully embed Sto Mesh in Sto Base Coat.

Notes:

1. External features, such as sills, quoins, etc., must be sloped a minimum of 15° degrees for widths greater than 1"(25mm), up to a maximum of 4"(102mm). For widths 1"(25mm) or less, slope the top surface to direct water to the exterior.

2. Refer to applicable StoTherm® ci Design Guide and Detail Booklets for general design guidance, use, and limitations associated with StoTherm® ci Systems. Refer to applicable Product Bulletins for information on product use, handling, and limitations associated with specific products. Refer to Safety Data Sheets for health and safety information.

3. Components not identified as Sto are furnished by other manufacturers and are not necessarily installed by trades who install the Sto products. Refer to project specific contract documents.

ATTENTION

Property of Sto Corp. All Rights Reserved.

www.stocorp.com

Sto products are intended for use by qualified professional contractors, not consumers, as a component of a larger construction assembly as specified by a qualified design professional, general contractor or builder. They should be installed in accordance with those specifications and Sto's instructions. Sto Corp. disclaims all, and assumes no, liability for on-site inspections, for its products applied improperly, or by unqualified persons or entities, or as part of an improperly designed or constructed building, for the nonperformance of adjacent building components or assemblies, or for other construction activities beyond Sto's control. Improper use of Sto products or use as part of an improperly designed or constructed larger assembly or building may result in serious damage to Sto products, and to the structure of the building or its components.

STO CORP. DISCLAIMS ALL WARRANTIES EXPRESSED OR IMPLIED EXCEPT FOR EXPLICIT LIMITED WRITTEN WARRANTIES ISSUED TO AND ACCEPTED BY BUILDING OWNERS IN ACCORDANCE WITH STO'S WARRANTY PROGRAMS WHICH ARE SUBJECT TO CHANGE FROM TIME TO TIME. For the fullest, most current information on proper application, clean-up, mixing and other specifications and warranties, cautions and disclaimers, please refer to the Sto Corp. website, www.stocorp.com.



StoCast Brick over StoTherm® ci Brick Outside Corner with Quoins

Detail No.: 58s.12 SCB

Date: December 2025

Page 2 of 4

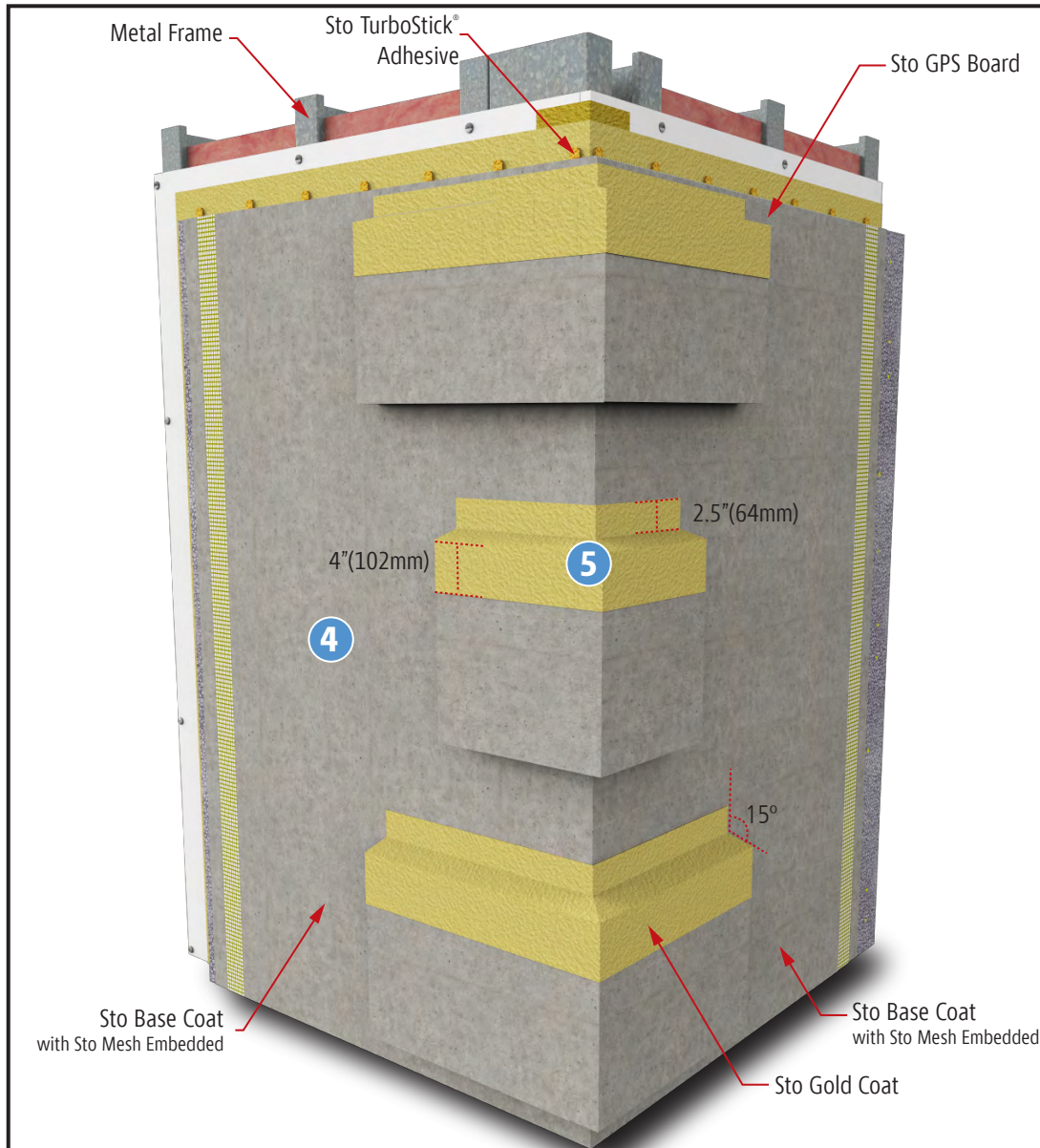

Notes:

1. External features, such as sills, quoins, etc., must be sloped a minimum of 15° degrees for widths greater than 1"(25mm), up to a maximum of 4"(102mm). For widths 1"(25mm) or less, slope the top surface to direct water to the exterior.

2. Refer to applicable StoTherm® ci Design Guide and Detail Booklets for general design guidance, use, and limitations associated with StoTherm® ci Systems. Refer to applicable Product Bulletins for information on product use, handling, and limitations associated with specific products. Refer to Safety Data Sheets for health and safety information.

3. Components not identified as Sto are furnished by other manufacturers and are not necessarily installed by trades who install the Sto products. Refer to project specific contract documents.

STEP 4

Complete the remaining wall surface with Sto Base Coat with Sto Mesh embedded and allow to completely dry.

STEP 5

Apply Sto Gold Coat to quoins and provide minimum of 4"(102mm) on the face of the quoin and 2.5"(64mm) overlap onto the base layer of Sto GPS Board.

ATTENTION

Property of Sto Corp. All Rights Reserved.

Sto products are intended for use by qualified professional contractors, not consumers, as a component of a larger construction assembly as specified by a qualified design professional, general contractor or builder. They should be installed in accordance with those specifications and Sto's instructions. Sto Corp. disclaims all, and assumes no, liability for on-site inspections, for its products applied improperly, or by unqualified persons or entities, or as part of an improperly designed or constructed building, for the nonperformance of adjacent building components or assemblies, or for other construction activities beyond Sto's control. Improper use of Sto products or use as part of an improperly designed or constructed larger assembly or building may result in serious damage to Sto products, and to the structure of the building or its components.

STO CORP. DISCLAIMS ALL WARRANTIES EXPRESSED OR IMPLIED EXCEPT FOR EXPLICIT LIMITED WRITTEN WARRANTIES ISSUED TO AND ACCEPTED BY BUILDING OWNERS IN ACCORDANCE WITH STO'S WARRANTY PROGRAMS WHICH ARE SUBJECT TO CHANGE FROM TIME TO TIME. For the fullest, most current information on proper application, clean-up, mixing and other specifications and warranties, cautions and disclaimers, please refer to the Sto Corp. website, www.stocorp.com.

www.stocorp.com



StoCast Brick over StoTherm® ci Brick Outside Corner with Quoins

Detail No.: 58s.12 SCB

Date: December 2025

Page 3 of 4

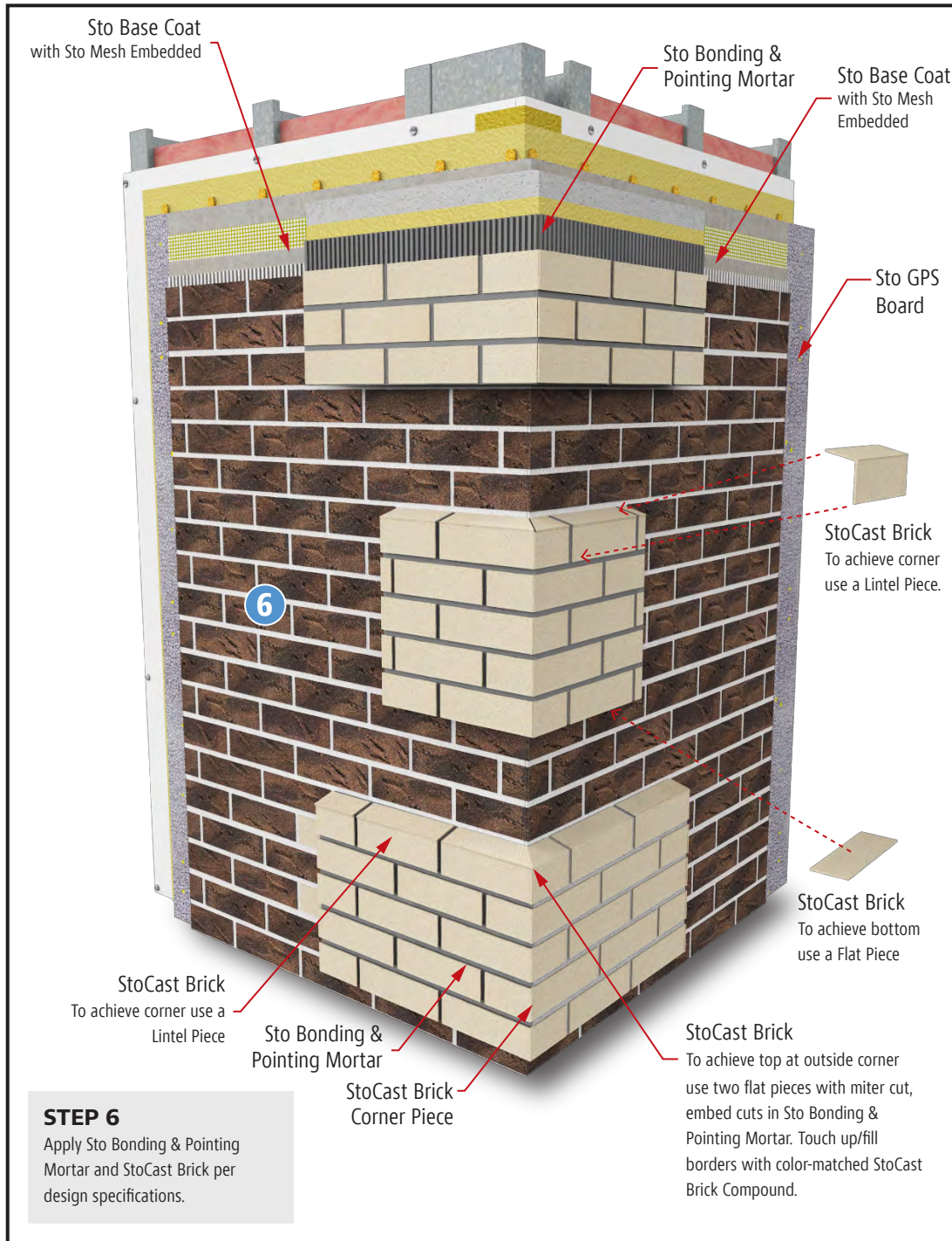

Notes:

1. External features, such as sills, quoins, etc., must be sloped a minimum of 15° degrees for widths greater than 1"(25mm), up to a maximum of 4"(102mm). For widths 1"(25mm) or less, slope the top surface to direct water to the exterior.

2. Refer to applicable StoTherm® ci Design Guide and Detail Booklets for general design guidance, use, and limitations associated with StoTherm® ci Systems. Refer to applicable Product Bulletins for information on product use, handling, and limitations associated with specific products. Refer to Safety Data Sheets for health and safety information.

3. Components not identified as Sto are furnished by other manufacturers and are not necessarily installed by trades who install the Sto products. Refer to project specific contract documents.

ATTENTION

Property of Sto Corp. All Rights Reserved.

www.stocorp.com

Sto products are intended for use by qualified professional contractors, not consumers, as a component of a larger construction assembly as specified by a qualified design professional, general contractor or builder. They should be installed in accordance with those specifications and Sto's instructions. Sto Corp. disclaims all, and assumes no, liability for on-site inspections, for its products applied improperly, or by unqualified persons or entities, or as part of an improperly designed or constructed building, for the nonperformance of adjacent building components or assemblies, or for other construction activities beyond Sto's control. Improper use of Sto products or use as part of an improperly designed or constructed larger assembly or building may result in serious damage to Sto products, and to the structure of the building or its components.

STO CORP. DISCLAIMS ALL WARRANTIES EXPRESSED OR IMPLIED EXCEPT FOR EXPLICIT LIMITED WRITTEN WARRANTIES ISSUED TO AND ACCEPTED BY BUILDING OWNERS IN ACCORDANCE WITH STO'S WARRANTY PROGRAMS WHICH ARE SUBJECT TO CHANGE FROM TIME TO TIME. For the fullest, most current information on proper application, clean-up, mixing and other specifications and warranties, cautions and disclaimers, please refer to the Sto Corp. website, www.stocorp.com.



StoCast Brick over StoTherm® ci Brick Outside Corner with Quoins

Detail No.: 58s.12 SCB

Date: December 2025

Page 4 of 4

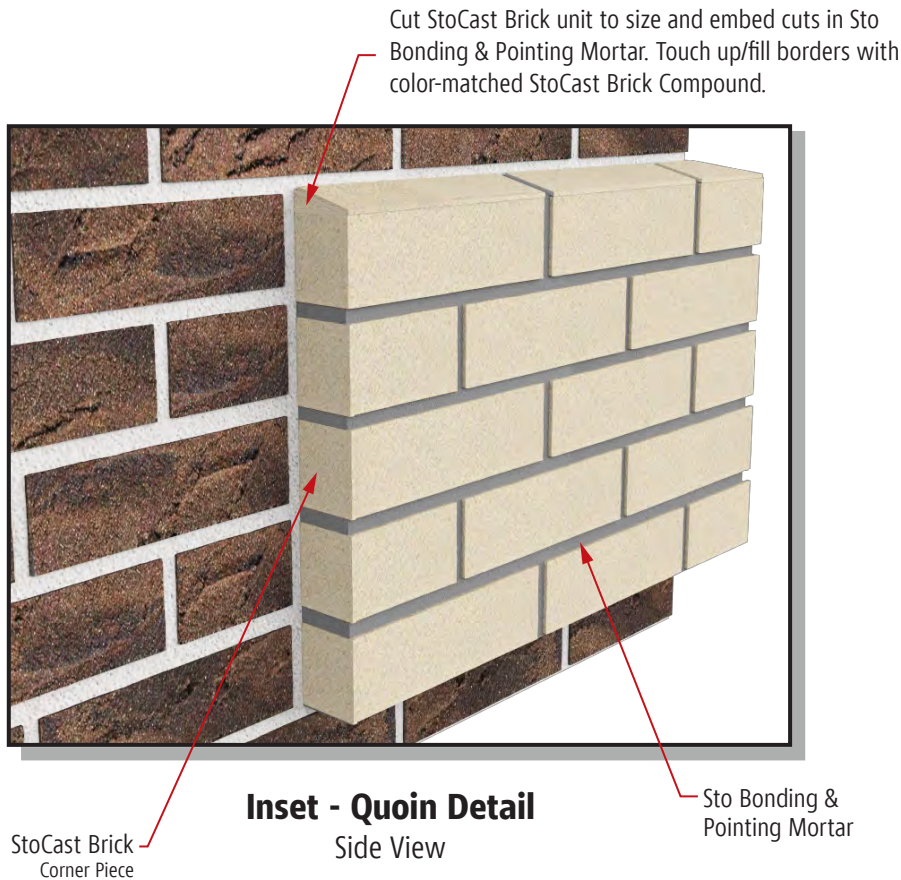

Notes:

1. External features, such as sills, quoins, etc., must be sloped a minimum of 15° degrees for widths greater than 1"(25mm), up to a maximum of 4"(102mm). For widths 1"(25mm) or less, slope the top surface to direct water to the exterior.

2. Refer to applicable StoTherm® ci Design Guide and Detail Booklets for general design guidance, use, and limitations associated with StoTherm® ci Systems. Refer to applicable Product Bulletins for information on product use, handling, and limitations associated with specific products. Refer to Safety Data Sheets for health and safety information.

3. Components not identified as Sto are furnished by other manufacturers and are not necessarily installed by trades who install the Sto products. Refer to project specific contract documents.

ATTENTION

Property of Sto Corp. All Rights Reserved.

www.stocorp.com

Sto products are intended for use by qualified professional contractors, not consumers, as a component of a larger construction assembly as specified by a qualified design professional, general contractor or builder. They should be installed in accordance with those specifications and Sto's instructions. Sto Corp. disclaims all, and assumes no, liability for on-site inspections, for its products applied improperly, or by unqualified persons or entities, or as part of an improperly designed or constructed building, for the nonperformance of adjacent building components or assemblies, or for other construction activities beyond Sto's control. Improper use of Sto products or use as part of an improperly designed or constructed larger assembly or building may result in serious damage to Sto products, and to the structure of the building or its components.

STO CORP. DISCLAIMS ALL WARRANTIES EXPRESSED OR IMPLIED EXCEPT FOR EXPLICIT LIMITED WRITTEN WARRANTIES ISSUED TO AND ACCEPTED BY BUILDING OWNERS IN ACCORDANCE WITH STO'S WARRANTY PROGRAMS WHICH ARE SUBJECT TO CHANGE FROM TIME TO TIME. For the fullest, most current information on proper application, clean-up, mixing and other specifications and warranties, cautions and disclaimers, please refer to the Sto Corp. website, www.stocorp.com.



StoCast Brick over StoTherm® ci Window Opening with Brick Sill and Header

Detail No.: 58s.23 SCB

Date: December 2025

Page 1 of 4

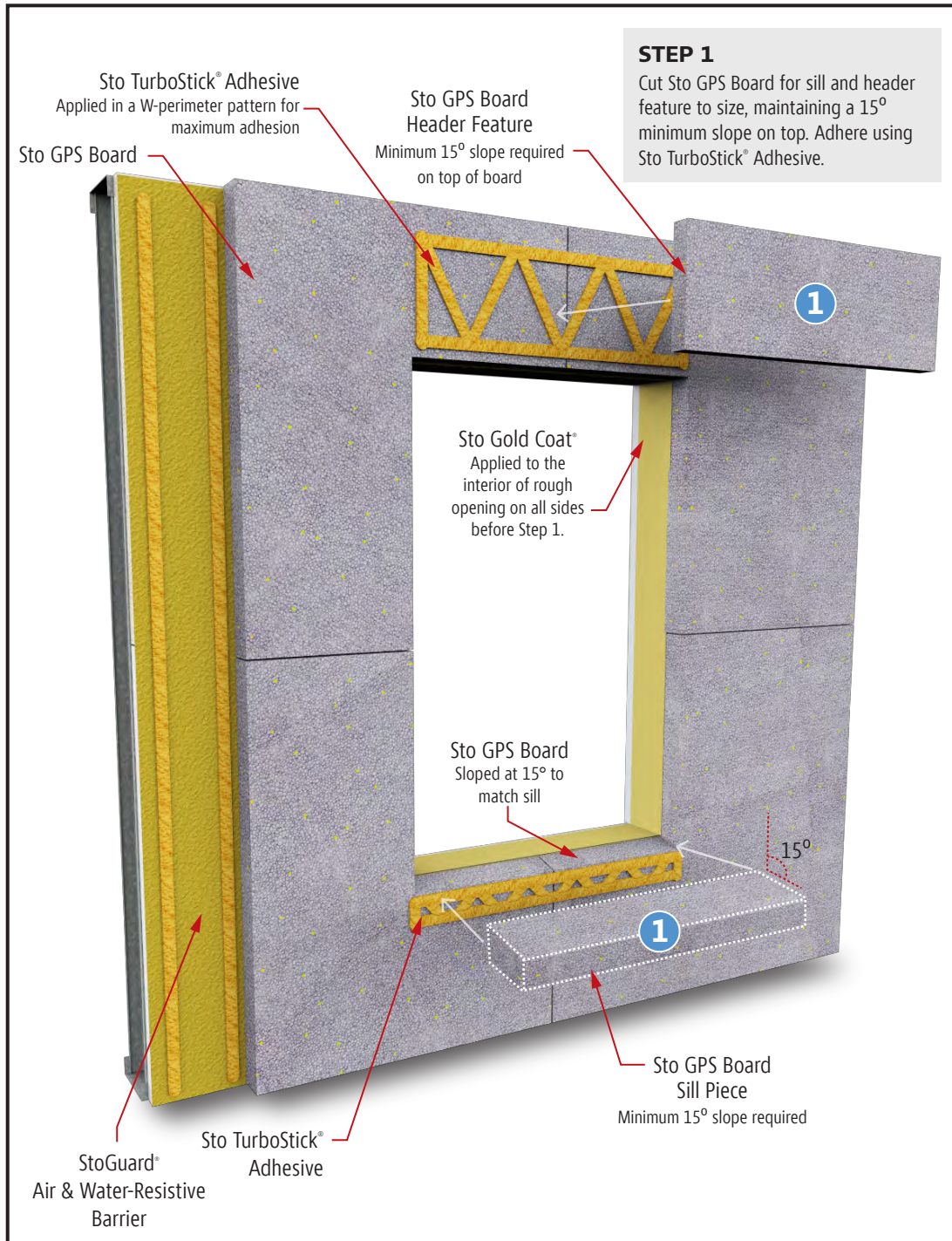

Notes:

1. External features, such as sills, quoins, etc., must be sloped a minimum of 15° degrees for widths greater than 1"(25mm), up to a maximum of 4"(102mm). For widths 1"(25mm) or less, slope the top surface to direct water to the exterior.

2. Refer to applicable StoTherm® ci Design Guide and Detail Booklets for general design guidance, use, and limitations associated with StoTherm® ci Systems. Refer to applicable Product Bulletins for information on product use, handling, and limitations associated with specific products. Refer to Safety Data Sheets for health and safety information.

3. Components not identified as Sto are furnished by other manufacturers and are not necessarily installed by trades who install the Sto products. Refer to project specific contract documents.

ATTENTION

Property of Sto Corp. All Rights Reserved.

www.stocorp.com

Sto products are intended for use by qualified professional contractors, not consumers, as a component of a larger construction assembly as specified by a qualified design professional, general contractor or builder. They should be installed in accordance with those specifications and Sto's instructions. Sto Corp. disclaims all, and assumes no, liability for on-site inspections, for its products applied improperly, or by unqualified persons or entities, or as part of an improperly designed or constructed building, for the nonperformance of adjacent building components or assemblies, or for other construction activities beyond Sto's control. Improper use of Sto products or use as part of an improperly designed or constructed larger assembly or building may result in serious damage to Sto products, and to the structure of the building or its components.

STO CORP. DISCLAIMS ALL WARRANTIES EXPRESSED OR IMPLIED EXCEPT FOR EXPLICIT LIMITED WRITTEN WARRANTIES ISSUED TO AND ACCEPTED BY BUILDING OWNERS IN ACCORDANCE WITH STO'S WARRANTY PROGRAMS WHICH ARE SUBJECT TO CHANGE FROM TIME TO TIME. For the fullest, most current information on proper application, clean-up, mixing and other specifications and warranties, cautions and disclaimers, please refer to the Sto Corp. website, www.stocorp.com.



StoCast Brick over StoTherm® ci Window Opening with Brick Sill and Header

Detail No.: 58s.23 SCB

Date: December 2025

Page 2 of 4

STEP 2

Apply Sto Base Coat with Sto Mesh embedded to the sill, header feature and jamb, maintaining a 2.5" (64mm) overlap onto the base layer of Sto GPS Board.

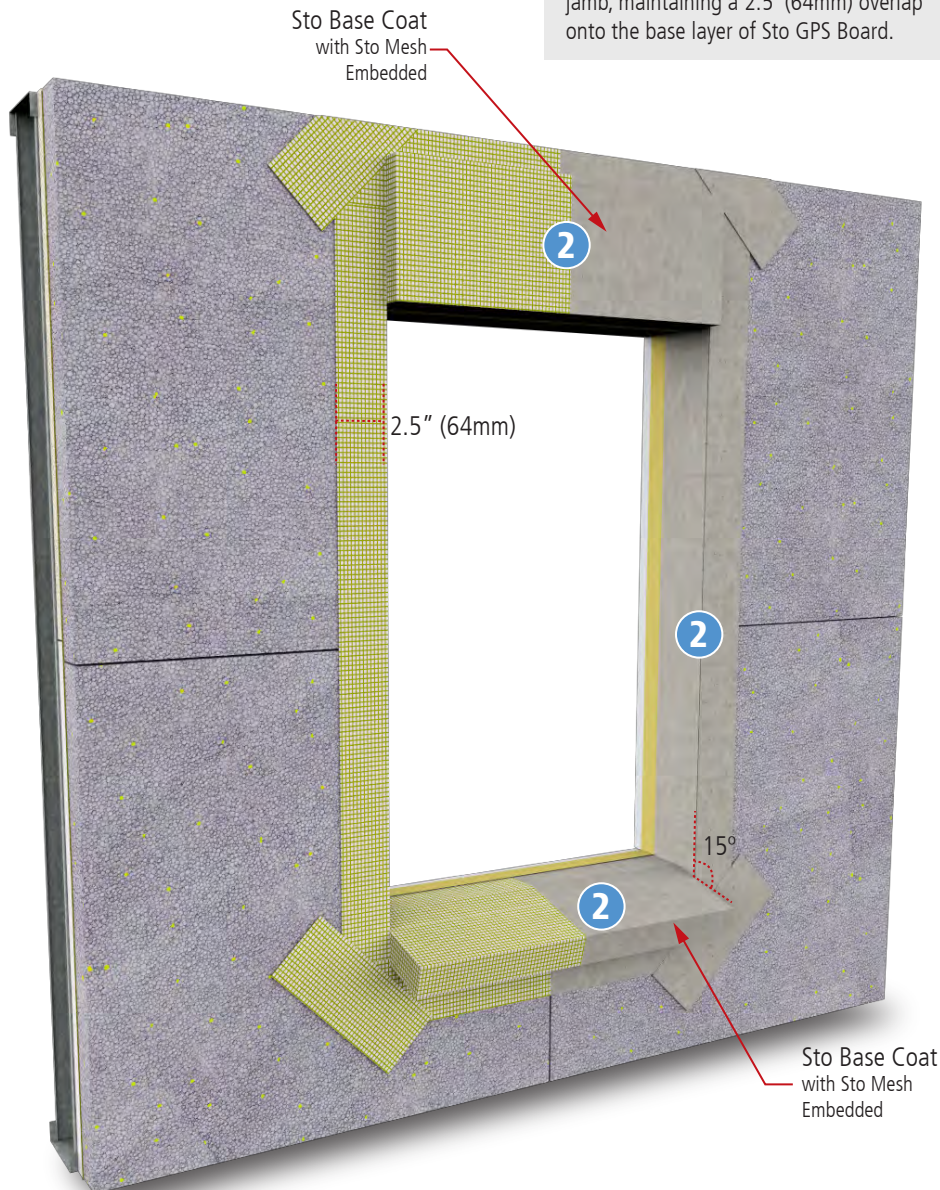

Notes:

1. External features, such as sills, quoins, etc., must be sloped a minimum of 15° degrees for widths greater than 1"(25mm), up to a maximum of 4"(102mm). For widths 1"(25mm) or less, slope the top surface to direct water to the exterior.

2. Refer to applicable StoTherm® ci Design Guide and Detail Booklets for general design guidance, use, and limitations associated with StoTherm® ci Systems. Refer to applicable Product Bulletins for information on product use, handling, and limitations associated with specific products. Refer to Safety Data Sheets for health and safety information.

3. Components not identified as Sto are furnished by other manufacturers and are not necessarily installed by trades who install the Sto products. Refer to project specific contract documents.

ATTENTION

Property of Sto Corp. All Rights Reserved.

www.stocorp.com

Sto products are intended for use by qualified professional contractors, not consumers, as a component of a larger construction assembly as specified by a qualified design professional, general contractor or builder. They should be installed in accordance with those specifications and Sto's instructions. Sto Corp. disclaims all, and assumes no, liability for on-site inspections, for its products applied improperly, or by unqualified persons or entities, or as part of an improperly designed or constructed building, for the nonperformance of adjacent building components or assemblies, or for other construction activities beyond Sto's control. Improper use of Sto products or use as part of an improperly designed or constructed larger assembly or building may result in serious damage to Sto products, and to the structure of the building or its components.

STO CORP. DISCLAIMS ALL WARRANTIES EXPRESSED OR IMPLIED EXCEPT FOR EXPLICIT LIMITED WRITTEN WARRANTIES ISSUED TO AND ACCEPTED BY BUILDING OWNERS IN ACCORDANCE WITH STO'S WARRANTY PROGRAMS WHICH ARE SUBJECT TO CHANGE FROM TIME TO TIME. For the fullest, most current information on proper application, clean-up, mixing and other specifications and warranties, cautions and disclaimers, please refer to the Sto Corp. website, www.stocorp.com.



StoCast Brick over StoTherm® ci Window Opening with Brick Sill and Header

Detail No.: 58s.23 SCB

Date: December 2025

Page 3 of 4

Notes:

1. External features, such as sills, quoins, etc., must be sloped a minimum of 15° degrees for widths greater than 1"(25mm) up to a maximum of 4"(102mm). For widths 1"(25mm) or less, slope the top surface to direct water to the exterior.

2. Refer to applicable StoTherm® ci Design Guide and Detail Booklets for general design guidance, use, and limitations associated with StoTherm® ci Systems. Refer to applicable Product Bulletins for information on product use, handling, and limitations associated with specific products. Refer to Safety Data Sheets for health and safety information.

3. Adjust location of window and Sto Gold Coat termination to allow for application of sealant around perimeter of window. Terminate Sto Gold Coat® in line with the outer face of the perimeter sealant (shown) to allow for sealant application to the base coat. Alternatively, apply Sto Gold Coat® into the opening and apply sealant to Sto Gold Coat® all the way around the opening. Perimeter seal should not be applied to StoCast Brick.

4. Components not identified as Sto are furnished by other manufacturers and are not necessarily installed by trades who install the Sto products. Refer to project specific contract documents.

STEP 3

Apply Sto Base Coat with Sto Mesh embedded to the remaining surface of the wall and allow to dry. Next, apply Sto Gold Coat® over the sill, jamb and header. Maintain a minimum 2.5"(64mm) overlap onto the base layer of Sto GPS Board and minimum 4"(102mm) onto the face planes of the feature.

Sto Base Coat
with Sto Mesh
Embedded

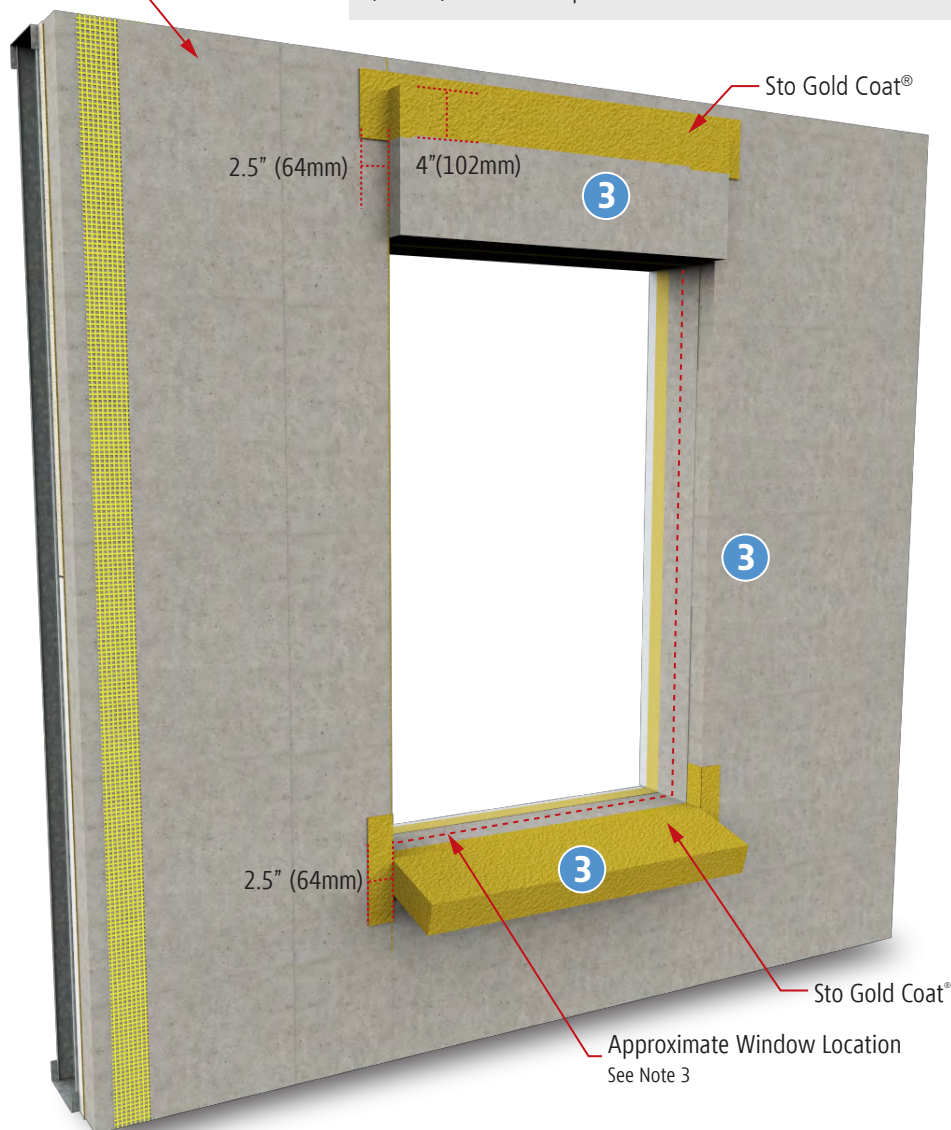

ATTENTION

Property of Sto Corp. All Rights Reserved.

Sto products are intended for use by qualified professional contractors, not consumers, as a component of a larger construction assembly as specified by a qualified design professional, general contractor or builder. They should be installed in accordance with those specifications and Sto's instructions. Sto Corp. disclaims all, and assumes no, liability for on-site inspections, for its products applied improperly, or by unqualified persons or entities, or as part of an improperly designed or constructed building, for the nonperformance of adjacent building components or assemblies, or for other construction activities beyond Sto's control. Improper use of Sto products or use as part of an improperly designed or constructed larger assembly or building may result in serious damage to Sto products, and to the structure of the building or its components.

STO CORP. DISCLAIMS ALL WARRANTIES EXPRESSED OR IMPLIED EXCEPT FOR EXPLICIT LIMITED WRITTEN WARRANTIES ISSUED TO AND ACCEPTED BY BUILDING OWNERS IN ACCORDANCE WITH STO'S WARRANTY PROGRAMS WHICH ARE SUBJECT TO CHANGE FROM TIME TO TIME. For the fullest, most current information on proper application, clean-up, mixing and other specifications and warranties, cautions and disclaimers, please refer to the Sto Corp. website, www.stocorp.com.

www.stocorp.com



StoCast Brick over StoTherm®ci Window Opening with Brick Sill and Header

Detail No.: 58s.23 SCB

Date: December 2025

Page 4 of 4

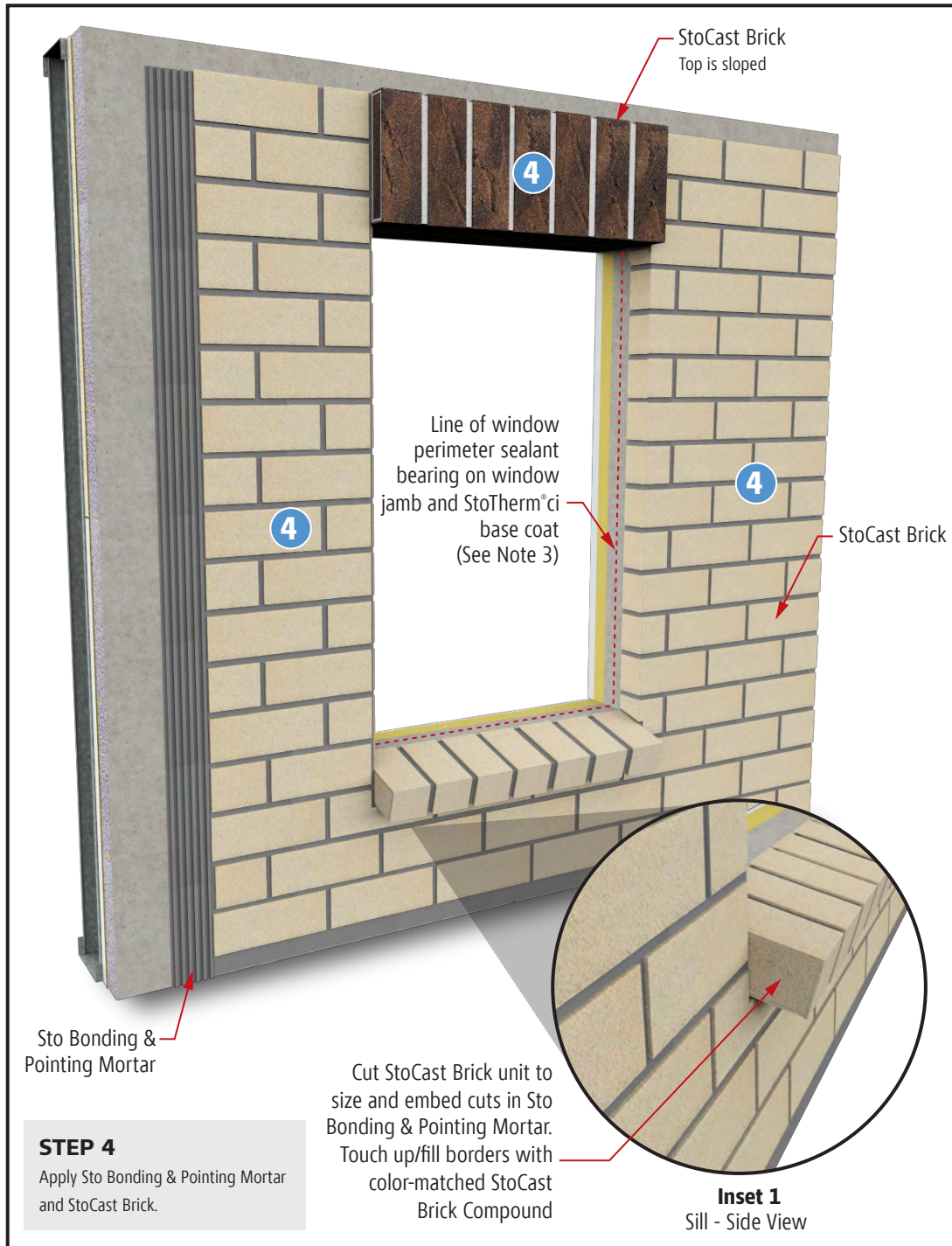

Notes:

1. External features, such as sills, quoins, etc., must be sloped a minimum of 15° degrees for widths greater than 1"(25mm) up to a maximum of 4"(102mm). For widths 1"(25mm) or less, slope the top surface to direct water to the exterior.
2. Refer to applicable StoTherm®ci Design Guide and Detail Booklets for general design guidance, use, and limitations associated with StoTherm®ci Systems. Refer to applicable Product Bulletins for information on product use, handling, and limitations associated with specific products. Refer to Safety Data Sheets for health and safety information.
3. Adjust location of window and Sto Gold Coat termination to allow for application of sealant around perimeter of window. Terminate Sto Gold Coat® in line with the outer face of the perimeter sealant (shown) to allow for sealant application to the base coat. Alternatively, apply Sto Gold Coat® into the opening and apply sealant to Sto Gold Coat® all the way around the opening. Perimeter seal should not be applied to StoCast Brick.
4. Components not identified as Sto are furnished by other manufacturers and are not necessarily installed by trades who install the Sto products. Refer to project specific contract documents.

ATTENTION

Property of Sto Corp. All Rights Reserved.

Sto products are intended for use by qualified professional contractors, not consumers, as a component of a larger construction assembly as specified by a qualified design professional, general contractor or builder. They should be installed in accordance with those specifications and Sto's instructions. Sto Corp. disclaims all, and assumes no, liability for on-site inspections, for its products applied improperly, or by unqualified persons or entities, or as part of an improperly designed or constructed building, for the nonperformance of adjacent building components or assemblies, or for other construction activities beyond Sto's control. Improper use of Sto products or use as part of an improperly designed or constructed larger assembly or building may result in serious damage to Sto products, and to the structure of the building or its components.

STO CORP. DISCLAIMS ALL WARRANTIES EXPRESSED OR IMPLIED EXCEPT FOR EXPLICIT LIMITED WRITTEN WARRANTIES ISSUED TO AND ACCEPTED BY BUILDING OWNERS IN ACCORDANCE WITH STO'S WARRANTY PROGRAMS WHICH ARE SUBJECT TO CHANGE FROM TIME TO TIME. For the fullest, most current information on proper application, clean-up, mixing and other specifications and warranties, cautions and disclaimers, please refer to the Sto Corp. website, www.stocorp.com.

www.stocorp.com



StoCast Brick over StoTherm® ci Termination at Floor Line with Concealed Flashing & Deflection Joint

Detail No.: 58s.40 SCB
Date: December 2025

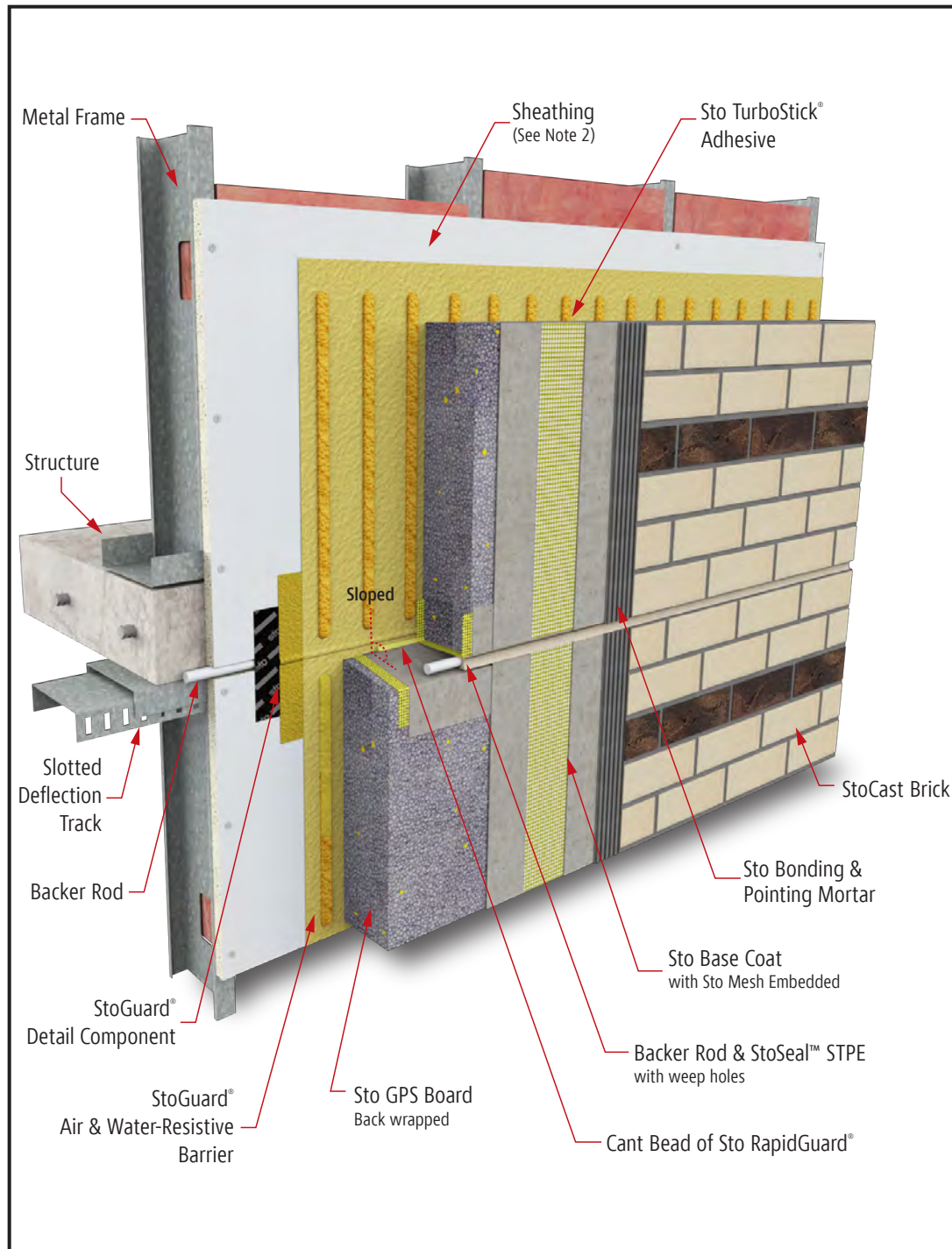

Notes:

1. External features, such as sills, quoins, etc., must be sloped a minimum of 15° degrees for widths greater than 1"(25mm), up to a maximum of 4"(102mm). For widths 1"(25mm) or less, slope the top surface to direct water to the exterior.

2. Refer to applicable StoTherm® ci Design Guide and Detail Booklets for general design guidance, use, and limitations associated with StoTherm® ci Systems. Refer to applicable Product Bulletins for information on product use, handling, and limitations associated with specific products. Refer to Safety Data Sheets for health and safety information.

3. Components not identified as Sto are furnished by other manufacturers and are not necessarily installed by trades who install the Sto products. Refer to project specific contract documents.

ATTENTION

Property of Sto Corp. All Rights Reserved.

www.stocorp.com

Sto products are intended for use by qualified professional contractors, not consumers, as a component of a larger construction assembly as specified by a qualified design professional, general contractor or builder. They should be installed in accordance with those specifications and Sto's instructions. Sto Corp. disclaims all, and assumes no, liability for on-site inspections, for its products applied improperly, or by unqualified persons or entities, or as part of an improperly designed or constructed building, for the nonperformance of adjacent building components or assemblies, or for other construction activities beyond Sto's control. Improper use of Sto products or use as part of an improperly designed or constructed larger assembly or building may result in serious damage to Sto products, and to the structure of the building or its components.

STO CORP. DISCLAIMS ALL WARRANTIES EXPRESSED OR IMPLIED EXCEPT FOR EXPLICIT LIMITED WRITTEN WARRANTIES ISSUED TO AND ACCEPTED BY BUILDING OWNERS IN ACCORDANCE WITH STO'S WARRANTY PROGRAMS WHICH ARE SUBJECT TO CHANGE FROM TIME TO TIME. For the fullest, most current information on proper application, clean-up, mixing and other specifications and warranties, cautions and disclaimers, please refer to the Sto Corp. website, www.stocorp.com.



StoCast Brick over StoTherm® ci Brick Corbel at Parapet and Brick Band

Detail No.: 58s.60 SCB

Date: December 2025

Page 1 of 3

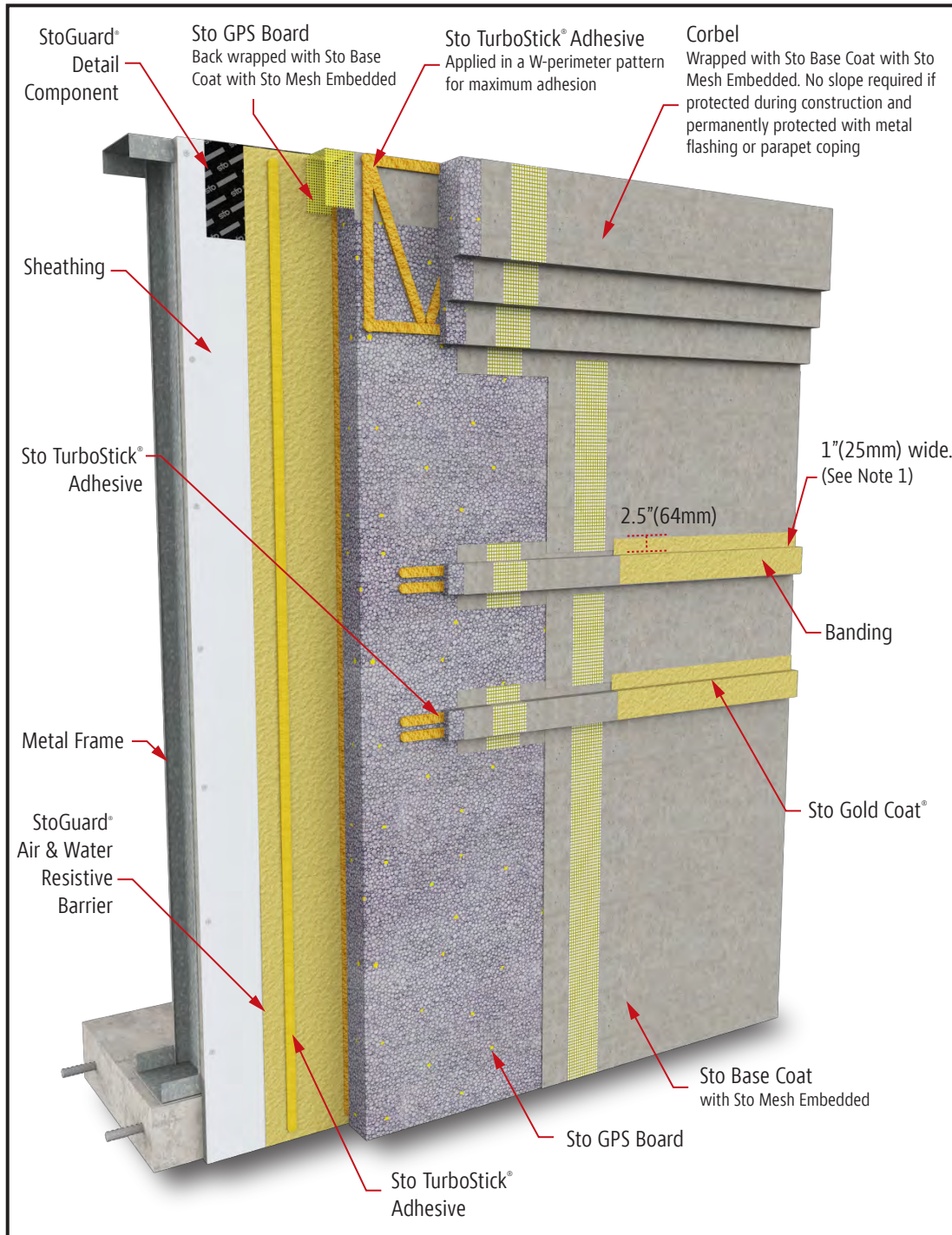

Notes:

1. External features, such as sills, quoins, etc., must be sloped a minimum of 15° degrees for widths greater than 1"(25mm), up to a maximum of 4"(102mm). For widths 1"(25mm) or less, slope the top surface to direct water to the exterior.

2. Refer to applicable StoTherm® ci Design Guide and Detail Booklets for general design guidance, use, and limitations associated with StoTherm® ci Systems. Refer to applicable Product Bulletins for information on product use, handling, and limitations associated with specific products. Refer to Safety Data Sheets for health and safety information.

3. Components not identified as Sto are furnished by other manufacturers and are not necessarily installed by trades who install the Sto products. Refer to project specific contract documents.

ATTENTION

Property of Sto Corp. All Rights Reserved.

www.stocorp.com

Sto products are intended for use by qualified professional contractors, not consumers, as a component of a larger construction assembly as specified by a qualified design professional, general contractor or builder. They should be installed in accordance with those specifications and Sto's instructions. Sto Corp. disclaims all, and assumes no, liability for on-site inspections, for its products applied improperly, or by unqualified persons or entities, or as part of an improperly designed or constructed building, for the nonperformance of adjacent building components or assemblies, or for other construction activities beyond Sto's control. Improper use of Sto products or use as part of an improperly designed or constructed larger assembly or building may result in serious damage to Sto products, and to the structure of the building or its components.

STO CORP. DISCLAIMS ALL WARRANTIES EXPRESSED OR IMPLIED EXCEPT FOR EXPLICIT LIMITED WRITTEN WARRANTIES ISSUED TO AND ACCEPTED BY BUILDING OWNERS IN ACCORDANCE WITH STO'S WARRANTY PROGRAMS WHICH ARE SUBJECT TO CHANGE FROM TIME TO TIME. For the fullest, most current information on proper application, clean-up, mixing and other specifications and warranties, cautions and disclaimers, please refer to the Sto Corp. website, www.stocorp.com.



StoCast Brick over StoTherm® ci Brick Corbel at Parapet and Brick Band

Detail No.: 58s.60 SCB

Date: December 2025

Page 2 of 3

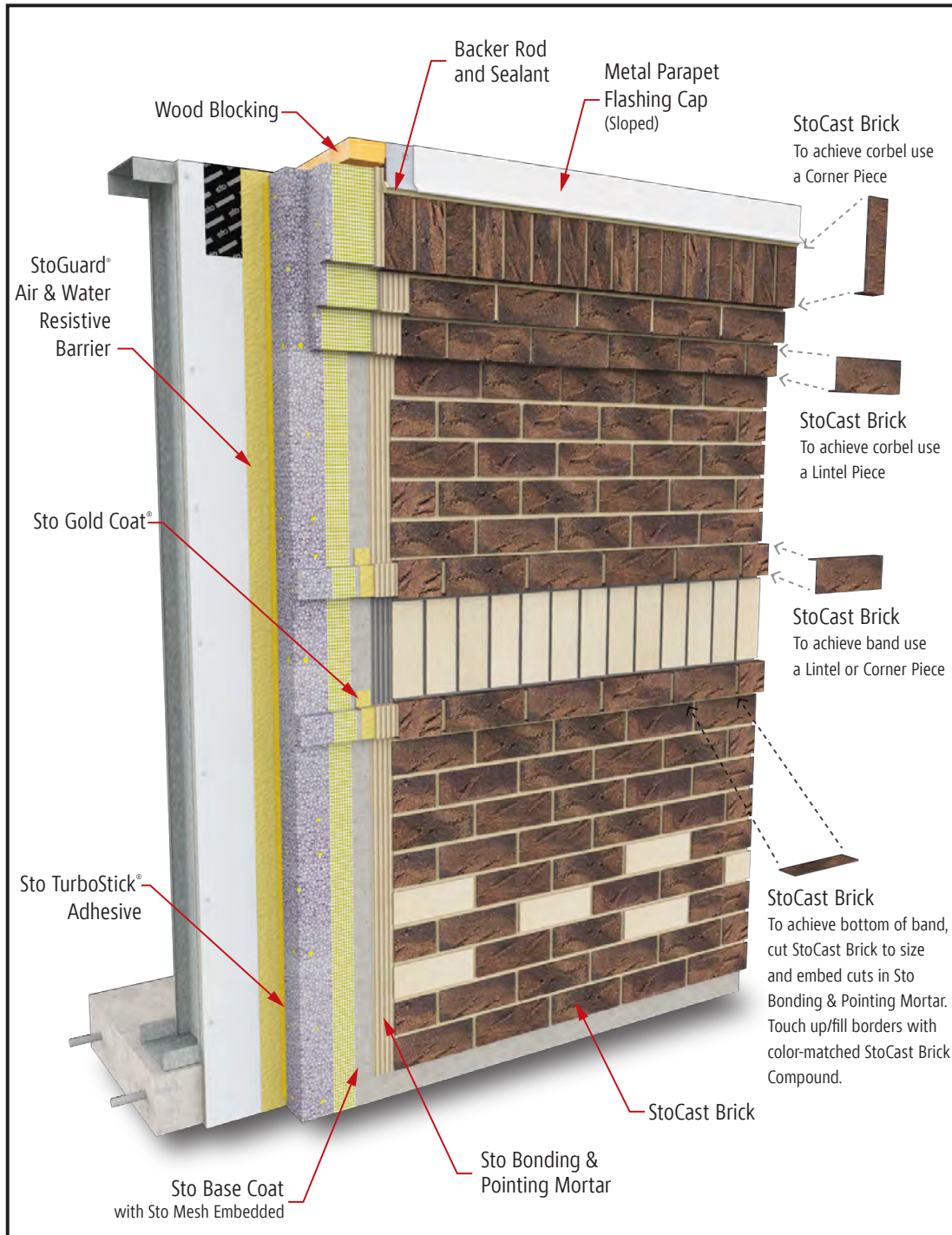

Notes:

1. External features, such as sills, quoins, etc., must be sloped a minimum of 15° degrees for widths greater than 1"(25mm), up to a maximum of 4"(102mm). For widths 1"(25mm) or less, slope the top surface to direct water to the exterior.

2. Refer to applicable StoTherm® ci Design Guide and Detail Booklets for general design guidance, use, and limitations associated with StoTherm® ci Systems. Refer to applicable Product Bulletins for information on product use, handling, and limitations associated with specific products. Refer to Safety Data Sheets for health and safety information.

3. Components not identified as Sto are furnished by other manufacturers and are not necessarily installed by trades who install the Sto products. Refer to project specific contract documents.

ATTENTION

Property of Sto Corp. All Rights Reserved.

www.stocorp.com

Sto products are intended for use by qualified professional contractors, not consumers, as a component of a larger construction assembly as specified by a qualified design professional, general contractor or builder. They should be installed in accordance with those specifications and Sto's instructions. Sto Corp. disclaims all, and assumes no, liability for on-site inspections, for its products applied improperly, or by unqualified persons or entities, or as part of an improperly designed or constructed building, for the nonperformance of adjacent building components or assemblies, or for other construction activities beyond Sto's control. Improper use of Sto products or use as part of an improperly designed or constructed larger assembly or building may result in serious damage to Sto products, and to the structure of the building or its components.

STO CORP. DISCLAIMS ALL WARRANTIES EXPRESSED OR IMPLIED EXCEPT FOR EXPLICIT LIMITED WRITTEN WARRANTIES ISSUED TO AND ACCEPTED BY BUILDING OWNERS IN ACCORDANCE WITH STO'S WARRANTY PROGRAMS WHICH ARE SUBJECT TO CHANGE FROM TIME TO TIME. For the fullest, most current information on proper application, clean-up, mixing and other specifications and warranties, cautions and disclaimers, please refer to the Sto Corp. website, www.stocorp.com.



StoCast Brick over StoTherm®ci Brick Corbel at Parapet and Brick Band

Detail No.: 58s.60 SCB

Date: December 2025

Page 3 of 3



Inset 1
Bottom Side of Cornice

Notes:

1. External features, such as sills, quoins, etc., must be sloped a minimum of 15° degrees for widths greater than 1"(25mm), up to a maximum of 4"(102mm). For widths 1"(25mm) or less, slope the top surface to direct water to the exterior.

2. Refer to applicable StoTherm® ci Design Guide and Detail Booklets for general design guidance, use, and limitations associated with StoTherm® ci Systems. Refer to applicable Product Bulletins for information on product use, handling, and limitations associated with specific products. Refer to Safety Data Sheets for health and safety information.

3. Components not identified as Sto are furnished by other manufacturers and are not necessarily installed by trades who install the Sto products. Refer to project specific contract documents.

ATTENTION

Property of Sto Corp. All Rights Reserved.

Sto products are intended for use by qualified professional contractors, not consumers, as a component of a larger construction assembly as specified by a qualified design professional, general contractor or builder. They should be installed in accordance with those specifications and Sto's instructions. Sto Corp. disclaims all, and assumes no, liability for on-site inspections, for its products applied improperly, or by unqualified persons or entities, or as part of an improperly designed or constructed building, for the nonperformance of adjacent building components or assemblies, or for other construction activities beyond Sto's control. Improper use of Sto products or use as part of an improperly designed or constructed larger assembly or building may result in serious damage to Sto products, and to the structure of the building or its components.

STO CORP. DISCLAIMS ALL WARRANTIES EXPRESSED OR IMPLIED EXCEPT FOR EXPLICIT LIMITED WRITTEN WARRANTIES ISSUED TO AND ACCEPTED BY BUILDING OWNERS IN ACCORDANCE WITH STO'S WARRANTY PROGRAMS WHICH ARE SUBJECT TO CHANGE FROM TIME TO TIME. For the fullest, most current information on proper application, clean-up, mixing and other specifications and warranties, cautions and disclaimers, please refer to the Sto Corp. website, www.stocorp.com.

www.stocorp.com

