

# StoTherm® ci XPS Floor Line With Deflection - No Drainage at Floor Line

Detail No.: 53s.41B  
Date: January 2017

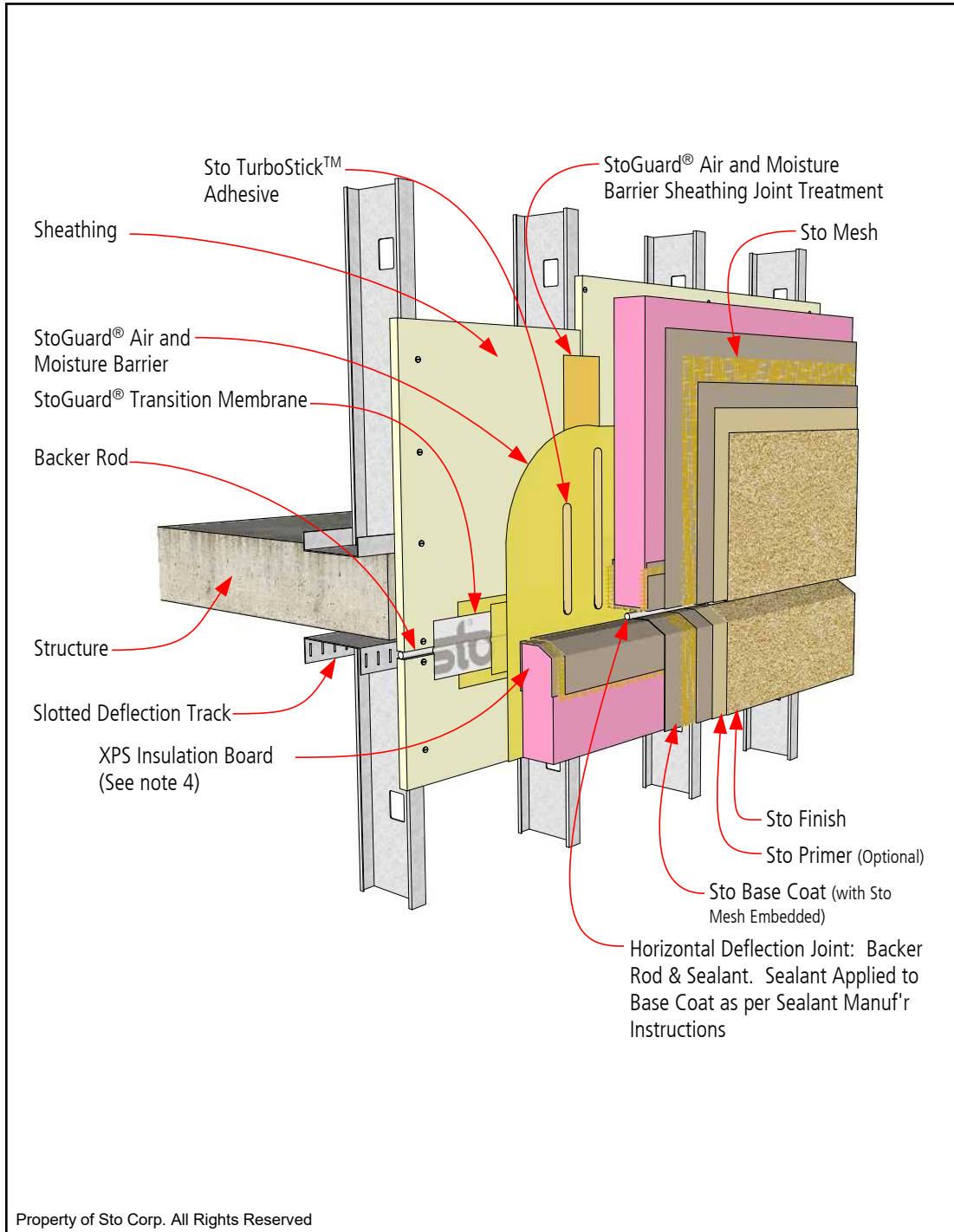

**Notes:**

1. Sheathing attachment is typically at 8" (20.3 cm) on center or less vertically. Add C-channels or other attachment means along slab edge if necessary to conform with required fastener spacing.
2. Provide fire stopping at floor line as needed.
3. Provide drainage at floor lines as deemed by design professional, typically no more than every third floor line. Refer to Sto Detail 53s.41A.
4. XPS insulation options:  
-Owens Corning Foamular®  
-CI-C Extruded Polystyrene  
-Dow STYROFOAM™ Panel  
Core 20 Extruded Polystyrene

**IMPORTANT:** Components not identified as Sto are furnished by other manufacturers and are not necessarily installed by trades who install Sto products. Refer to project specific contract documents.

Property of Sto Corp. All Rights Reserved

## ATTENTION

Sto products are intended for use by qualified professional contractors, not consumers, as a component of a larger construction assembly as specified by a qualified design professional, general contractor or builder. They should be installed in accordance with those specifications and Sto's instructions. Sto Corp. disclaims all, and assumes no, liability for on-site inspections, for its products applied improperly, or by unqualified persons or entities, or as part of an improperly designed or constructed building, for the nonperformance of adjacent building components or assemblies, or for other construction activities beyond Sto's control. Improper use of Sto products or use as part of an improperly designed or constructed larger assembly or building may result in serious damage to Sto products, and to the structure of the building or its components.

**STO CORP. DISCLAIMS ALL WARRANTIES EXPRESSED OR IMPLIED EXCEPT FOR EXPLICIT LIMITED WRITTEN WARRANTIES ISSUED TO AND ACCEPTED BY BUILDING OWNERS IN ACCORDANCE WITH STO'S WARRANTY PROGRAMS WHICH ARE SUBJECT TO CHANGE FROM TIME TO TIME.** For the fullest, most current information on proper application, clean-up, mixing and other specifications and warranties, cautions and disclaimers, please refer to the Sto Corp. website, [www.stocorp.com](http://www.stocorp.com).

[www.stocorp.com](http://www.stocorp.com)

