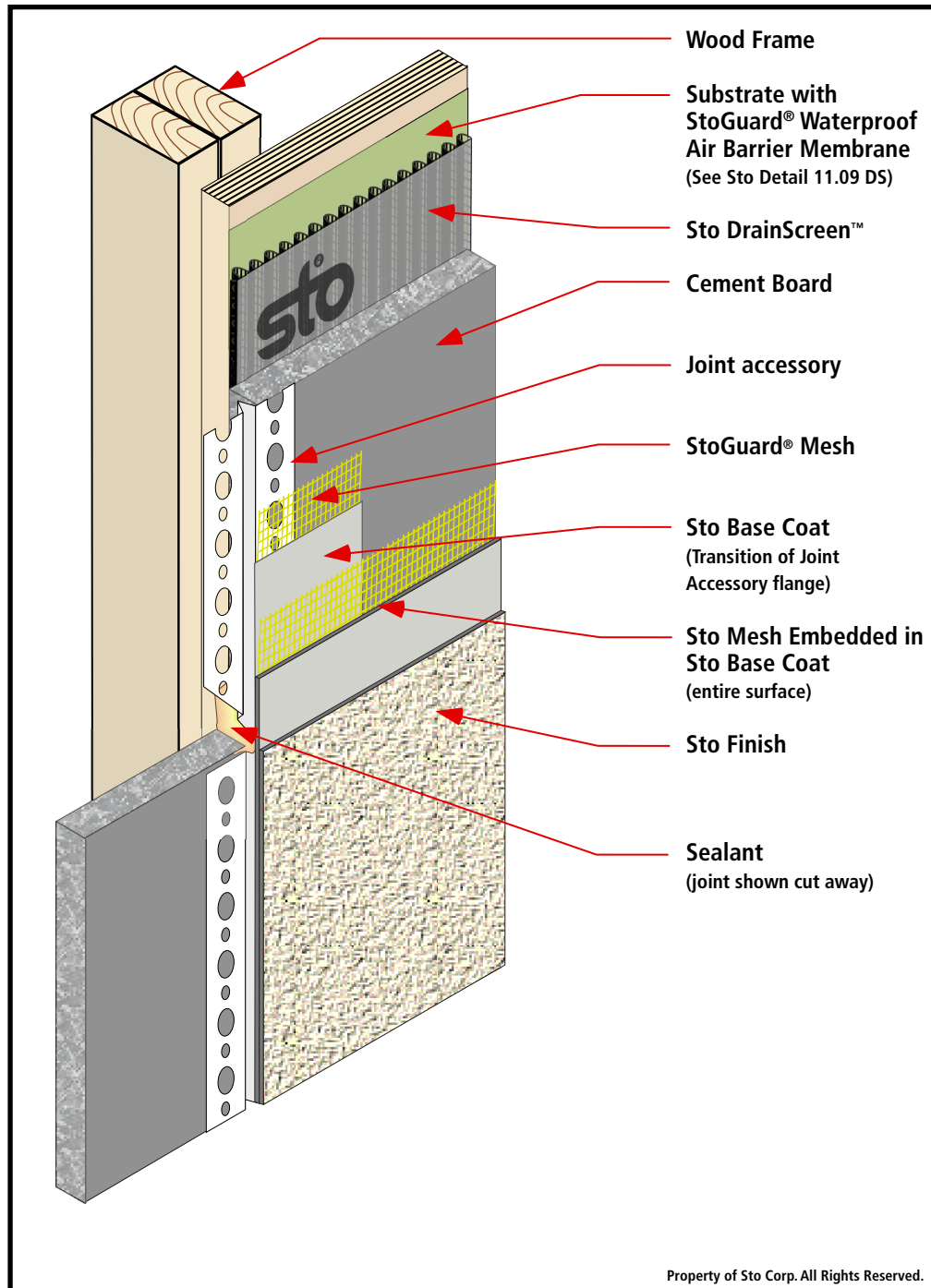

# StoQuik® Silver DrainScreen™ Control Joint Accessory (Face Mount)

Date: January 2015

**Notes:**

1. Use Control Joint Accessory in the field of the wall to accommodate thermal movement.
2. Use at intervals of 25 feet (7.6 m) maximum with light colored finishes (Lightness Value  $\geq 50$ ). Use at intervals of 16 feet (4.9 m) maximum with dark colored finishes (Lightness Value  $\leq 50$  and  $\geq 30$ ). When laying out control joints create rectangular panels of maximum 625 square feet (58 m<sup>2</sup>) with length to width ratio of 2-1/2 to 1 maximum for light colored finishes. For dark colored finishes create panels of maximum 256 square feet (23.5 m<sup>2</sup>) with length to width ratio of 2-1/2 to 1 maximum.
3. Cement board must be interrupted to accommodate control joint accessory, provide solid support for attachment of cement board: double studs, a "scab stud", or solid sheathing such as OSB or plywood.
4. Use spray adhesive (3M Super 77 or Super 90) applied to the cement board to temporarily hold the accessory in place. Place StoGuard Mesh over perforated front flange of accessory. Skim coat StoGuard Mesh with Sto base coat and allow to dry. When installing Sto Mesh, embed Sto Mesh in Sto base coat and overlap StoGuard Mesh to terminating bead of accessory.
5. Refer to Sto Specification QS 200 DS for complete information on design requirements, installation and accessories.

IMPORTANT: Components not identified as Sto are furnished by other manufacturers and are not necessarily installed by trades who install the Sto products. Refer to project specific contract documents.

**ATTENTION**

Sto products are intended for use by qualified professional contractors, not consumers, as a component of a larger construction assembly as specified by a qualified design professional, general contractor or builder. They should be installed in accordance with those specifications and Sto's instructions. Sto Corp. disclaims all, and assumes no, liability for on-site inspections, for its products applied improperly, or by unqualified persons or entities, or as part of an improperly designed or constructed building, for the nonperformance of adjacent building components or assemblies, or for other construction activities beyond Sto's control. Improper use of Sto products or use as part of an improperly designed or constructed larger assembly or building may result in serious damage to Sto products, and to the structure of the building or its components.

STO CORP. DISCLAIMS ALL WARRANTIES EXPRESSED OR IMPLIED EXCEPT FOR EXPLICIT LIMITED WRITTEN WARRANTIES ISSUED TO AND ACCEPTED BY BUILDING OWNERS IN ACCORDANCE WITH STO'S WARRANTY PROGRAMS WHICH ARE SUBJECT TO CHANGE FROM TIME TO TIME. For the fullest, most current information on proper application, clean-up, mixing and other specifications and warranties, cautions and disclaimers, please refer to the Sto Corp. website, [www.stocorp.com](http://www.stocorp.com).

[www.stocorp.com](http://www.stocorp.com)