

# StoEnergy Guard™ Masonry Veneer on Steel Stud Backup Window Head – Partial View Showing Terminations

Detail No.: 61s.36

Date: July 2012

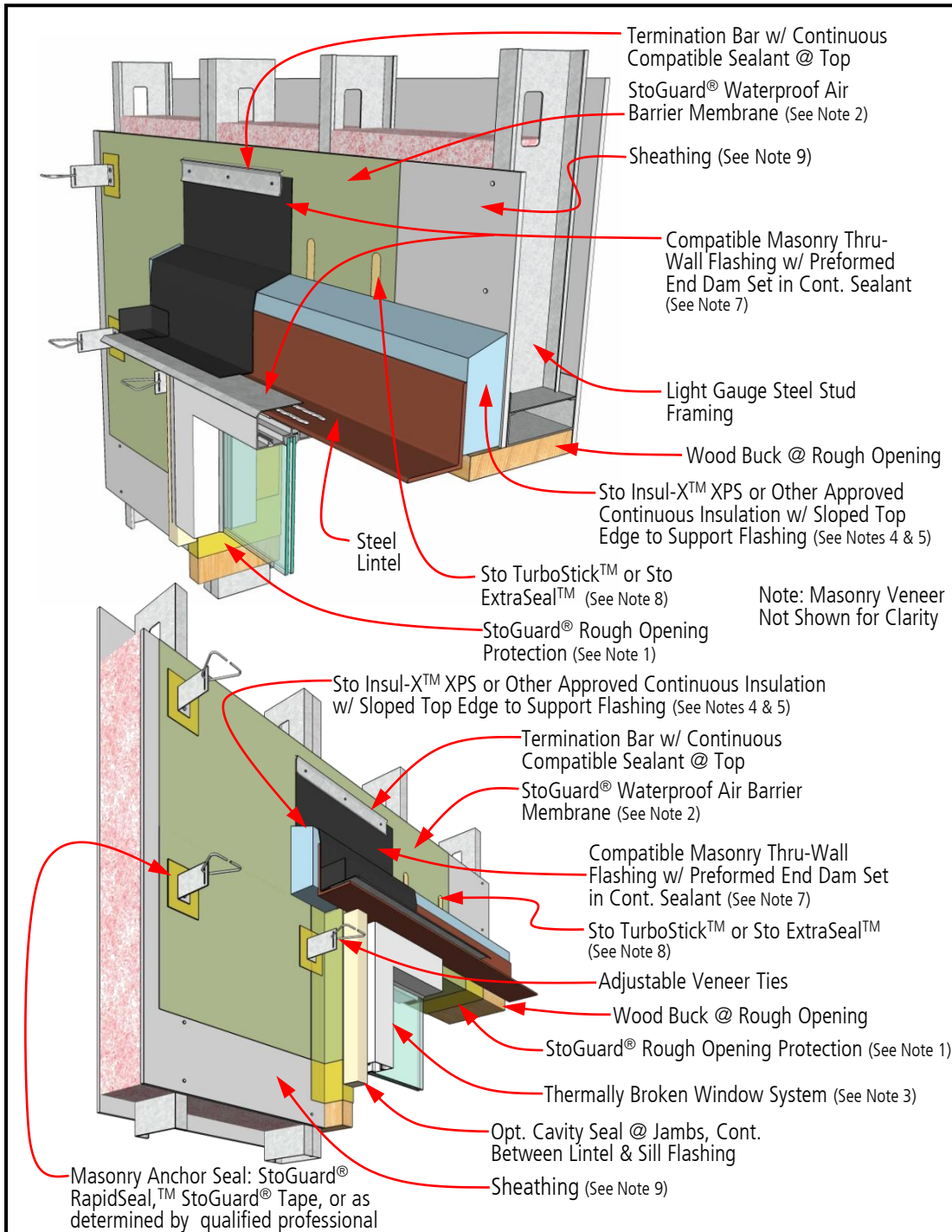

## Notes:

### 1. StoGuard® Rough Opening Protection Options:

- StoGuard® RapidSeal™ (preferred)
- Sto Gold Fill® with StoGuard® Mesh
- StoGuard® Fabric with StoGuard® Waterproof Air Barrier Membrane
- StoGuard® Tape

### 2. StoGuard® Waterproof Air Barrier Membrane Options:

- Sto Gold Coat® (vapor permeable)
- Sto EmeraldCoat® (high perm)
- Sto VaporSeal™ (vapor impermeable)
- Sto AirSeal™ (high perm)

3. Alignment of window thermal break relative to wall assembly thermal control layer to be determined by qualified professional

4. Insulation type and location relative to assembly components to be determined by qualified professional.

5. Continuous foam plastic insulation must be approved and in conformance with IRC Section 316 or IBC Chapter 26, depending on construction type (note required fire tests for use on noncombustible construction).

6. Refer to Sto specifications and product bulletins for detailed information on substrates and Sto material options.

7. Thru-Wall Flashing Type to be determined by qualified professional.

8. As an alternative to Sto TurboStick™ or Sto ExtraSeal™ to adhesively fasten Sto Insul-X™ attach with sufficient cap/disc fasteners to secure prior to cladding attachment. Sto TurboStick™ or Sto ExtraSeal™ when installed as vertical ribbons also function as a drainage space.

9. Glass mat gypsum sheathing in compliance with ASTM C 1177, Typ.

**IMPORTANT: Components not identified as Sto are furnished by other manufacturers and are not necessarily installed by trades who install the Sto products. Refer to project specific contract documents.**

## ATTENTION

Property of Sto Corp. All Rights Reserved.

[www.stocorp.com](http://www.stocorp.com)

Sto products are intended for use by qualified professional contractors, not consumers, as a component of a larger construction assembly as specified by a qualified design professional, general contractor or builder. They should be installed in accordance with those specifications and Sto's instructions. Sto Corp. disclaims all, and assumes no, liability for on-site inspections, for its products applied improperly, or by unqualified persons or entities, or as part of an improperly designed or constructed building, for the nonperformance of adjacent building components or assemblies, or for other construction activities beyond Sto's control. Improper use of Sto products or use as part of an improperly designed or constructed larger assembly or building may result in serious damage to Sto products, and to the structure of the building or its components.

STO CORP. DISCLAIMS ALL WARRANTIES EXPRESSED OR IMPLIED EXCEPT FOR EXPLICIT LIMITED WRITTEN WARRANTIES ISSUED TO AND ACCEPTED BY BUILDING OWNERS IN ACCORDANCE WITH STO'S WARRANTY PROGRAMS WHICH ARE SUBJECT TO CHANGE FROM TIME TO TIME. For the fullest, most current information on proper application, clean-up, mixing and other specifications and warranties, cautions and disclaimers, please refer to the Sto Corp. website, [www.stocorp.com](http://www.stocorp.com).