

StoEnergy Guard™

Masonry Veneer on Steel Stud Backup, Window Sill

Fire Protection – Multi-story Noncombustible Type Construction (NFPA 285 Compliant)

Detail No.: 61s.31FP

Date: September 2012

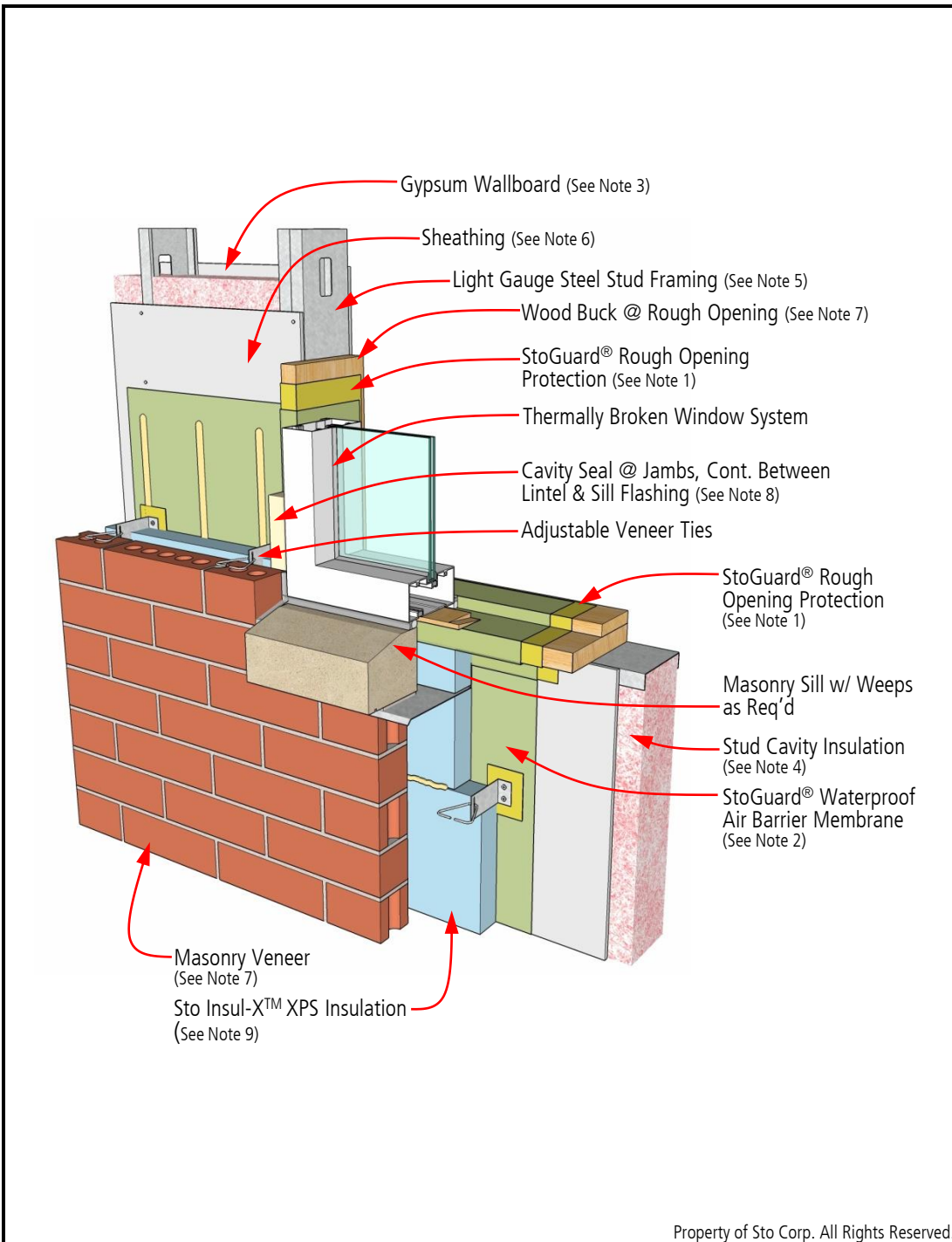

Notes:

For assemblies in compliance with acceptance criteria of NFPA 285 the following material requirements apply. Also refer to IBC Chapter 26 for other requirements that may apply.

- StoGuard® Rough Opening Protection Options:**
 - Sto Gold Fill® with StoGuard® Mesh
 - StoGuard® Fabric with StoGuard® Waterproof Air Barrier Membrane
- StoGuard® Waterproof Air Barrier Membrane Options:**
 - Sto Gold Coat® (vapor permeable)
 - Sto EmeraldCoat® (high perm)
 - Sto ExtraSeal™ (high perm)
- Interior: minimum 1 layer 5/8 inch Type X gypsum wallboard.
- Stud Cavity Insulation: none, or any noncombustible insulation, faced or unfaced if batt insulation.
- Steel Stud Backup: minimum 3-5/8 inch depth, minimum 18 gage, maximum 16 inches on center.
- Exterior Sheathing: minimum 5/8" glass mat faced gypsum sheathing in compliance with ASTM C 1177. Joints treated with StoGuard® joint treatment.
- Wood Buck: Fire Retardant Treated 2X solid wood blocking, without joints, length or width.
- Cavity Seal at Jamb: required, Dow Great Stuff Pro Gaps and Cracks single component insulating foam sealant (install over polypropylene backer rod to control expansion).
- Continuous Insulation: Sto Insul-X™ Type IV XPS, maximum 3 inches thick.
- Cavity: comply with ICC requirements for cavity depth.
- Brick Veneer: standard nominal 4 inch thick or greater, clay brick, installed with anchors maximum 24 inches on center each stud.
- Final assembly subject to review and approval by qualified design professional.

IMPORTANT: Components not identified as Sto are furnished by other manufacturers and are not necessarily installed by trades who install the Sto products. Refer to project specific contract documents.

ATTENTION

Sto products are intended for use by qualified professional contractors, not consumers, as a component of a larger construction assembly as specified by a qualified design professional, general contractor or builder. They should be installed in accordance with those specifications and Sto's instructions. Sto Corp. disclaims all, and assumes no, liability for on-site inspections, for its products applied improperly, or by unqualified persons or entities, or as part of an improperly designed or constructed building, for the nonperformance of adjacent building components or assemblies, or for other construction activities beyond Sto's control. Improper use of Sto products or use as part of an improperly designed or constructed larger assembly or building may result in serious damage to Sto products, and to the structure of the building or its components.

STO CORP. DISCLAIMS ALL WARRANTIES EXPRESSED OR IMPLIED EXCEPT FOR EXPLICIT LIMITED WRITTEN WARRANTIES ISSUED TO AND ACCEPTED BY BUILDING OWNERS IN ACCORDANCE WITH STO'S WARRANTY PROGRAMS WHICH ARE SUBJECT TO CHANGE FROM TIME TO TIME. For the fullest, most current information on proper application, clean-up, mixing and other specifications and warranties, cautions and disclaimers, please refer to the Sto Corp. website, www.stocorp.com.

www.stocorp.com