

StoEnergy Guard™

Frame Construction: Portland Cement Stucco

Detail No.: 60w.01
Date: September 2011

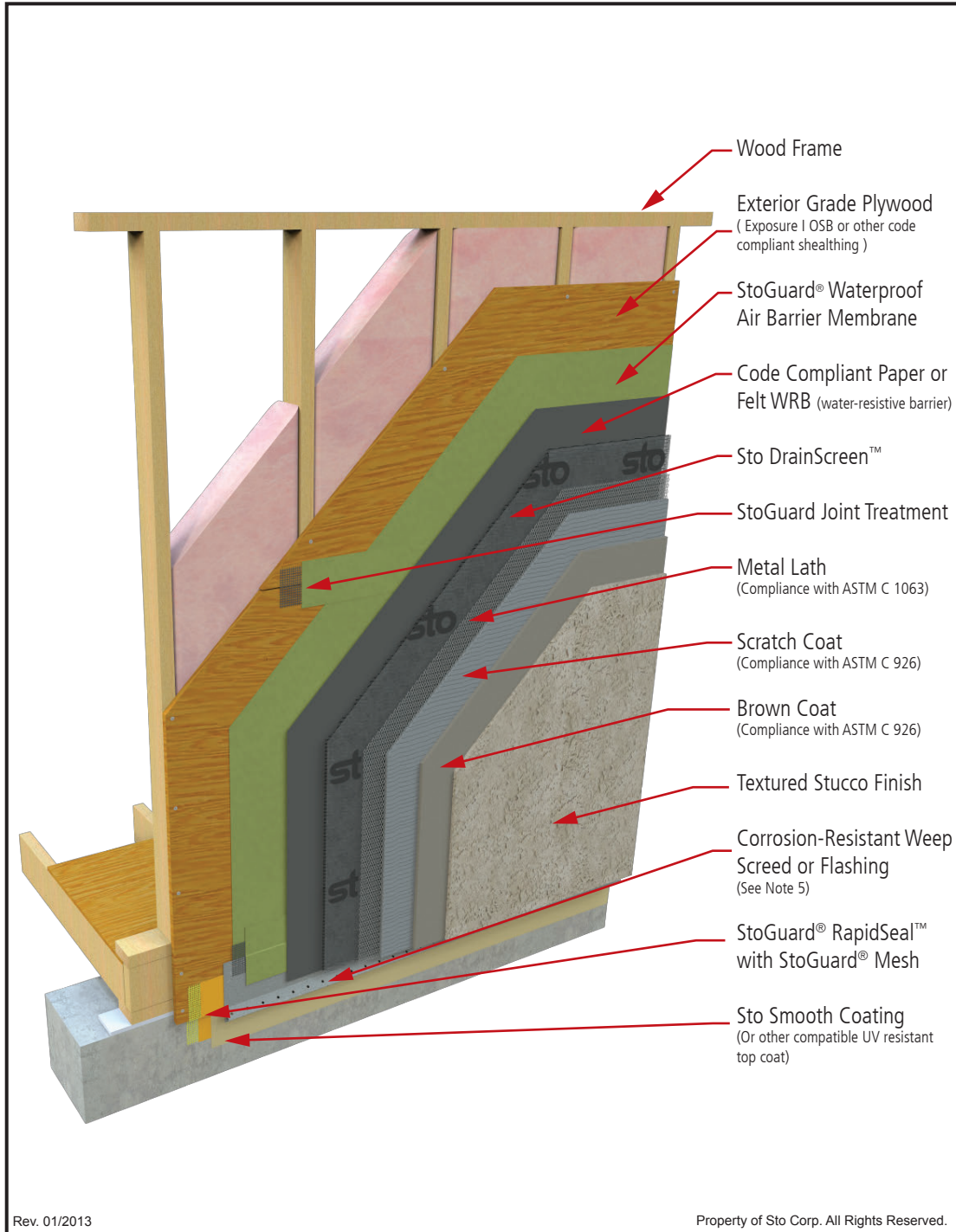

Notes:

- StoGuard® joint treatment options:
 - StoGuard® RapidSeal® with StoGuard® Mesh (joints ≤ 1/4 inch [6 mm])
 - Sto Gold Fill® with StoGuard® Mesh (joints ≤ 1/8 inch [3 mm])
 - StoGuard® Fabric with StoGuard® waterproof air barrier membrane (joints ≤ 1/8 inch [3 mm])
- StoGuard® waterproof air barrier membrane options:
 - Sto Gold Coat® (vapor permeable)
 - Sto EmeraldCoat® (high perm)
 - Sto VaporSeal™ (vapor impermeable)
 - Sto AirSeal™ (high perm) (Not for use with Sto Guard Fabric)
- Water-Resistive Barrier: Minimum #15 grade D building paper. Use minimum 60 minute grade D paper when backed with Sto AirSeal™ or StoGuard VaporSeal™ on wood-based sheathing.
- Refer to product bulletins for complete information on Sto products. Refer to StoGuard® Waterproof Air Barrier detail series 20.XX for information on detailing with StoGuard®.
- Cladding termination minimum 4" (101 mm) above finish grade, minimum 2" (51mm) above paved surfaces.

IMPORTANT: Components not identified as Sto are furnished by other manufacturers and are not necessarily installed by trades who install the Sto products. Refer to project specific contract documents.

Rev. 01/2013

Property of Sto Corp. All Rights Reserved.

www.stocorp.com

ATTENTION

Sto products are intended for use by qualified professional contractors, not consumers, as a component of a larger construction assembly as specified by a qualified design professional, general contractor or builder. They should be installed in accordance with those specifications and Sto's instructions. Sto Corp. disclaims all, and assumes no, liability for on-site inspections, for its products applied improperly, or by unqualified persons or entities, or as part of an improperly designed or constructed building, for the nonperformance of adjacent building components or assemblies, or for other construction activities beyond Sto's control. Improper use of Sto products or use as part of an improperly designed or constructed larger assembly or building may result in serious damage to Sto products, and to the structure of the building or its components.

STO CORP. DISCLAIMS ALL WARRANTIES EXPRESSED OR IMPLIED EXCEPT FOR EXPLICIT LIMITED WRITTEN WARRANTIES ISSUED TO AND ACCEPTED BY BUILDING OWNERS IN ACCORDANCE WITH STO'S WARRANTY PROGRAMS WHICH ARE SUBJECT TO CHANGE FROM TIME TO TIME. For the fullest, most current information on proper application, clean-up, mixing and other specifications and warranties, cautions and disclaimers, please refer to the Sto Corp. website, www.stocorp.com.

StoEnergy Guard™

Frame Construction: Acrylic Finish over Cement Board

Detail No.: 60w.02
Date: September 2011

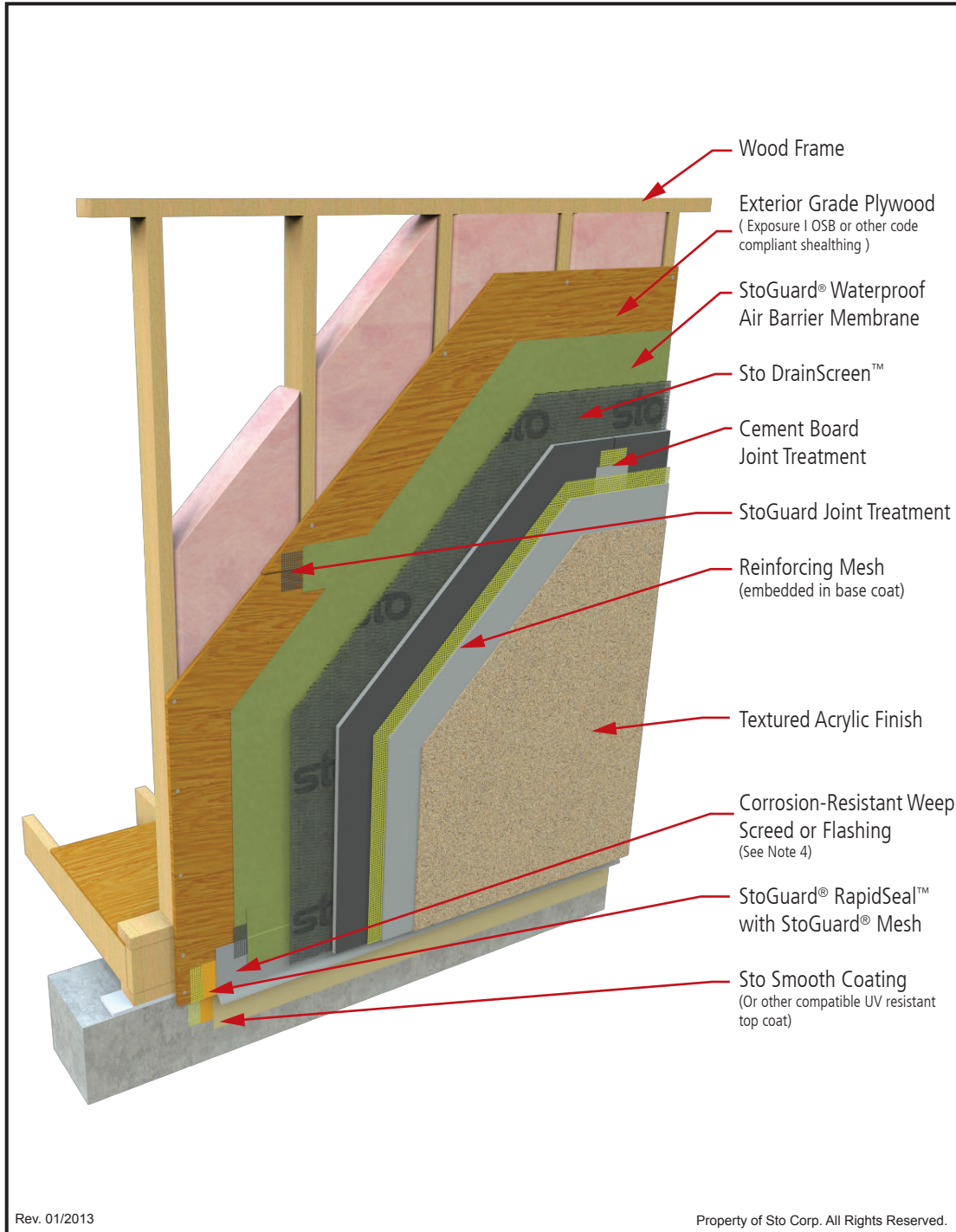

Notes:

- StoGuard® joint treatment options:
 - StoGuard® RapidSeal® with StoGuard® Mesh (joints ≤ 1/4 inch [6 mm])
 - Sto Gold Fill® with StoGuard® Mesh (joints ≤ 1/8 inch [3 mm])
 - StoGuard® Fabric with StoGuard® waterproof air barrier membrane (joints ≤ 1/8 inch [3 mm])
- StoGuard® waterproof air barrier membrane options:
 - Sto Gold Coat® (vapor permeable)
 - Sto EmeraldCoat® (high perm)
- Refer to product bulletins for complete information on Sto products. Refer to StoGuard® Waterproof Air Barrier detail series 20.XX for information on detailing with StoGuard®.
- Cladding termination minimum 4" (101 mm) above finish grade, minimum 2" (51mm) above paved surfaces.
- Refer to manufacturer's instructions and ICC ES Report for code compliant materials and installation of cement board finish system.

IMPORTANT: Components not identified as Sto are furnished by other manufacturers and are not necessarily installed by trades who install the Sto products. Refer to project specific contract documents.

www.stocorp.com

ATTENTION

Sto products are intended for use by qualified professional contractors, not consumers, as a component of a larger construction assembly as specified by a qualified design professional, general contractor or builder. They should be installed in accordance with those specifications and Sto's instructions. Sto Corp. disclaims all, and assumes no, liability for on-site inspections, for its products applied improperly, or by unqualified persons or entities, or as part of an improperly designed or constructed building, for the nonperformance of adjacent building components or assemblies, or for other construction activities beyond Sto's control. Improper use of Sto products or use as part of an improperly designed or constructed larger assembly or building may result in serious damage to Sto products, and to the structure of the building or its components.

STO CORP. DISCLAIMS ALL WARRANTIES EXPRESSED OR IMPLIED EXCEPT FOR EXPLICIT LIMITED WRITTEN WARRANTIES ISSUED TO AND ACCEPTED BY BUILDING OWNERS IN ACCORDANCE WITH STO'S WARRANTY PROGRAMS WHICH ARE SUBJECT TO CHANGE FROM TIME TO TIME. For the fullest, most current information on proper application, clean-up, mixing and other specifications and warranties, cautions and disclaimers, please refer to the Sto Corp. website, www.stocorp.com.

StoEnergy Guard™

Frame Construction: Adhered Masonry Veneer (Thin) over Cement Board

Detail No.: 60w.03
Date: September 2011

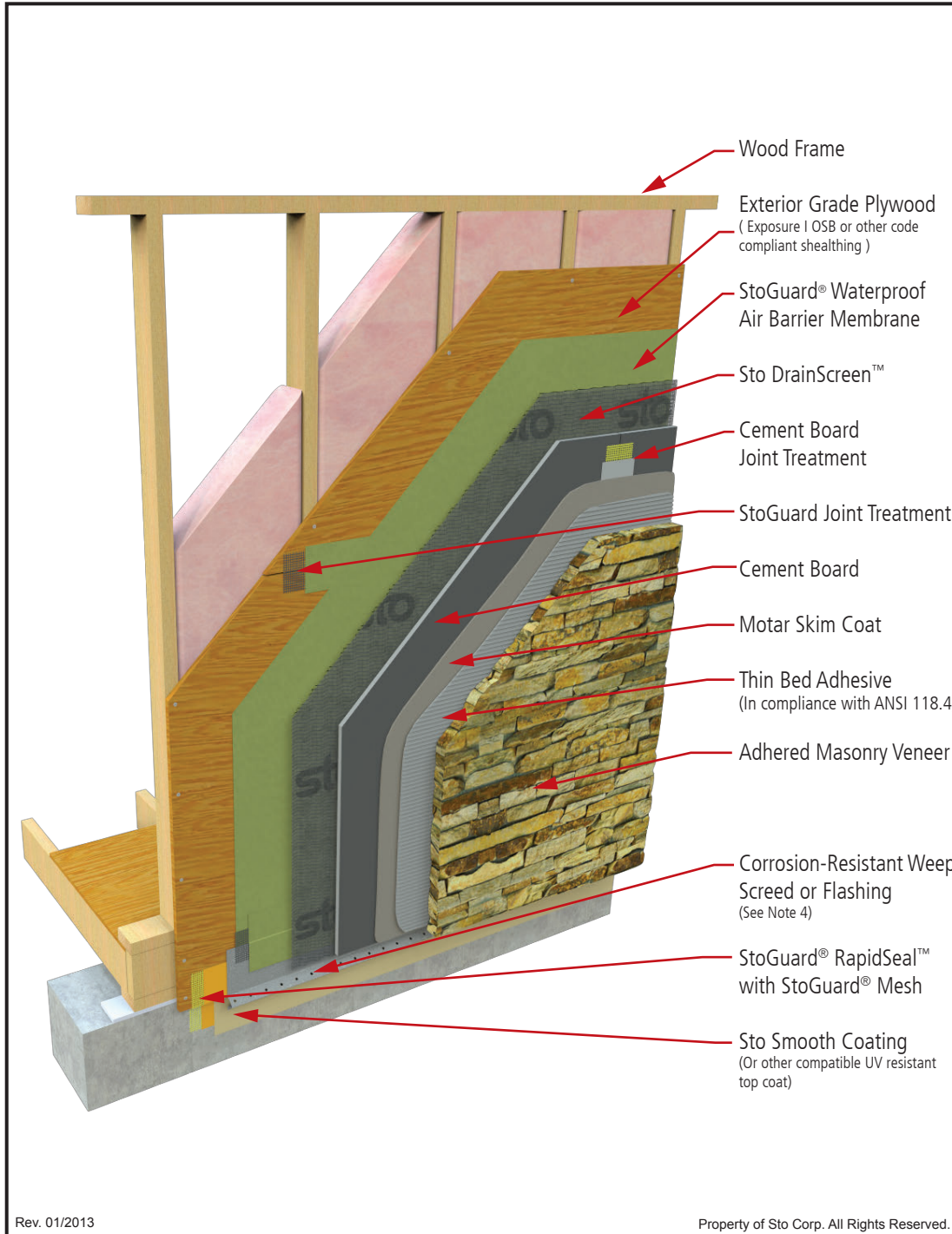

Notes:

- StoGuard® joint treatment options:
 - StoGuard® RapidSeal® with StoGuard® Mesh (joints ≤ 1/4 inch [6 mm])
 - Sto Gold Fill® with StoGuard® Mesh (joints ≤ 1/8 inch [3 mm])
 - StoGuard® Fabric with StoGuard® waterproof air barrier membrane (joints ≤ 1/8 inch [3 mm])
- StoGuard® waterproof air barrier membrane options:
 - Sto Gold Coat® (vapor permeable)
 - Sto EmeraldCoat® (high perm)
- Refer to product bulletins for complete information on Sto products. Refer to StoGuard® Waterproof Air Barrier detail series 20.XX for information on detailing with StoGuard®.
- Cladding termination minimum 4" (101 mm) above finish grade, minimum 2" (51mm) above paved surfaces.
- Refer to cement board and adhered masonry veneer manufacturer's instructions and sections 6.1 and 6.3 of TMS 402 ACI 530/ASCE 5 for code compliant materials and installation of adhered masonry veneer.

IMPORTANT: Components not identified as Sto are furnished by other manufacturers and are not necessarily installed by trades who install the Sto products. Refer to project specific contract documents.

Rev. 01/2013

Property of Sto Corp. All Rights Reserved.

www.stocorp.com

ATTENTION

Sto products are intended for use by qualified professional contractors, not consumers, as a component of a larger construction assembly as specified by a qualified design professional, general contractor or builder. They should be installed in accordance with those specifications and Sto's instructions. Sto Corp. disclaims all, and assumes no, liability for on-site inspections, for its products applied improperly, or by unqualified persons or entities, or as part of an improperly designed or constructed building, for the nonperformance of adjacent building components or assemblies, or for other construction activities beyond Sto's control. Improper use of Sto products or use as part of an improperly designed or constructed larger assembly or building may result in serious damage to Sto products, and to the structure of the building or its components.

STO CORP. DISCLAIMS ALL WARRANTIES EXPRESSED OR IMPLIED EXCEPT FOR EXPLICIT LIMITED WRITTEN WARRANTIES ISSUED TO AND ACCEPTED BY BUILDING OWNERS IN ACCORDANCE WITH STO'S WARRANTY PROGRAMS WHICH ARE SUBJECT TO CHANGE FROM TIME TO TIME. For the fullest, most current information on proper application, clean-up, mixing and other specifications and warranties, cautions and disclaimers, please refer to the Sto Corp. website, www.stocorp.com.

StoEnergy Guard™

Frame Construction: Adhered Masonry Veneer (Thick)

Detail No.: 60w.04
Date: September 2011

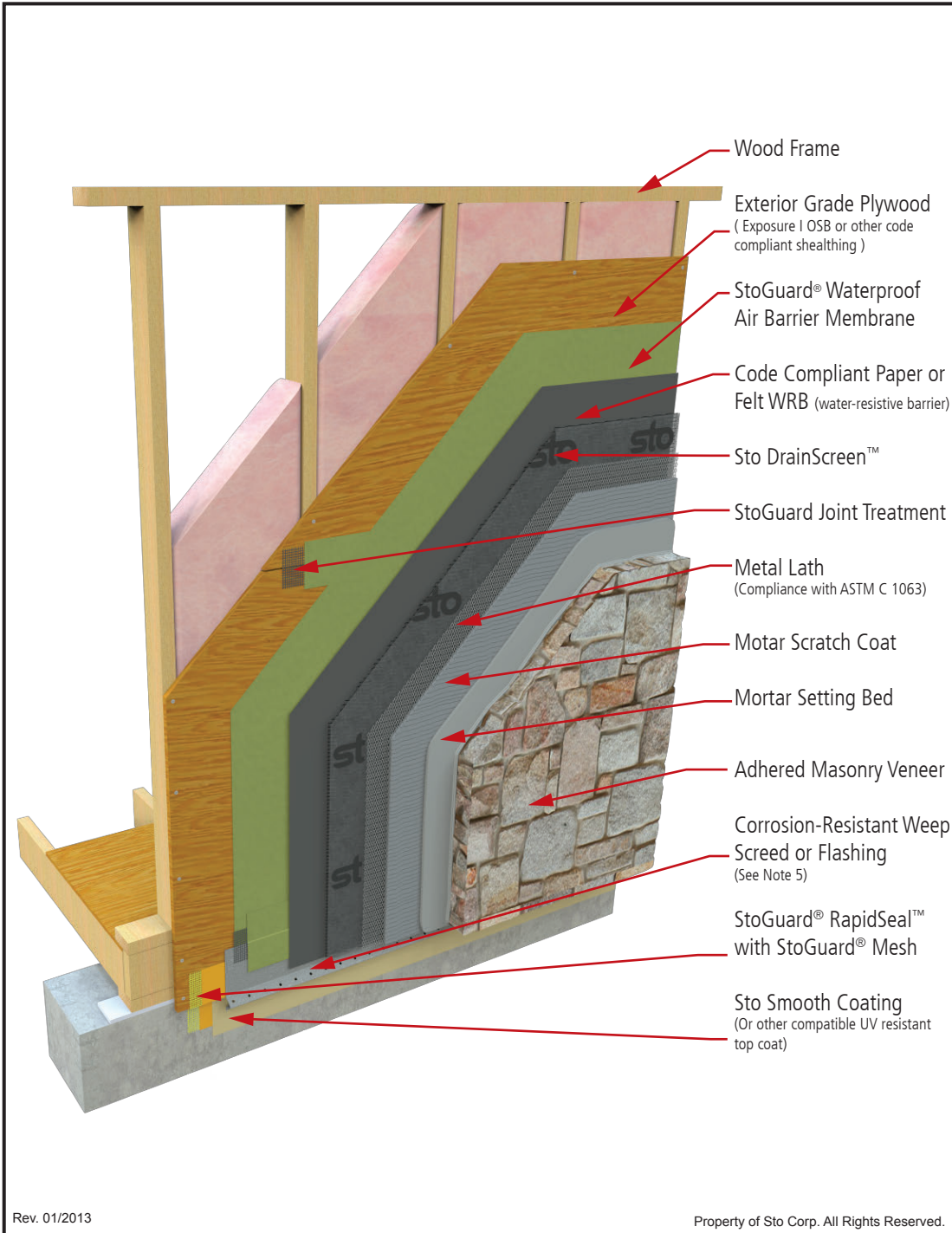

Notes:

1. StoGuard® joint treatment options:
 - a. StoGuard® RapidSeal® with StoGuard® Mesh (joints ≤ 1/4 inch [6 mm])
 - b. Sto Gold Fill® with StoGuard® Mesh (joints ≤ 1/8 inch [3 mm])
 - c. StoGuard® Fabric with StoGuard® waterproof air barrier membrane (joints ≤ 1/8 inch [3 mm])
2. StoGuard® waterproof air barrier membrane options:
 - a. Sto Gold Coat® (vapor permeable)
 - b. Sto EmeraldCoat® (high perm)
 - c. Sto VaporSeal™ (vapor impermeable)
 - d. Sto AirSeal™ (high perm) (Not for use with Sto Guard Fabric)
3. Water-Resistive Barrier: Minimum #15 grade D building paper. Use minimum 60 minute grade D paper when backed with Sto AirSeal™ or StoGuard VaporSeal™ on wood-based sheathing.
4. Refer to product bulletins for complete information on Sto products. Refer to StoGuard® Waterproof Air Barrier detail series 20.XX for information on detailing with StoGuard®.
5. Cladding termination minimum 4" (101 mm) above finish grade, minimum 2" (51mm) above paved surfaces.
6. Refer to manufacturer's instructions and sections 6.1 and 6.3 of TMS 402 ACI 530/ASCE 5 for code compliant materials and installation of adhered masonry veneer.

IMPORTANT: Components not identified as Sto are furnished by other manufacturers and are not necessarily installed by trades who install the Sto products. Refer to project specific contract documents.

Rev. 01/2013

Property of Sto Corp. All Rights Reserved.

www.stocorp.com

ATTENTION

Sto products are intended for use by qualified professional contractors, not consumers, as a component of a larger construction assembly as specified by a qualified design professional, general contractor or builder. They should be installed in accordance with those specifications and Sto's instructions. Sto Corp. disclaims all, and assumes no, liability for on-site inspections, for its products applied improperly, or by unqualified persons or entities, or as part of an improperly designed or constructed building, for the nonperformance of adjacent building components or assemblies, or for other construction activities beyond Sto's control. Improper use of Sto products or use as part of an improperly designed or constructed larger assembly or building may result in serious damage to Sto products, and to the structure of the building or its components.

STO CORP. DISCLAIMS ALL WARRANTIES EXPRESSED OR IMPLIED EXCEPT FOR EXPLICIT LIMITED WRITTEN WARRANTIES ISSUED TO AND ACCEPTED BY BUILDING OWNERS IN ACCORDANCE WITH STO'S WARRANTY PROGRAMS WHICH ARE SUBJECT TO CHANGE FROM TIME TO TIME. For the fullest, most current information on proper application, clean-up, mixing and other specifications and warranties, cautions and disclaimers, please refer to the Sto Corp. website, www.stocorp.com.