

StoShield™ SA Knee Wall

Detail No.: 24s.64

Date: May 2025

Page 1 of 2

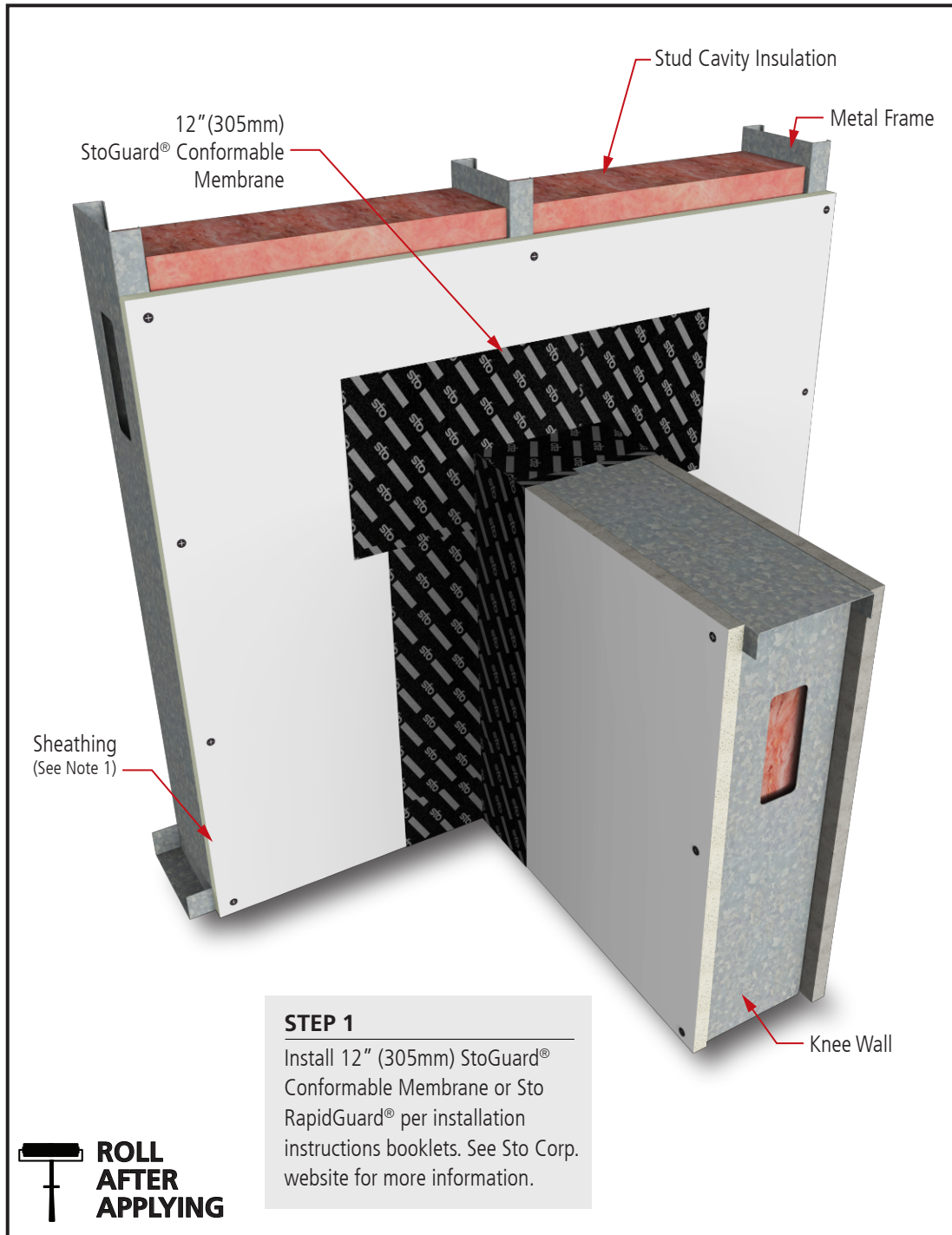

Notes:

1. Glass mat gypsum sheathing in compliance with ASTM C1177, Exterior Grade or Exposure 1 wood-based sheathing, or cementitious sheathing in compliance with ASTM C1325 Type A.

2. Apply StoShield™ SA membranes with minimum 2" (51mm) shingle laps at horizontal seams.

3. **IMPORTANT:** After StoShield™ SA membrane application is in place, immediately apply firm, uniform pressure using a hard rubber roller to create a wrinkle-free surface.

4. Components not identified as Sto are furnished by other manufacturers and are not necessarily installed by trades who install the Sto products. Refer to project specific contract documents.

5. Refer to Sto Detail No. 23s.64 in the StoGuard® Conformable Membrane Installation Guide.

ATTENTION

Property of Sto Corp. All Rights Reserved.

www.stocorp.com

Sto products are intended for use by qualified professional contractors, not consumers, as a component of a larger construction assembly as specified by a qualified design professional, general contractor or builder. They should be installed in accordance with those specifications and Sto's instructions. Sto Corp. disclaims all, and assumes no, liability for on-site inspections, for its products applied improperly, or by unqualified persons or entities, or as part of an improperly designed or constructed building, for the nonperformance of adjacent building components or assemblies, or for other construction activities beyond Sto's control. Improper use of Sto products or use as part of an improperly designed or constructed larger assembly or building may result in serious damage to Sto products, and to the structure of the building or its components.

STO CORP. DISCLAIMS ALL WARRANTIES EXPRESSED OR IMPLIED EXCEPT FOR EXPLICIT LIMITED WRITTEN WARRANTIES ISSUED TO AND ACCEPTED BY BUILDING OWNERS IN ACCORDANCE WITH STO'S WARRANTY PROGRAMS WHICH ARE SUBJECT TO CHANGE FROM TIME TO TIME. For the fullest, most current information on proper application, clean-up, mixing and other specifications and warranties, cautions and disclaimers, please refer to the Sto Corp. website, www.stocorp.com.



StoShield™ SA Knee Wall

Detail No.: 24s.64

Date: May 2025

Page 2 of 2

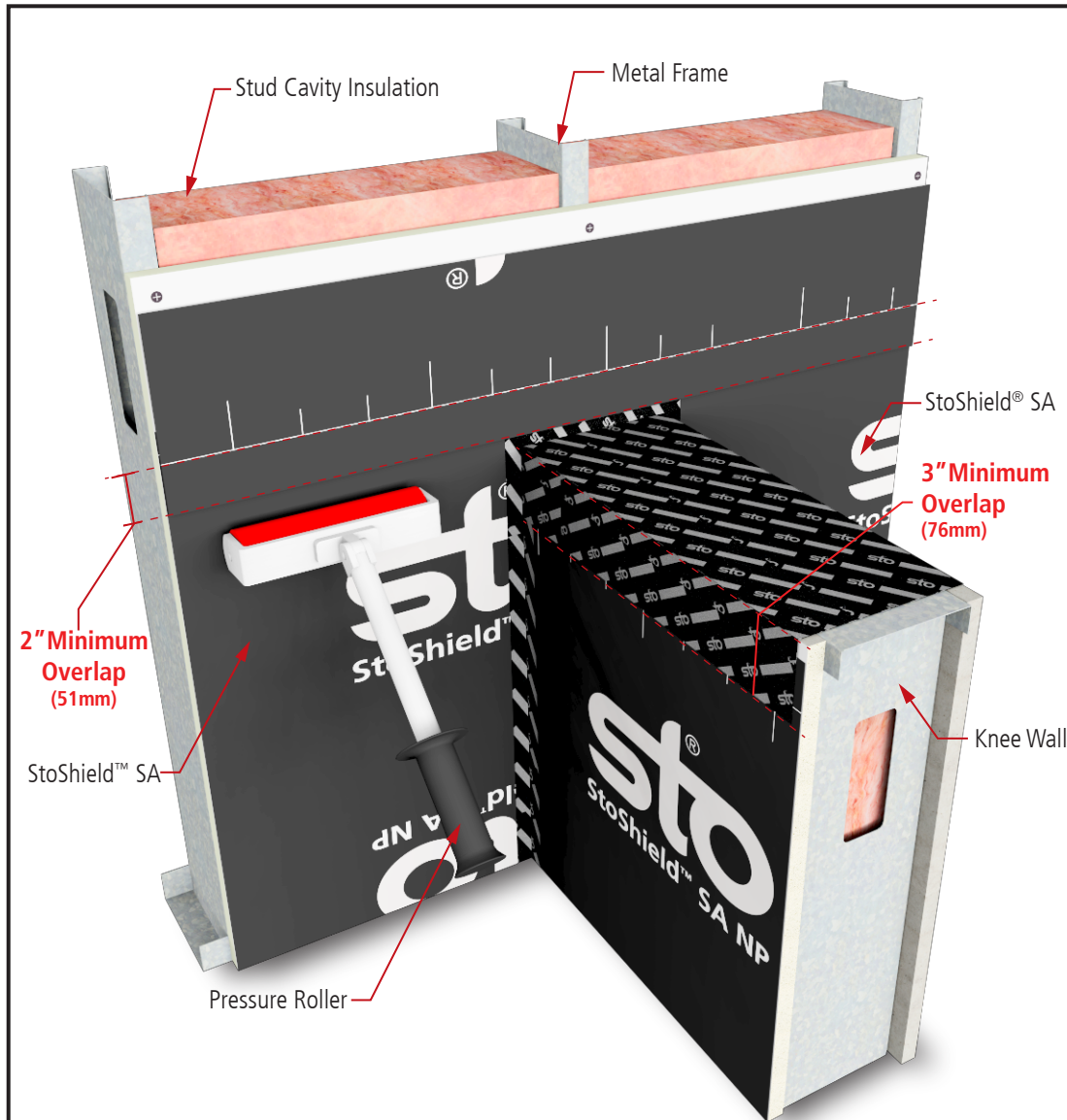

STEP 2

Install StoShield™ SA membrane beginning at the bottom of the wall, working up, shingle lapping a minimum of 2" (50mm). Shingle lap 12" (305mm) StoGuard® Conformable Membrane or Sto RapidGuard® on top of knee wall with a minimum of 3" (76mm) overlap. After placement, apply firm, uniform pressure by rolling with a hard rubber roller.



Notes:

1. Glass mat gypsum sheathing in compliance with ASTM C1177, Exterior Grade or Exposure 1 wood-based sheathing, or cementitious sheathing in compliance with ASTM C1325 Type A.

2. Apply StoShield™ SA membranes with minimum 2" (51mm) shingle laps at horizontal seams.

3. **IMPORTANT:** After StoShield™ SA membrane application is in place, immediately apply firm, uniform pressure using a hard rubber roller to create a wrinkle-free surface.

4. Components not identified as Sto are furnished by other manufacturers and are not necessarily installed by trades who install the Sto products. Refer to project specific contract documents.

5. Refer to Sto Detail No. 23s.64 in the StoGuard® Conformable Membrane Installation Guide.

ATTENTION

Property of Sto Corp. All Rights Reserved.

www.stocorp.com

Sto products are intended for use by qualified professional contractors, not consumers, as a component of a larger construction assembly as specified by a qualified design professional, general contractor or builder. They should be installed in accordance with those specifications and Sto's instructions. Sto Corp. disclaims all, and assumes no, liability for on-site inspections, for its products applied improperly, or by unqualified persons or entities, or as part of an improperly designed or constructed building, for the nonperformance of adjacent building components or assemblies, of for other construction activities beyond Sto's control. Improper use of Sto products or use as part of an improperly designed or constructed larger assembly or building may result in serious damage to Sto products, and to the structure of the building or its components.

STO CORP. DISCLAIMS ALL WARRANTIES EXPRESSED OR IMPLIED EXCEPT FOR EXPLICIT LIMITED WRITTEN WARRANTIES ISSUED TO AND ACCEPTED BY BUILDING OWNERS IN ACCORDANCE WITH STO'S WARRANTY PROGRAMS WHICH ARE SUBJECT TO CHANGE FROM TIME TO TIME. For the fullest, most current information on proper application, clean-up, mixing and other specifications and warranties, cautions and disclaimers, please refer to the Sto Corp. website, www.stocorp.com.

