

# StoGuard<sup>®</sup> Tape

80269 StoGuard Tape 6"  
80271 StoGuard Tape 9"

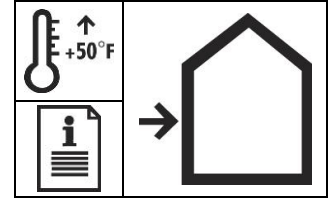

## Technical Data

DESCRIPTION	WIDTH OF ROLL	LENGTH OF ROLL	THICKNESS
StoGuard Tape 6"	6" (152 mm)	50' (15.2 m)	40 mils
StoGuard Tape 9"	9" (229 mm)	50' (15.2 m)	40 mils

## Features Benefits

Features	Benefits
1 Waterproof	Virtually impermeable to the passage of liquid water
2 Flexible	Accommodates minor settlement and shrinkage movement
3 Crack Bridging	Seals minor cracks in concrete and CMU construction
4 Coating Compatible	Most coatings adhere to fabric facing

StoGuard<sup>®</sup> Tape is a self-adhering waterproof air barrier material composed of spun bond polyester fabric laminated to rubberized asphalt adhesive.

The polyester fabric strengthens the material while providing a surface to which most coatings will bond. The rubberized asphalt adhesive sticks to most clean, dry, smooth surfaces, including prepared, primed concrete and concrete masonry, plywood and OSB sheathings, Glass mat faced gypsum sheathings, cement board, asphalt saturated felt and most house wraps.

- StoGuard Tape is designed to be used on above grade vertical wall surfaces as:
- Rough opening protection at windows, doors, and other openings in wood or metal frame construction
- Waterproofing and air barrier for minor cracks in concrete and CMU wall construction
- Secondary seal behind sealant joints
- Air barrier connection material at dissimilar materials
- Backer seal for brick anchors

### Packaging

80269 StoGuard Tape 6":  
6 rolls per box  
80271 StoGuard Tape 9":  
4 rolls per box

### Storage

Store in dry area. Protect from excess heat, cold and direct sunlight.

## StoGuard® Tape

### Surface Preparation

Surfaces must be clean, dry, smooth, structurally sound, and free of frost, grease, dust, dirt, oil, efflorescence, and any other surface contamination. CMU surfaces must have joints struck flush with masonry units.

### Application

Store material inside at room (70°F [21°C]) temperature. If material is cold, warm it with an electric heat gun. Apply only when ambient and surface temperatures are 50°F (10°C) or above. Apply only to dry surfaces:

1. Pre-cut pieces to required length and pre-fit for precision and productivity.
2. Prime surfaces, including tape to tape overlaps. Refer to StoGuard Primer application instructions or 3M Super 77 spray adhesive may be used.
3. Remove release paper on back of tape.
4. Press tape in place by hand.
5. Overlap minimum 3 inches (76 mm) onto adjacent surfaces and at tape to tape overlaps.
6. Apply firm uniform pressure with a pvc or hard rubber roller.
7. Apply a cap bead of StoGuard RapidSeal along ends and edges.
8. Protect with permanent wall covering within 30 days.

Priming is required. Always apply a test area first to be sure of desired results and to verify adhesion under actual condition of use.

Where necessary level or smooth CMU surfaces with appropriate Sto leveling material.

Refer to Sto Details for specific applications.

**IMPORTANT:** Counter flash / shingle lap horizontal edge seams with one of the following methods (refer to Figure below):

- StoGuard Fabric embedded in StoGuard coating
- StoGuard Mesh and Sto Gold Fill top coated with StoGuard coating
- StoGuard RapidSeal tooled along edge seam and immediately above and below
- Metal flashing (in turn shingle lapped with StoGuard Fabric or StoGuard Mesh as noted above)

Seal remaining edges and ends of tape with a cap bead of StoGuard RapidSeal.

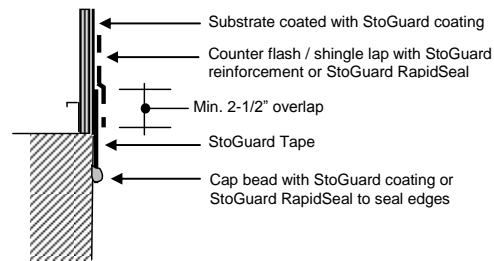

### Health And Safety

#### Health Precautions

Contains asphalt. As with any chemical construction product, exercise care when handling.

#### Safety Precautions

Safety goggles and protective gloves are recommended.

#### First Aid

**SKIN CONTACT:** Wash thoroughly with soap and water.

**EYE CONTACT:** Flush immediately with water for 10-15 minutes and contact a physician.

**RESPIRATORY PROBLEMS:** Remove affected person to fresh air immediately and contact a physician.

**HYGIENE:** Wash hands immediately after use. Wash clothing before re-use.

#### Disposal

Dispose of in accordance with local, state or federal regulations.

#### Warning

**KEEP OUT OF THE REACH OF CHILDREN. NOT FOR INTERNAL CONSUMPTION. FOR INDUSTRIAL USE ONLY.** Consult the Safety Data Sheet for further health and safety information.

Safety Data Sheet (SDS) is available at [www.stocorp.com](http://www.stocorp.com).

#### LIMITED WARRANTY

This product is subject to a written limited warranty which can be obtained free of charge from Sto Corp.

Refer to *Sto Specifications for more complete information on proper use and handling of this product.*

### Limitations

- Not recommended for application during cold (< 50°F [10°C]) weather conditions
- Not intended for prolonged (more than 30 days) UV exposure
- Not intended for use below grade or on surfaces subject to continuous or intermittent water immersion
- Not intended for use as an air or water seal at sheathing joints
- Not intended to bridge moving or working joints in construction
- Not compatible with uncured sealants or materials containing plasticizers
- Horizontal edge seams must be counter flashed (refer to diagram). Other edges must be cap sealed.
- CMU surfaces must have joints struck flush with the surface (smooth)

**Sto Corp.**  
3800 Camp Creek Parkway  
Building 1400, Suite 120  
Atlanta, GA 30331

Tel: 404-346-3666  
Toll Free: 1-800-221-2397  
Fax: 404 346-3119

[www.stocorp.com](http://www.stocorp.com)

**S155-80269**  
Revision Number: A3.2  
Date: 05/2018

#### Attention

This product is intended for use by qualified professional contractors, not consumers, as a component of a larger construction assembly as specified by a qualified design professional, general contractor or builder. It should be installed in accordance with those specifications and Sto's instructions. Sto Corp. disclaims all, and assumes no, liability for on-site inspections, for its products applied improperly, or by unqualified persons or entities, or as part of an improperly designed or constructed building, for the nonperformance of adjacent building components or assemblies, or for other construction activities beyond Sto's control. Improper use of this product or use as part of an improperly designed or constructed larger assembly or building may result in serious damage to this product, and to the structure of the building or its components. **STO CORP. DISCLAIMS ALL WARRANTIES EXPRESSED OR IMPLIED EXCEPT FOR EXPLICIT LIMITED WRITTEN WARRANTIES ISSUED TO AND ACCEPTED BY BUILDING OWNERS IN ACCORDANCE WITH STO'S WARRANTY PROGRAMS WHICH ARE SUBJECT TO CHANGE FROM TIME TO TIME.** For the fullest, most current information on proper application, clean-up, mixing and other specifications and warranties, cautions and disclaimers, please refer to the Sto Corp. website, [www.stocorp.com](http://www.stocorp.com).

# StoGuard® Primer

80273 StoGuard® Primer

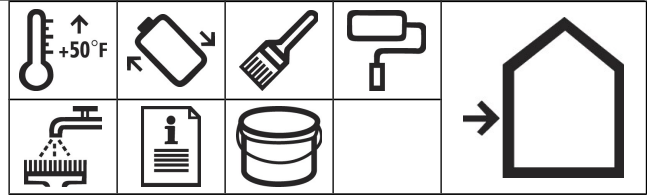

Features	Benefits
1 <b>High degree of tack</b>	Provides excellent grab for ease of installation of StoGuard Tape
2 <b>Moisture resistant</b>	Once covered with StoGuard Tape can be left exposed to weather for 30 days
3 <b>Water-based</b>	Environmentally friendly

*StoGuard® Primer is used to improve the initial bond of StoGuard Tape to substrates and tape to tape overlaps. It is a solvent free rubber-resin emulsion, which upon drying produces a pressure sensitive film. It provides excellent quick grab and adhesion to a variety of surfaces, including plywood, OSB, and glass mat gypsum sheathing, CMU with flush joints, and cast-in-place or pre-cast concrete.*

### Coverage

Approximately 300-400 linear feet [90-120 m] per pail.

Coverage may vary depending on application technique and surface conditions.

### Packaging

1 gal. [3.8 L] pail

### Shelf Life

18 months when properly stored and sealed.

### Storage

Store in a cool, dry area. Protect from extreme heat (90°F/32°C), freezing and direct sunlight.

# StoGuard® Primer

## Surface Preparation

Surfaces must be clean, dry, smooth and free of frost, damage, and all bond-inhibiting materials, including dirt, dust, efflorescence, grease, oil, and other foreign matter.

## Mixing

Shake sealed container well before use.

## Application

Using a brush or roller, apply a 2 to 4 mil layer of StoGuard Primer to the substrate. Rough surfaces such as OSB or CMU may require a more liberal application, depending on condition of the substrate. Allow to dry for ½ to 1 hour or until the film becomes clear. Immediately install StoGuard Tape over StoGuard Primer and press down by hand, then with a dry hard rubber or pvc roller for best adhesion. Primer must be tacky to promote adhesion. If primer is not tacky, re-apply and install StoGuard Tape while primer is tacky.

At laps, apply a 5 to 6 mil layer of StoGuard Primer to the spun bonded polyester fabric surface, allow to dry until the surface is tacky, then install StoGuard Tape as above.

See StoGuard Tape product bulletin for additional information on use, handling and installation of StoGuard Tape.

## Limitations

- Use only when surface and ambient temperatures are 50°F (10°C) or above during application and drying period.
- Do not use when temperature is above 100°F (37.7°C).
- Do not use on CMU surfaces with concave or raked joints (joints must be flush with the CMU surface).
- Do not leave primer covered with tape exposed to weather for more than 30 days. Protect with wall covering or other material.

## Recommended substrates

Plywood, OSB, Glass mat faced gypsum sheathing and CMU with flush joints

## Curing/Drying

Drying time is approximately 30 minutes at 70°F (21°C)/50% RH. Drying time will vary with temperature/humidity and surface conditions.

## Clean Up

Clean tools and equipment with water or soapy water immediately after use.

## Health And Safety

### WARNING!

Causes mild skin irritation, can cause respiratory irritation.

### Precaution

Use in well ventilated area, use respiratory equipment with appropriate filtering. Safety glasses and gloves recommended.

### First Aid

Eye Contact: Get medical attention if irritation occurs.

Skin Contact: Avoid prolonged skin contact. Wash with warm soapy water if skin exposure occurs.

Inhalation: If person is overcome by vapors during hot processing operations, remove person to a fresh air area. Seek medical attention.

Store locked up.

### Spills

Collect with suitable absorbent material such as cotton rags.

### Disposal

Dispose of in accordance with local, state or federal regulations.

### Warning

KEEP CONTAINER CLOSED WHEN NOT IN USE. KEEP OUT OF THE REACH OF CHILDREN. NOT FOR INTERNAL CONSUMPTION. FOR INDUSTRIAL USE ONLY. Consult the Safety Data Sheet (SDS) on [www.stocorp.com](http://www.stocorp.com) for further health and safety information.

### LIMITED WARRANTY

This product is subject to a written limited warranty which can be obtained free of charge from Sto Corp. Refer to Sto Specifications for more complete information on proper use and handling of this product.

**Sto Corp.**  
3800 Camp Creek Parkway  
Building 1400, Suite 120  
Atlanta, GA 30331

Tel: 404-346-3666  
Toll Free: 1-800-221-2397  
Fax: 404 346-3119

[www.stocorp.com](http://www.stocorp.com)

**S155-80273**  
Revision Number: A4.0  
Date: 06/2016

### Attention

This product is intended for use by qualified professional contractors, not consumers, as a component of a larger construction assembly as specified by a qualified design professional, general contractor or builder. It should be installed in accordance with those specifications and Sto's instructions. Sto Corp. disclaims all, and assumes no, liability for on-site inspections, for its products applied improperly, or by unqualified persons or entities, or as part of an improperly designed or constructed building, for the nonperformance of adjacent building components or assemblies, or for other construction activities beyond Sto's control. Improper use of this product or use as part of an improperly designed or constructed larger assembly or building may result in serious damage to this product, and to the structure of the building or its components. **STO CORP. DISCLAIMS ALL WARRANTIES EXPRESSED OR IMPLIED EXCEPT FOR EXPLICIT LIMITED WRITTEN WARRANTIES ISSUED TO AND ACCEPTED BY BUILDING OWNERS IN ACCORDANCE WITH STO'S WARRANTY PROGRAMS WHICH ARE SUBJECT TO CHANGE FROM TIME TO TIME.** For the fullest, most current information on proper application, clean-up, mixing and other specifications and warranties, cautions and disclaimers, please refer to the Sto Corp. website, [www.stocorp.com](http://www.stocorp.com).