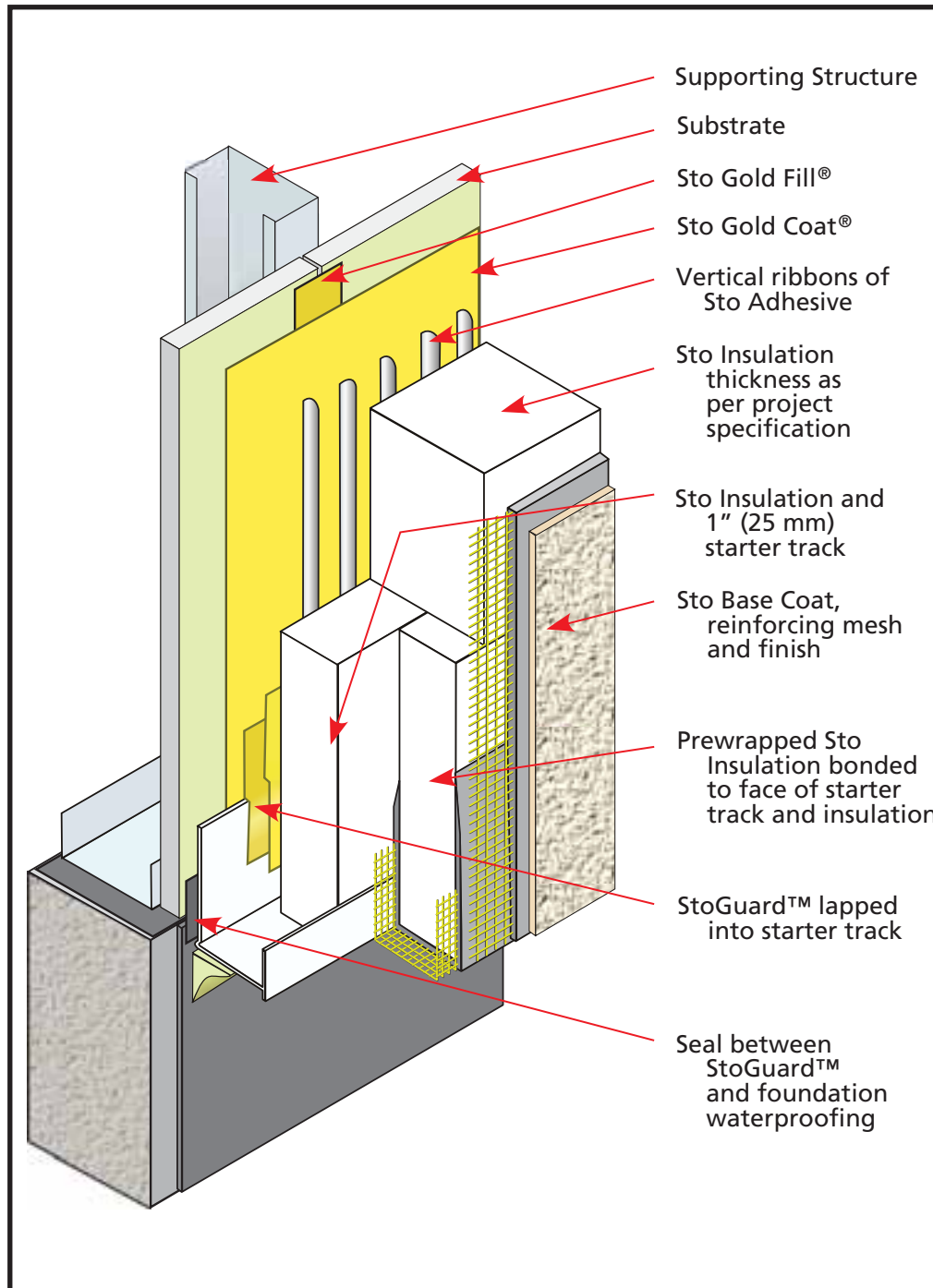

StoTherm™ NExT

Termination at Grade: Concealed Starter Track

Date: September 2007

**Notes:**

1. Minimum thickness of insulation at the termination feature is 2" (50 mm).
2. Install StoGuard and 1" (25 mm) starter track as per Sto Specifications.
3. Install 1" (25 mm) thick by 12" (305 mm) high (approximate) Sto insulation board into the starter track.
4. Prewrap a piece of insulation so that a minimum of 2.5" (65 mm) of base coat and mesh laps on to the back and face of the insulation. The height should match the piece installed in the starter track. The thickness, when applied to the piece in the starter track, should match the thickness of insulation specified for the project. Stagger board joints.
5. Install StoGuard above installed termination feature and lap base coat and mesh over the prewrapped insulation to the bottom edge.

Sto Gold Coat and Sto Gold Fill are registered trademarks of Sto Corp.

ATTENTION

Sto products are intended for use by qualified professional contractors, not consumers, as a component of a larger construction assembly as specified by a qualified design professional, general contractor or builder. They should be installed in accordance with those specifications and Sto's instructions. Sto Corp. disclaims all, and assumes no, liability for on-site inspections, for its products applied improperly, or by unqualified persons or entities, or as part of an improperly designed or constructed building, for the nonperformance of adjacent building components or assemblies, or for other construction activities beyond Sto's control. Improper use of Sto products or use as part of an improperly designed or constructed larger assembly or building may result in serious damage to Sto products, and to the structure of the building or its components. **STO CORP. DISCLAIMS ALL WARRANTIES EXPRESS OR IMPLIED EXCEPT FOR EXPLICIT LIMITED WRITTEN WARRANTIES ISSUED TO AND ACCEPTED BY BUILDING OWNERS IN ACCORDANCE WITH STO'S WARRANTY PROGRAMS WHICH ARE SUBJECT TO CHANGE FROM TIME TO TIME.** For the fullest, most current information on proper application, clean-up, mixing and other specifications and warranties, cautions and disclaimers, please refer to the Sto Corp. website, www.stocorp.com.