

StoTherm™ NExT System Prepared for Penetration

Date: September 2007

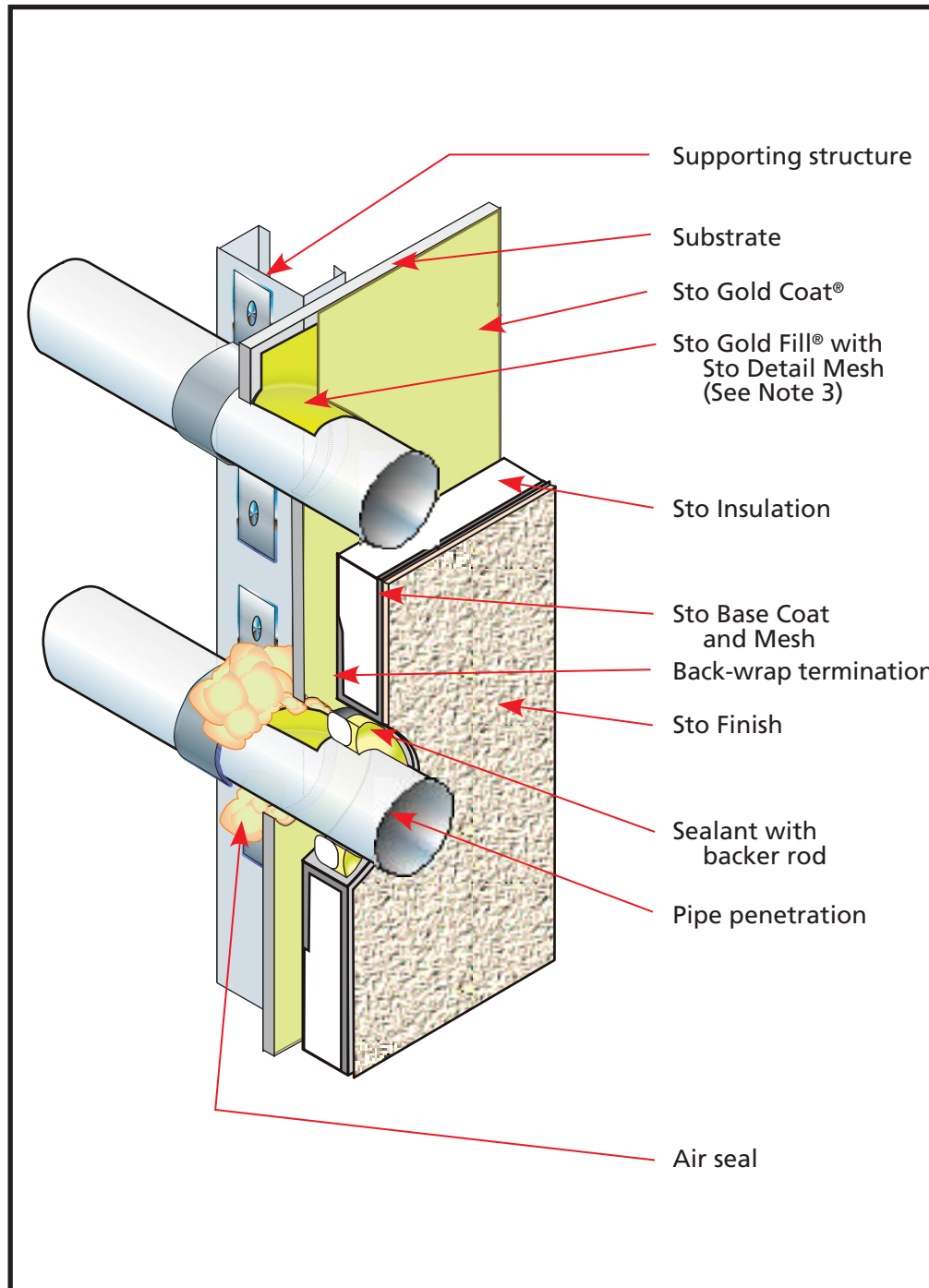

Notes:

1. Detail assumes pipe is installed prior to the StoTherm™ NExT or that its location has been identified.
2. Prepare an opening in the StoTherm™ NExT with a joint of 1/2" (13 mm) around the penetration and provide sealant with a closed cell backer rod. Provide air seal around the interior side of the penetration to reduce the pressure difference across the outside sealant.
3. Provide barrier membrane in lieu of Sto Gold Fill® at penetration where joint between sheathing and penetrating element 1/8" (3 mm). Lap barrier membrane over Sto Gold Coat®

ATTENTION

Sto products are intended for use by qualified professional contractors, not consumers, as a component of a larger construction assembly as specified by a qualified design professional, general contractor or builder. They should be installed in accordance with those specifications and Sto's instructions. Sto Corp. disclaims all, and assumes no, liability for on-site inspections, for its products applied improperly, or by unqualified persons or entities, or as part of an improperly designed or constructed building, for the nonperformance of adjacent building components or assemblies, or for other construction activities beyond Sto's control. Improper use of Sto products or use as part of an improperly designed or constructed larger assembly or building may result in serious damage to Sto products, and to the structure of the building or its components. **STO CORP. DISCLAIMS ALL WARRANTIES EXPRESS OR IMPLIED EXCEPT FOR EXPLICIT LIMITED WRITTEN WARRANTIES ISSUED TO AND ACCEPTED BY BUILDING OWNERS IN ACCORDANCE WITH STO'S WARRANTY PROGRAMS WHICH ARE SUBJECT TO CHANGE FROM TIME TO TIME.** For the fullest, most current information on proper application, clean-up, mixing and other specifications and warranties, cautions and disclaimers, please refer to the Sto Corp. website, www.stocorp.com.

www.stocorp.com