

# StoTherm™ NEXt

## Horizontal Joint at Dissimilar Material

Detail No.: 10.42

Date: November 2007

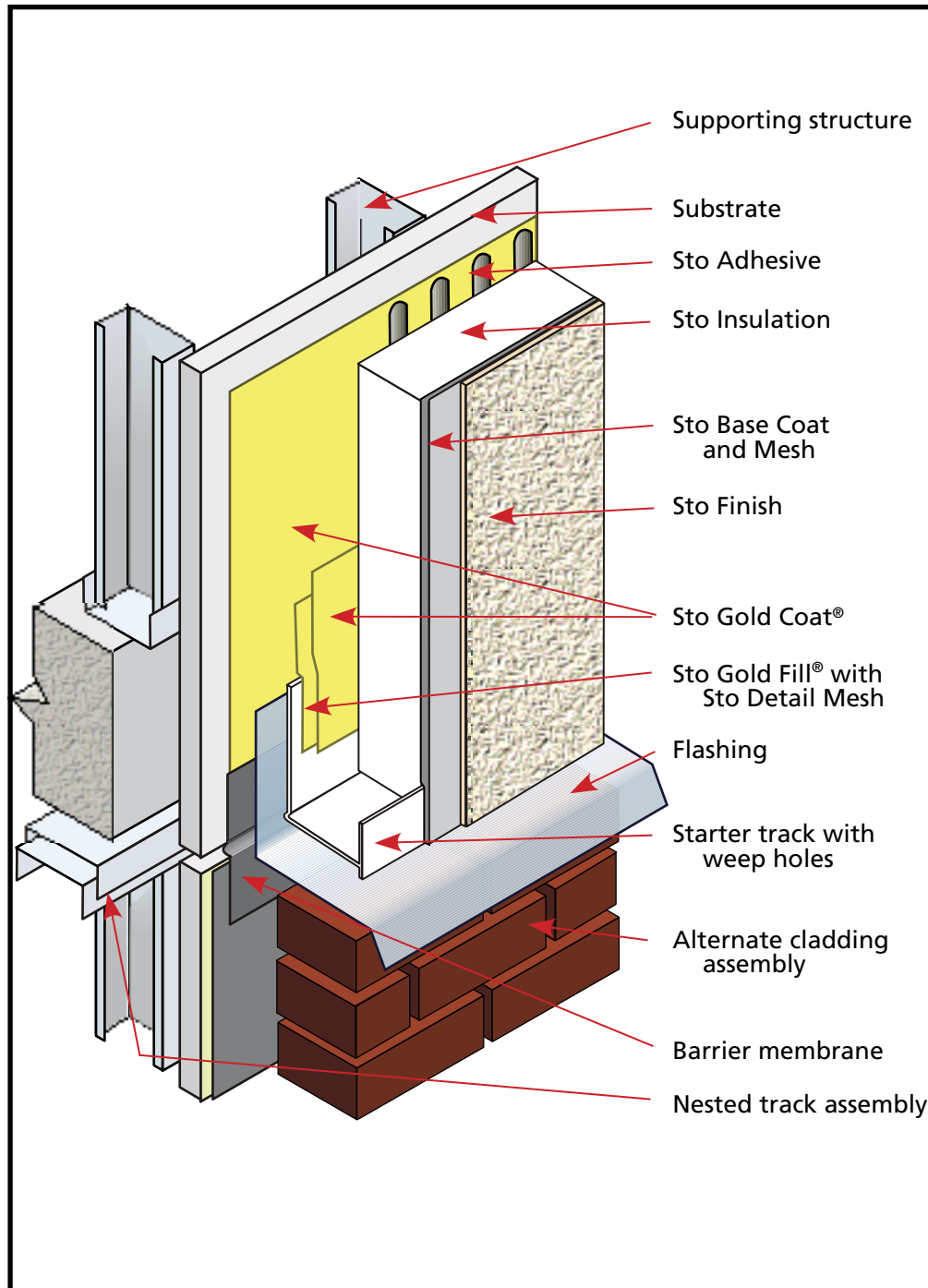

### Notes:

1. Do not attach upper sheathing to nested track. Only attach lower sheathing to nested track.
2. The maximum allowable sheathing span at the floor line is 8" (200 mm) or as recommended by the sheathing manufacturer.
3. Provide flashing minimum 4" (100 mm) behind the StoTherm NEXt and project beyond the face of the alternate cladding below.
4. Consider the amount of movement in the alternate cladding material, especially if a different structural support system exists for that cladding. Position flashing to accommodate movement and ensure drainage to the exterior.
5. Determine installation sequence in advance of construction.

### ATTENTION

Sto products are intended for use by qualified professional contractors, not consumers, as a component of a larger construction assembly as specified by a qualified design professional, general contractor or builder. They should be installed in accordance with those specifications and Sto's instructions. Sto Corp. disclaims all, and assumes no, liability for on-site inspections, for its products applied improperly, or by unqualified persons or entities, or as part of an improperly designed or constructed building, for the nonperformance of adjacent building components or assemblies, or for other construction activities beyond Sto's control. Improper use of Sto products or use as part of an improperly designed or constructed larger assembly or building may result in serious damage to Sto products, and to the structure of the building or its components. **STO CORP. DISCLAIMS ALL WARRANTIES EXPRESSED OR IMPLIED EXCEPT FOR EXPLICIT LIMITED WRITTEN WARRANTIES ISSUED TO AND ACCEPTED BY BUILDING OWNERS IN ACCORDANCE WITH STO'S WARRANTY PROGRAMS WHICH ARE SUBJECT TO CHANGE FROM TIME TO TIME.** For the fullest, most current information on proper application, clean-up, mixing and other specifications and warranties, cautions and disclaimers, please refer to the Sto Corp. website, [www.stocorp.com](http://www.stocorp.com).

[www.stocorp.com](http://www.stocorp.com)