

StoGuard® Waterproof Air Barrier Frame Construction

Sto DrainScreen™

Date: June 2011

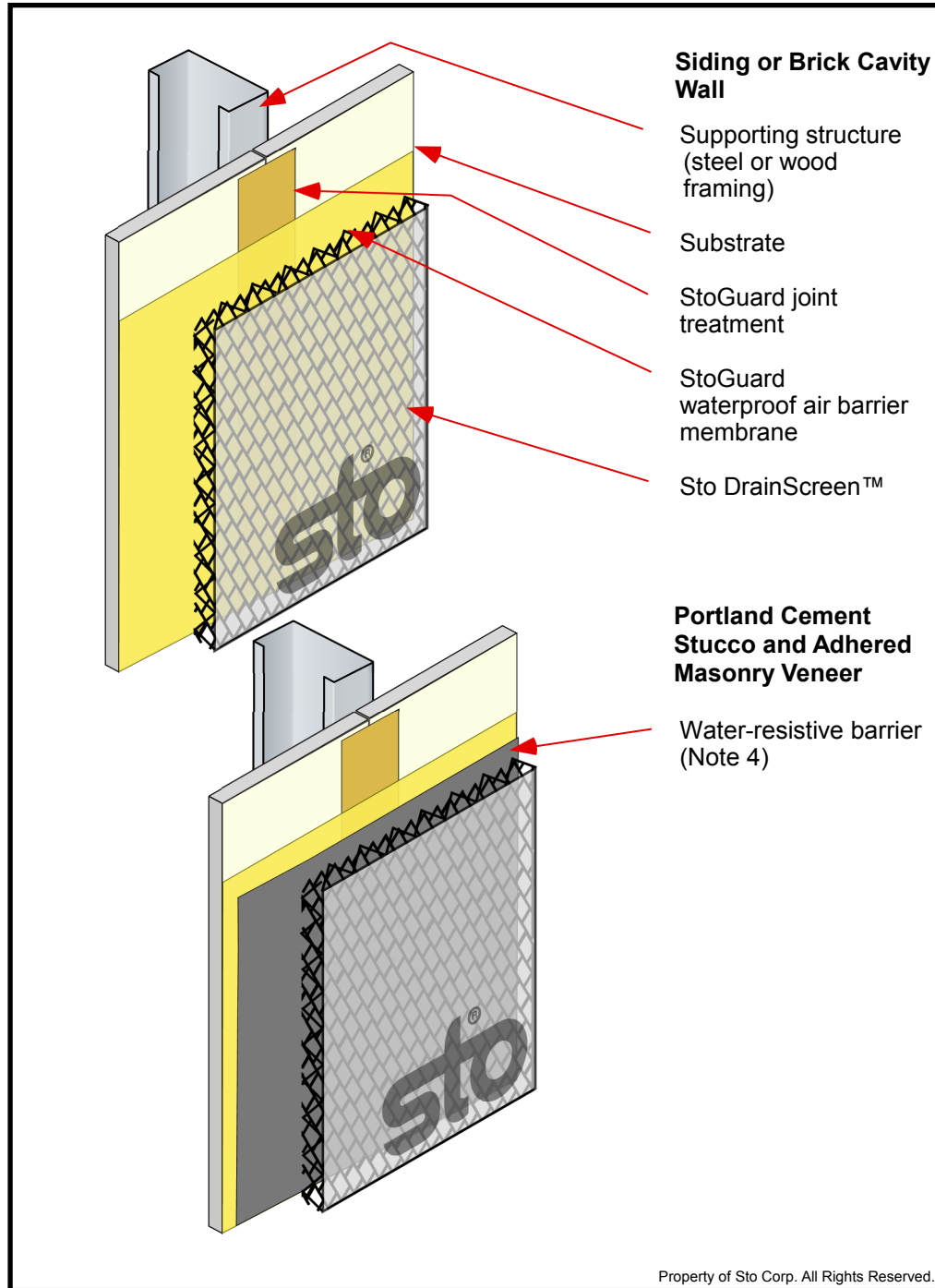

Notes:

- 1] StoGuard joint treatment options:
 - A) StoGuard RapidSeal™ with StoGuard Mesh - joints ≤ 1/4" (6mm)
 - B) Sto Gold Fill® with StoGuard Mesh - joints ≤ 1/8" (3 mm)
 - C) StoGuard Fabric with StoGuard waterproof air barrier membrane - joints ≤ 1/8 inch (3 mm)
- 2] StoGuard waterproof air barrier membrane options:
 - A) Sto Gold Coat® (vapor permeable)
 - B) Sto EmeraldCoat® (high perm)
 - C) StoGuard VaporSeal™ (vapor impermeable)
- 3] Examples of claddings include fiber-cement board, wood and vinyl siding, metal panel systems with sealed joints, and brick or stone cavity walls
- 4] Water-resistive barrier, minimum #15 Grade D building paper, required behind portland cement stucco and adhered masonry veneer. For wood-based substrates use minimum 60-minute, Grade D paper when backed by Sto AirSeal™ or StoGuard VaporSeal™.
- 5] Refer to Sto specifications and product bulletins for detailed information on substrates and Sto material options.

IMPORTANT: Components not identified as Sto are furnished by other manufacturers and are not necessarily installed by trades who install the Sto products. Refer to project specific contract documents.

Property of Sto Corp. All Rights Reserved.

Attention

Sto products are intended for use by qualified professional contractors, not consumers, as a component of a larger construction assembly as specified by a qualified design professional, general contractor or builder. They should be installed in accordance with those specifications and Sto's instructions. Sto Corp. disclaims all, and assumes no, liability for on-site inspections, for its products applied improperly, or by unqualified persons or entities, or as part of an improperly designed or constructed building, for the nonperformance of adjacent building components or assemblies, or for other construction activities beyond Sto's control. Improper use of Sto products or use as part of an improperly designed or constructed larger assembly or building may result in serious damage to Sto products, and to the structure of the building or its components. **STO CORP. DISCLAIMS ALL WARRANTIES EXPRESS OR IMPLIED EXCEPT FOR EXPLICIT LIMITED WRITTEN WARRANTIES ISSUED TO AND ACCEPTED BY BUILDING OWNERS IN ACCORDANCE WITH STO'S WARRANTY PROGRAMS WHICH ARE SUBJECT TO CHANGE FROM TIME TO TIME.** For the fullest, most current information on proper application, clean-up, mixing and other specifications and warranties, cautions and disclaimers, please refer to the Sto Corp. website, www.stocorp.com.

www.stocorp.com