

# Installing StoGuard™ with EIFS is easy!

**StoGuard™ spray-on building wrap is not only easy to install properly but is also affordable.**

***Install StoGuard™ in 3 quick, easy steps!***

## Step 1



1. Apply 4.5" (114 mm) StoGuard Mesh to all vertical & horizontal sheathing joints.

## Step 2



2. Spray or trowel Sto Gold Fill® over StoGuard Mesh and spot fasteners. Allow to dry.

## Step 3



3. Spray or roll Sto Gold Coat® onto the entire wall surface. Sto Gold Coat® is specially formulated for use under StoTherm® Insulated Wall Claddings (EIFS).

StoGuard provides superior protection underneath brick, wood, vinyl, cement siding, as well as EIFS.

*Note: 1. StoGuard Fabric can be used with Sto Gold Coat.*

*2. StoGuard VaporSeal, vapor barrier, may be used in place of Sto Gold Coat.*

## Window Openings and Similar Rough Opening Protection

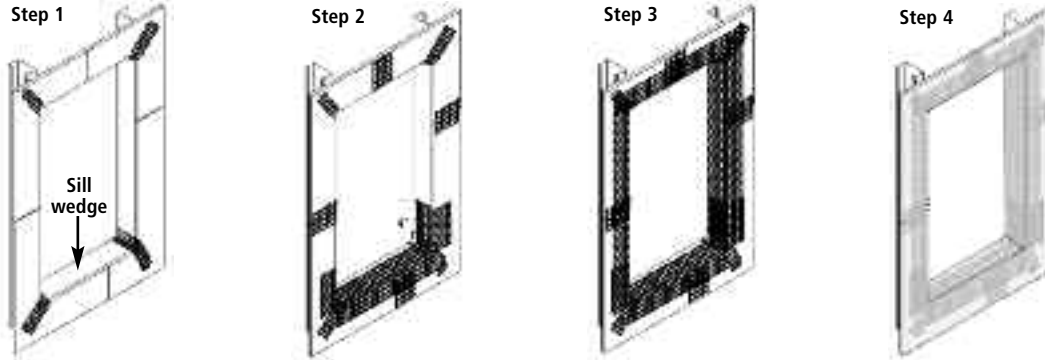

1. Place 2" (51 mm) wide StoGuard Mesh at corners. Note pvc or wood sill wedge installed prior to mesh for positive slope at sill.
2. Place 9" (229 mm) wide StoGuard Mesh along sill and return up jambs minimum 4" (100 mm).
3. Wrap jambs and head with minimum 9" (229 mm) wide StoGuard Mesh. Overlap mesh seams of sill mesh minimum 2-1/2" (64 mm).
4. Immediately spray or trowel Sto Gold Fill® over mesh and trowel smooth. Allow to dry. When dry, coat the entire rough opening with Sto Gold Coat®.

**Note:** StoGuard RediCorners and StoGuard Fabric are alternatives to StoGuard Mesh and Sto Gold Fill® for rough openings.

## Window Head and Similar Flashing

*This step is typically done last*

1. Place 4.5" (114 mm) wide StoGuard Mesh over the window head.
2. Spray or trowel Sto Gold Fill® over StoGuard Mesh. Allow to dry.
3. Roll Sto Gold Coat® over Sto Gold Fill®.



## For Sto EIFS Application

### Starter Track

1. Apply 4.5" (114 mm) wide StoGuard Mesh at the starter track.
2. Spray or trowel Sto Gold Fill® over the StoGuard Mesh. Allow to dry.
3. Roll Sto Gold Coat® over Sto Gold Fill®.

**Protect installed materials from rain, freezing temperatures and continuous high humidity until completely dry. If temporary heaters are used, vent to prevent high humidity.**



\*DensGlass Gold is a registered trademark of Georgia Pacific Gypsum LLC.

### Sto Corp.

3800 Camp Creek Parkway  
 Building 1400, Suite 120  
 Atlanta, GA 30331  
 Tel: 404-346-3666  
 Toll Free: 1-800-221-2397  
 Fax: 404-346-3119  
[www.stocorp.com](http://www.stocorp.com)



For technical assistance, please call Sto Tech Services at 800-221-2397. For more information including detail drawings on StoGuard or other Sto products or systems, please visit [www.stocorp.com](http://www.stocorp.com).

S425E 04/09 VEN 5609

#### ATTENTION

This product is intended for use by qualified professional contractors, not consumers, as a component of a larger construction assembly as specified by a qualified design professional, general contractor or builder. It should be installed in accordance with those specifications and Sto's instructions. Sto Corp. disclaims all, and assumes no, liability for on-site inspections, for its products applied improperly, or by unqualified persons or entities, or as part of an improperly designed or constructed building, for the nonperformance of adjacent building components or assemblies, or for other construction activities beyond Sto's control. Improper use of this product or use as part of an improperly designed or constructed larger assembly or building may result in serious damage to this product, and to the structure of the building or its components. **STO CORP. DISCLAIMS ALL WARRANTIES EXPRESSED OR IMPLIED EXCEPT FOR EXPLICIT LIMITED WRITTEN WARRANTIES ISSUED TO AND ACCEPTED BY BUILDING OWNERS IN ACCORDANCE WITH STO'S WARRANTY PROGRAMS WHICH ARE SUBJECT TO CHANGE FROM TIME TO TIME.** For the fullest, most current information on proper application, clean-up, mixing and other specifications and warranties, cautions and disclaimers, please refer to the Sto Corp. website, [www.stocorp.com](http://www.stocorp.com).